

F.A.P. RTE.	SECTION	COUNTY	TOTAL SHEETS	SHEET NO.
326	*	LIVINGSTON	354	193
STA.		TO STA.		
FED. ROAD DIST. NO.		ILLINOIS FED. AID PROJECT		
*1123,125X1RS-3;1124RS-5;11231BR-3				

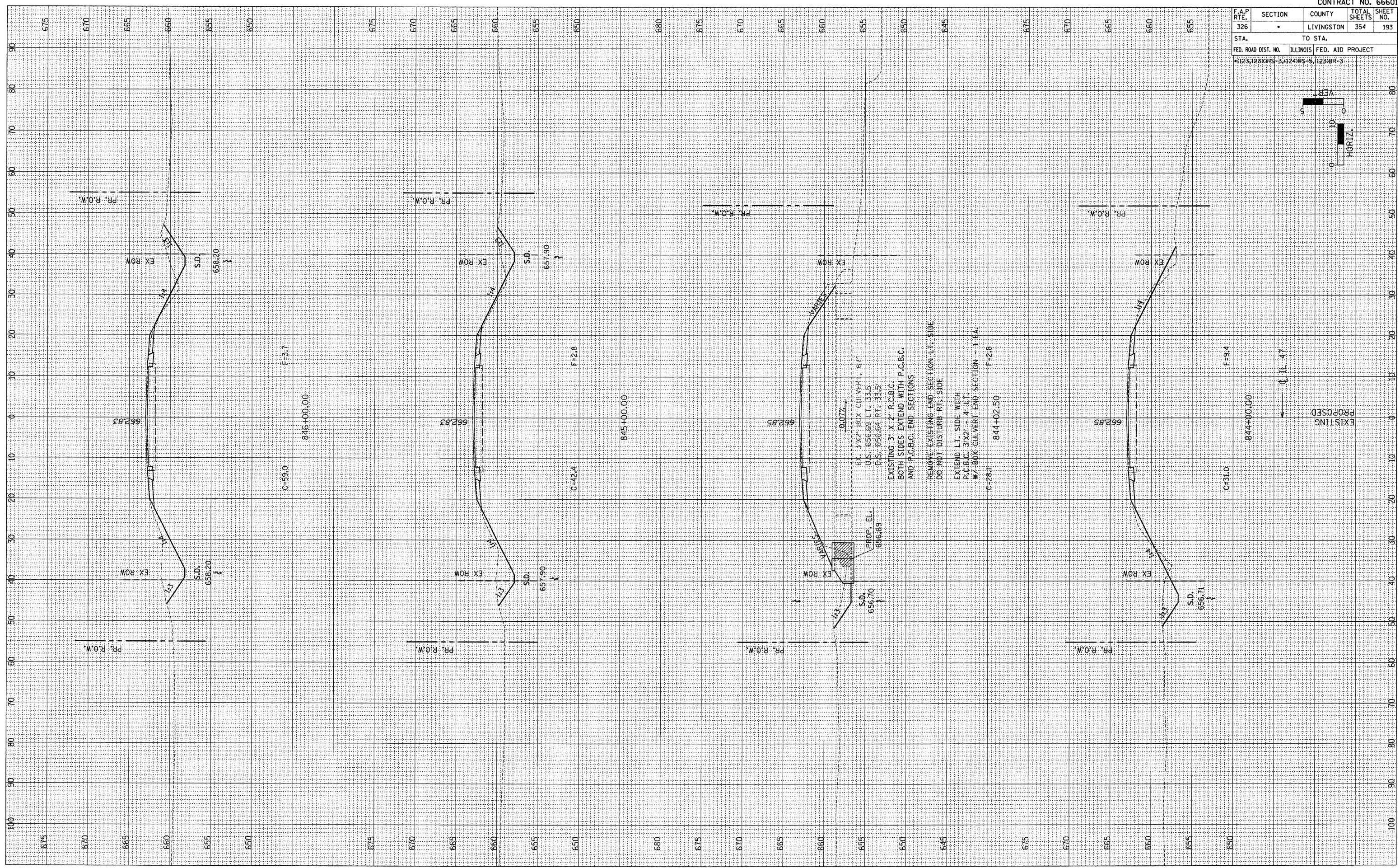
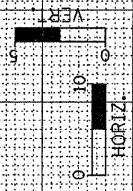

EXISTING
PROPOSED

FINAL SURVEY	BY	DATE
REVISIONS		
PLOTTED		
TEMPLATE		
NOTE BOOK		
AREAS		
CHECKED		

ORIGINAL SURVEY	BY	DATE
REVISIONS		
PLOTTED		
TEMPLATE		
NOTE BOOK		
AREAS		
CHECKED		