

F.A.P. RTE. 326	SECTION •	COUNTY LIVINGSTON	TOTAL SHEETS 354	SHEET NO. 196
STA.		TO STA.		
FED. ROAD DIST. NO.		ILLINOIS FED. AID PROJECT		
1123,123XIRS-5,1124RS-5,1123BR-3				

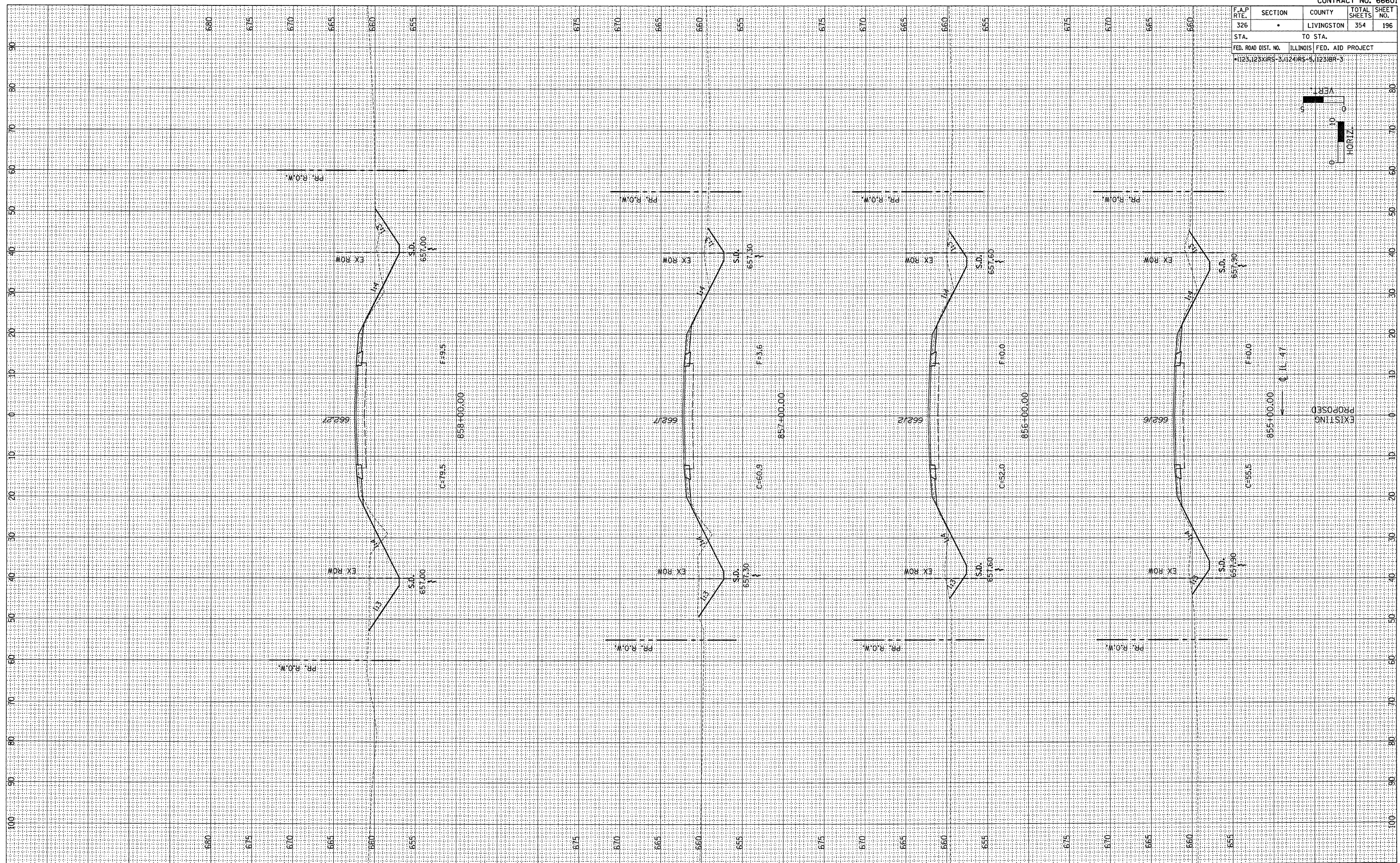
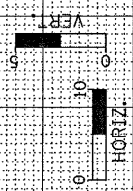

EXISTING  
PROPOSED

FINAL SURVEY	BY	DATE
CHECKED		
PLOTTED		
TEMPLATE		
NOTE BOOK		
AREAS		
CHECKED		

ORIGINAL SURVEY	BY	DATE
CHECKED		
PLOTTED		
TEMPLATE		
NOTE BOOK		
AREAS		
CHECKED		