

F.A.P. RTE. 326	SECTION -	COUNTY LIVINGSTON	TOTAL SHEETS 354	SHEET NO. 209
STA.		TO STA.		
FED. ROAD DIST. NO.		ILLINOIS FED. AID PROJECT		
1123,123XIRS-3,124RS-5		1123BR-3		

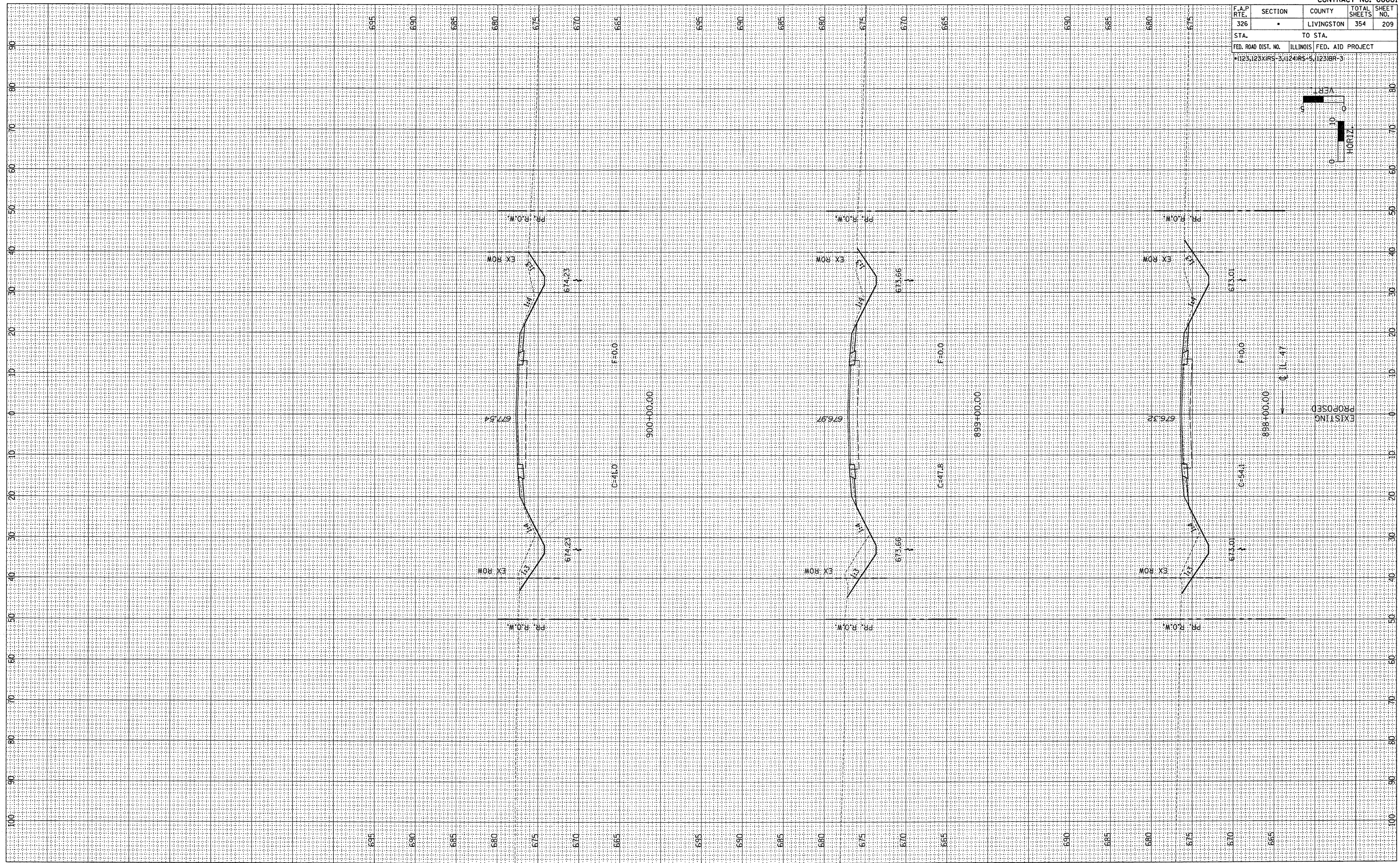
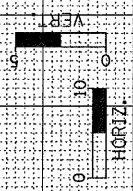

FINAL SURVEY	DATE
REVIEWED	BY
PLOTTED	
TEMPLATE	
AREAS	
CHECKED	
NO.	

ORIGINAL SURVEY	DATE
REVIEWED	BY
PLOTTED	
TEMPLATE	
AREAS	
CHECKED	
NO.	