

F.A.P. RTE. 326	SECTION •	COUNTY LIVINGSTON	TOTAL SHEETS 354	SHEET NO. 221
STA. TO STA.		FED. AID PROJECT		
FED. ROAD DIST. NO.		ILLINOIS		
•1123,123XIRS-3,124IRS-5,123IBR-3				

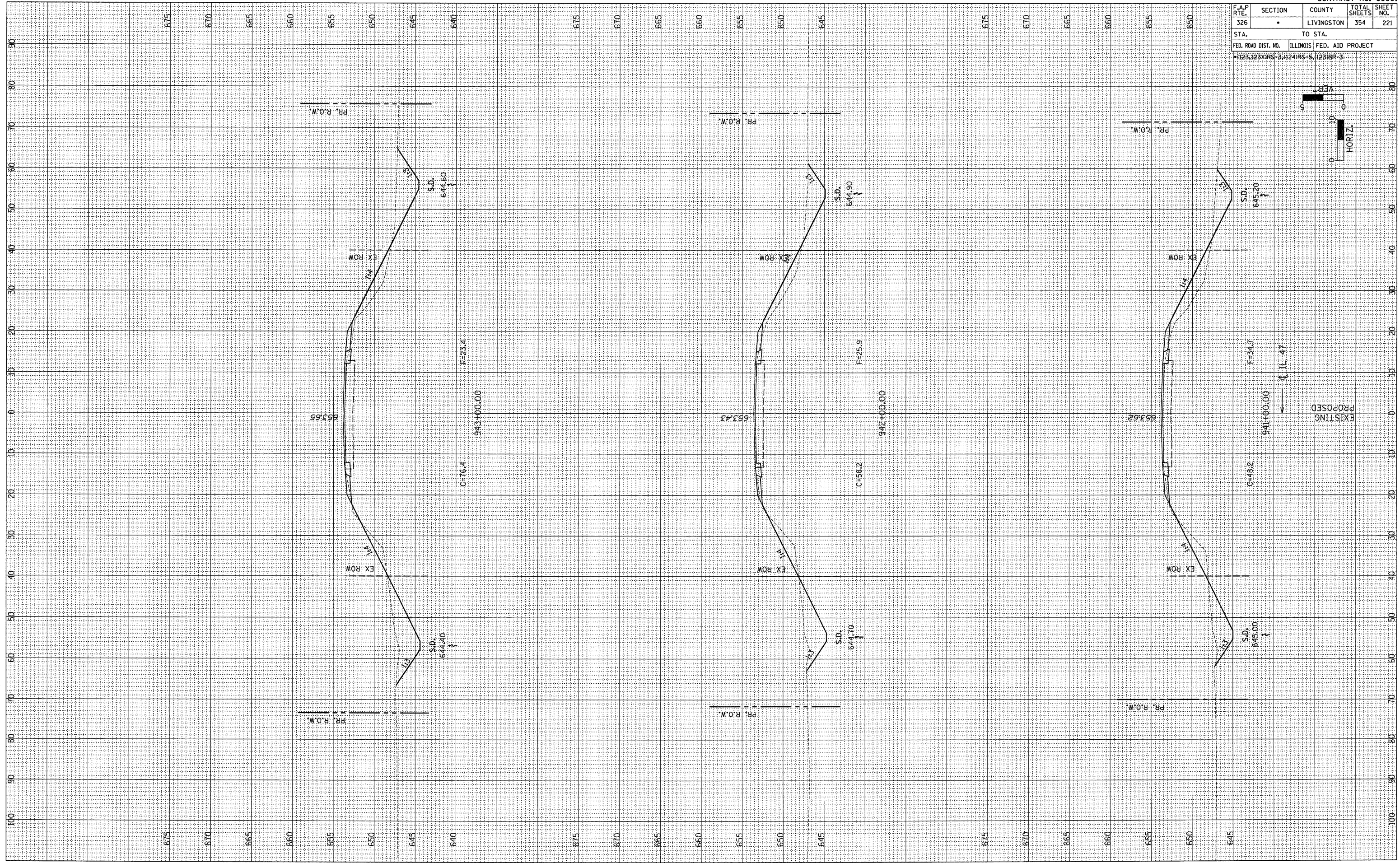
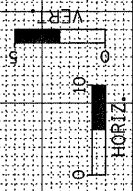

EXISTING PROPOSED

FINAL SURVEY	DATE
REVISIONS	BY
PLOTTED	
TEMPLATE	
AREAS	
CHECKED	
NO.	

ORIGINAL SURVEY	DATE
REVISIONS	BY
PLOTTED	
TEMPLATE	
AREAS	
CHECKED	
NO.	