

F.A.P. RTE. 326	SECTION -	COUNTY LIVINGSTON	TOTAL SHEETS 354	SHEET NO. 223
STA. TO STA.		FED. ROAD DIST. NO. ILLINOIS FED. AID PROJECT		
		*1123123XRS-3;1241RS-5;1231BR-3		

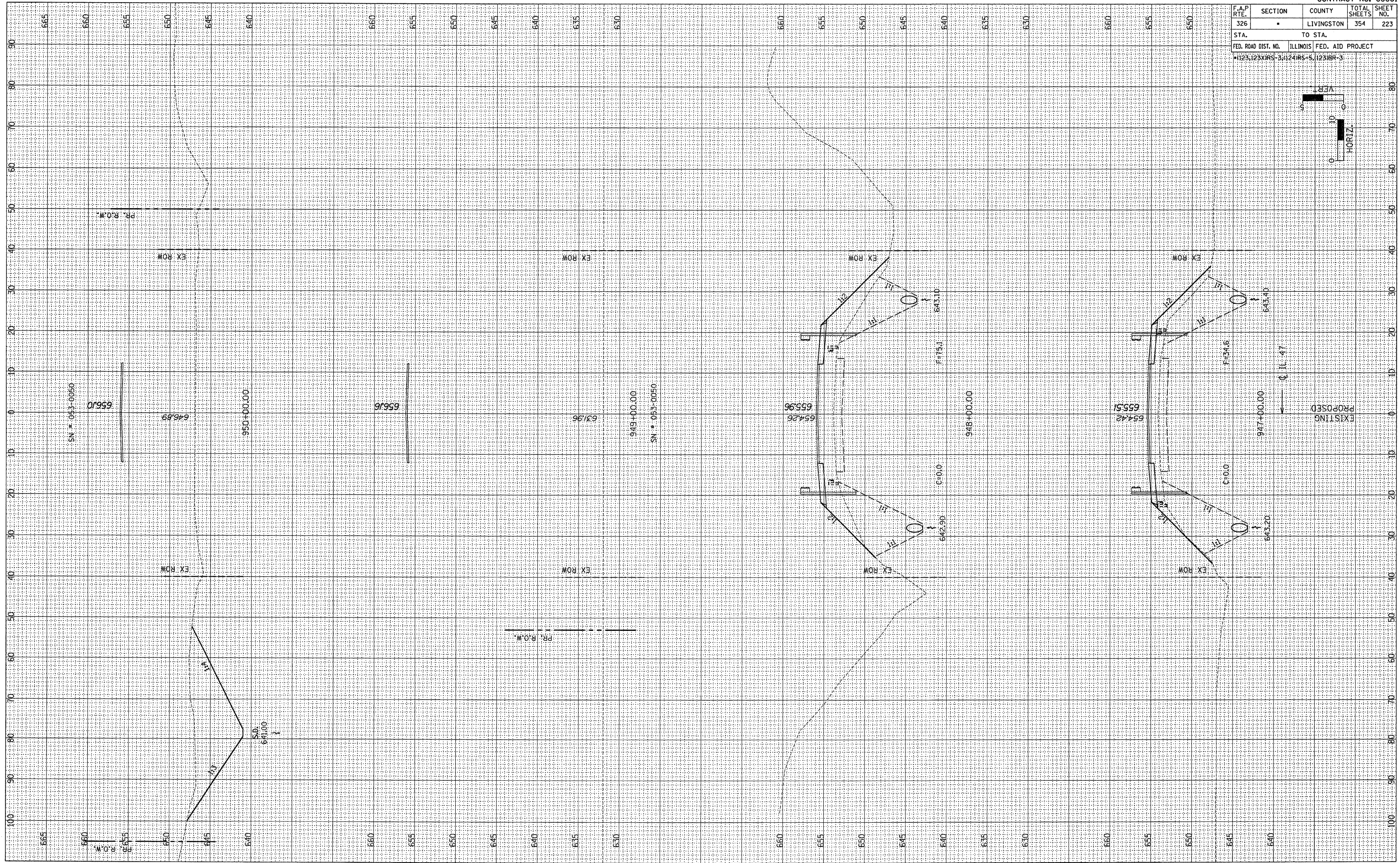
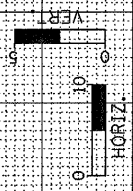

ORIGINAL SURVEY	BY	DATE
REVISIONS		
PLOTTED		
TEMPLATE		
AREAS		
NO.		