

F.A.P. RTE. 326	SECTION •	COUNTY LIVINGSTON	TOTAL SHEETS 354	SHEET NO. 231
STA.		TO STA.		
FED. ROAD DIST. NO.		ILLINOIS FED. AID PROJECT		
•1123123X1RS-3,11241RS-5,11231BR-3				

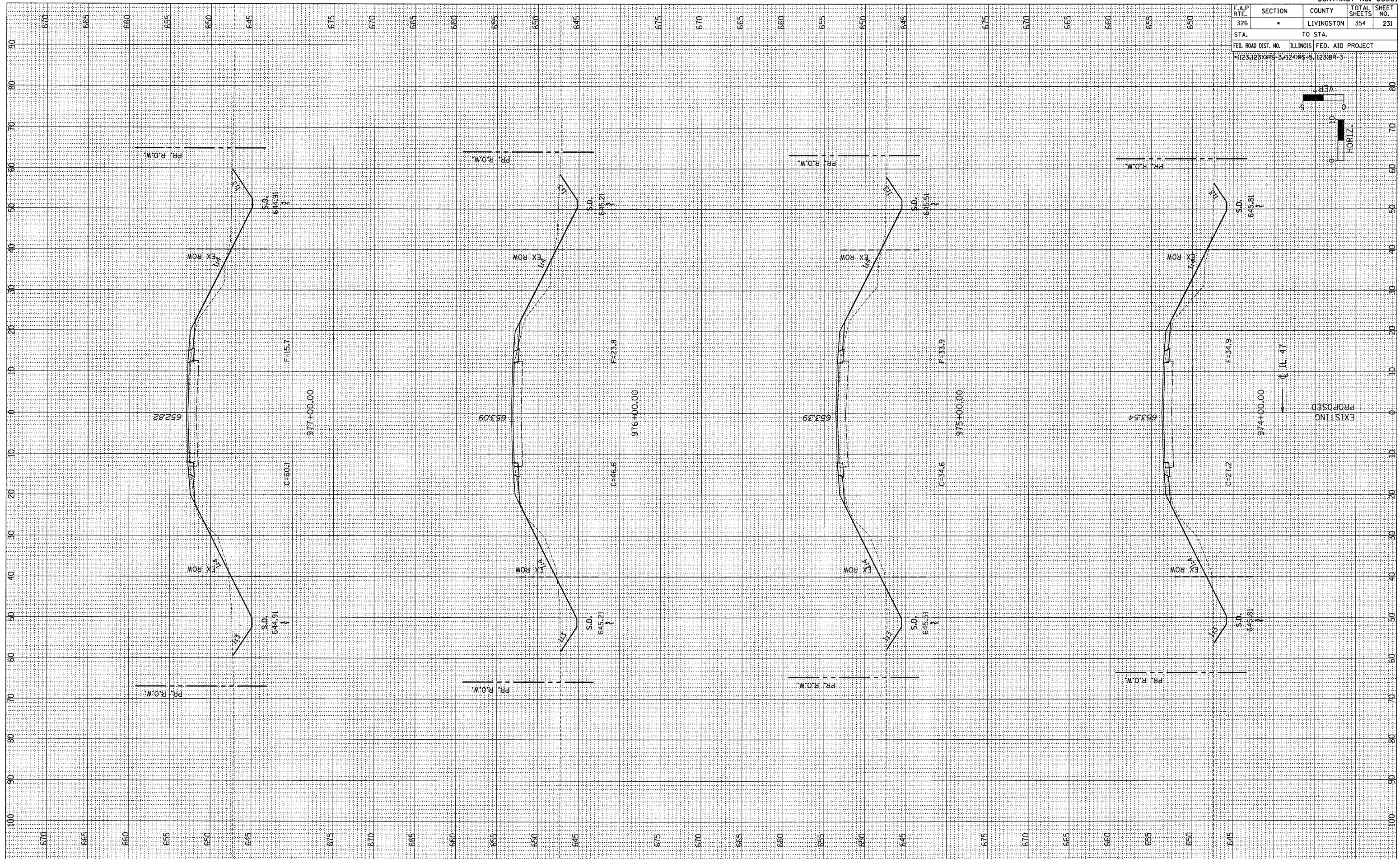
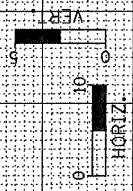

EXISTING
PROPOSED

FINAL SURVEY	BY	DATE
REVISIONS		
PLOTTED		
NOTE BOOK		
AREAS CHECKED		

ORIGINAL SURVEY	BY	DATE
REVISIONS		
PLOTTED		
NOTE BOOK		
AREAS CHECKED		