

F.A.P. RTE. 326	SECTION •	COUNTY LIVINGSTON	TOTAL SHEETS 354	SHEET NO. 234
STA.		TO STA.		
FED. ROAD DIST. NO.		ILLINOIS FED. AID PROJECT		
•11231125X1RS-3;11241RS-5;11231BR-3				

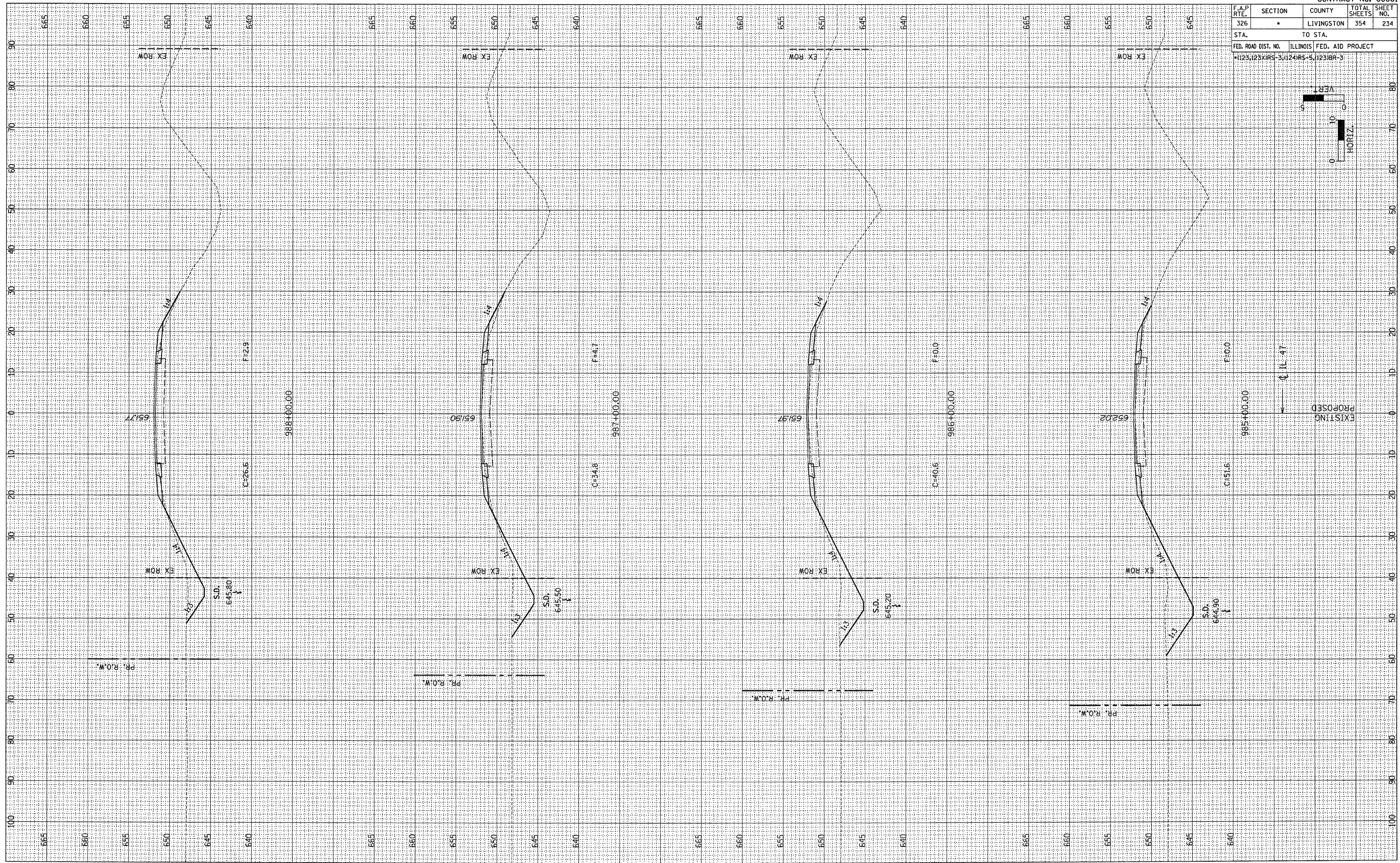
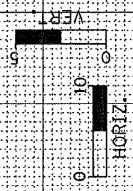

EXISTING
PROPOSED

11.47

FINAL SURVEY	DATE
CHECKED	BY
PLOTTED	
TEMPLATE	
AREAS	
CHECKED	
NO.	

ORIGINAL SURVEY	DATE
REVIEWED	BY
PLOTTED	
TEMPLATE	
AREAS	
CHECKED	
NO.	