

F.A.P. RTE. 326	SECTION •	COUNTY LIVINGSTON	TOTAL SHEETS 354	SHEET NO. 243
STA. 1123+123XIR5-3(124)RS-5,123IBR-3		TO STA.		
FED. ROAD DIST. NO. ILLINOIS FED. AID PROJECT				

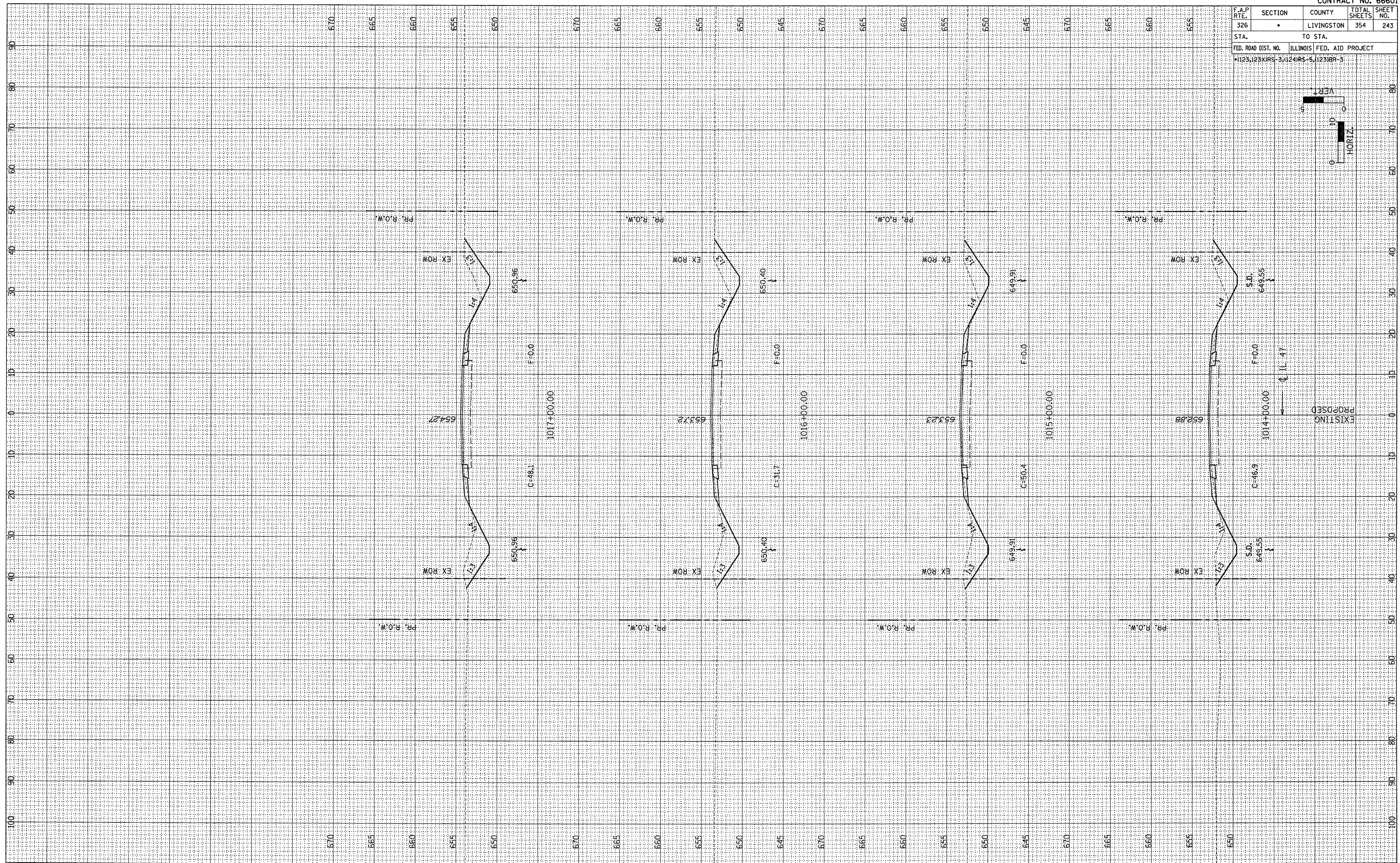

FINAL SURVEY	BY	DATE
REVIEWED		
PLOTTED		
TEMPLATE		
NOTE BOOK		
AREAS		
CHECKED		

ORIGINAL SURVEY	BY	DATE
REVIEWED		
PLOTTED		
TEMPLATE		
NOTE BOOK		
AREAS		
CHECKED		