

F.A.P. RTE. 326	SECTION •	COUNTY LIVINGSTON	TOTAL SHEETS 354	SHEET NO. 251
STA.		TO STA.		
FED. ROAD DIST. NO.	ILLINOIS	FED. AID PROJECT		
•1123,125XIRS-3,124IRS-5,123IBR-3				

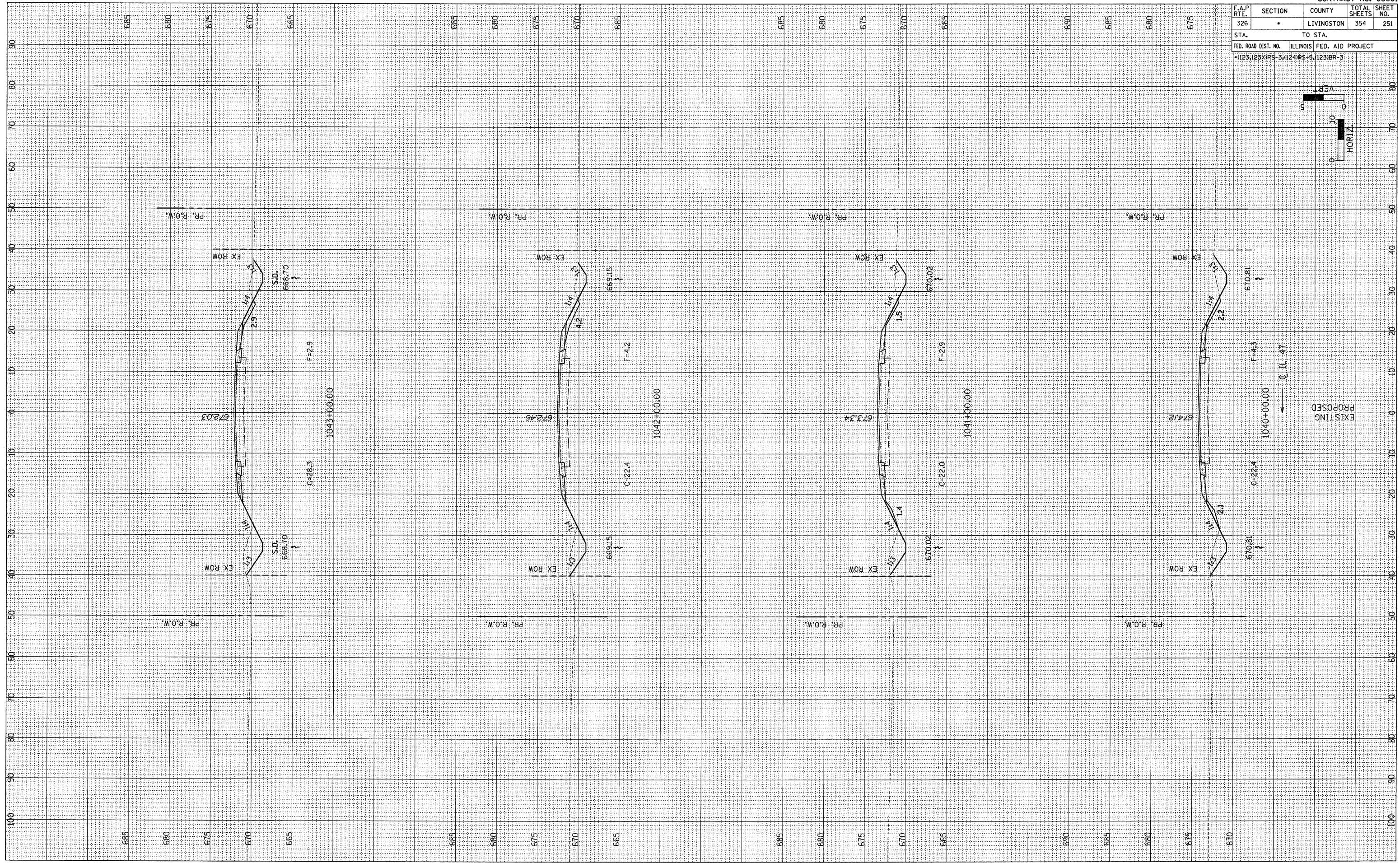
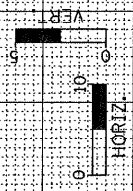

FINAL SURVEY	DATE
REVIEWED	BY
PLOTTED	
NOTE BOOK	
AREAS CHECKED	
NO.	

ORIGINAL SURVEY	DATE
REVIEWED	BY
PLOTTED	
NOTE BOOK	
AREAS CHECKED	
NO.	