

F.A.P. RTE. 326	SECTION •	COUNTY LIVINGSTON	TOTAL SHEETS 354	SHEET NO. 254
STA.		TO STA.		
FED. ROAD DIST. NO.		ILLINOIS FED. AID PROJECT		
1123,123X1R5-3,1124R5-5,11231R-3				

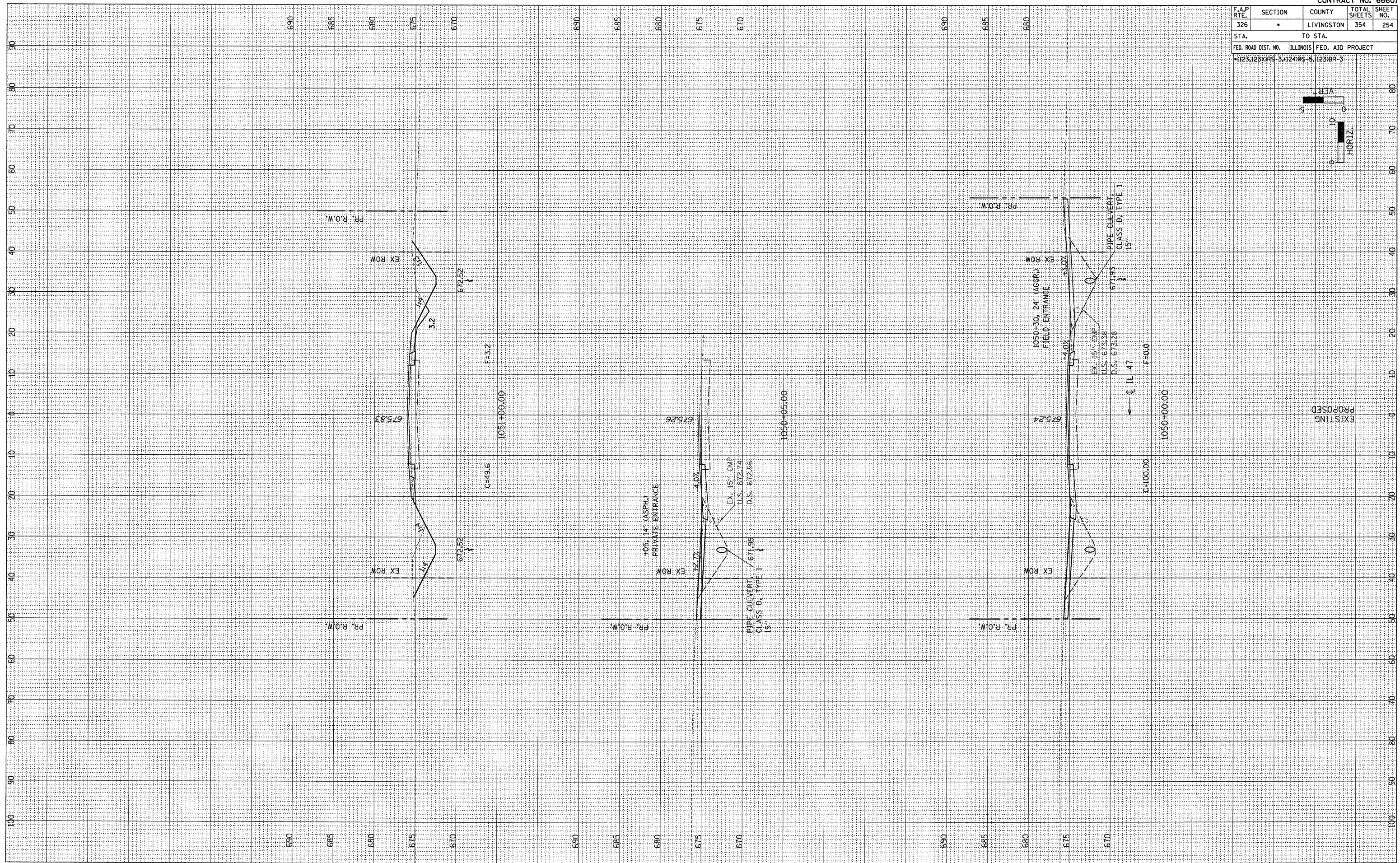
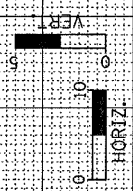

EXISTING PROPOSED

ORIGINAL SURVEY	BY	DATE
CHECKED		
PLOTTED		
TEMPLATE		
NOTE BOOK		
AREAS		
CHECKED		

ORIGINAL SURVEY	BY	DATE
CHECKED		
PLOTTED		
TEMPLATE		
NOTE BOOK		
AREAS		
CHECKED		