

F.A.P. RTE. 326	SECTION •	COUNTY LIVINGSTON	TOTAL SHEETS 354	SHEET NO. 257
STA.		TO STA.		
FED. ROAD DIST. NO.		ILLINOIS		FED. AID PROJECT
•1123,125XIRS-3,4124RS-5,		1231BR-3		

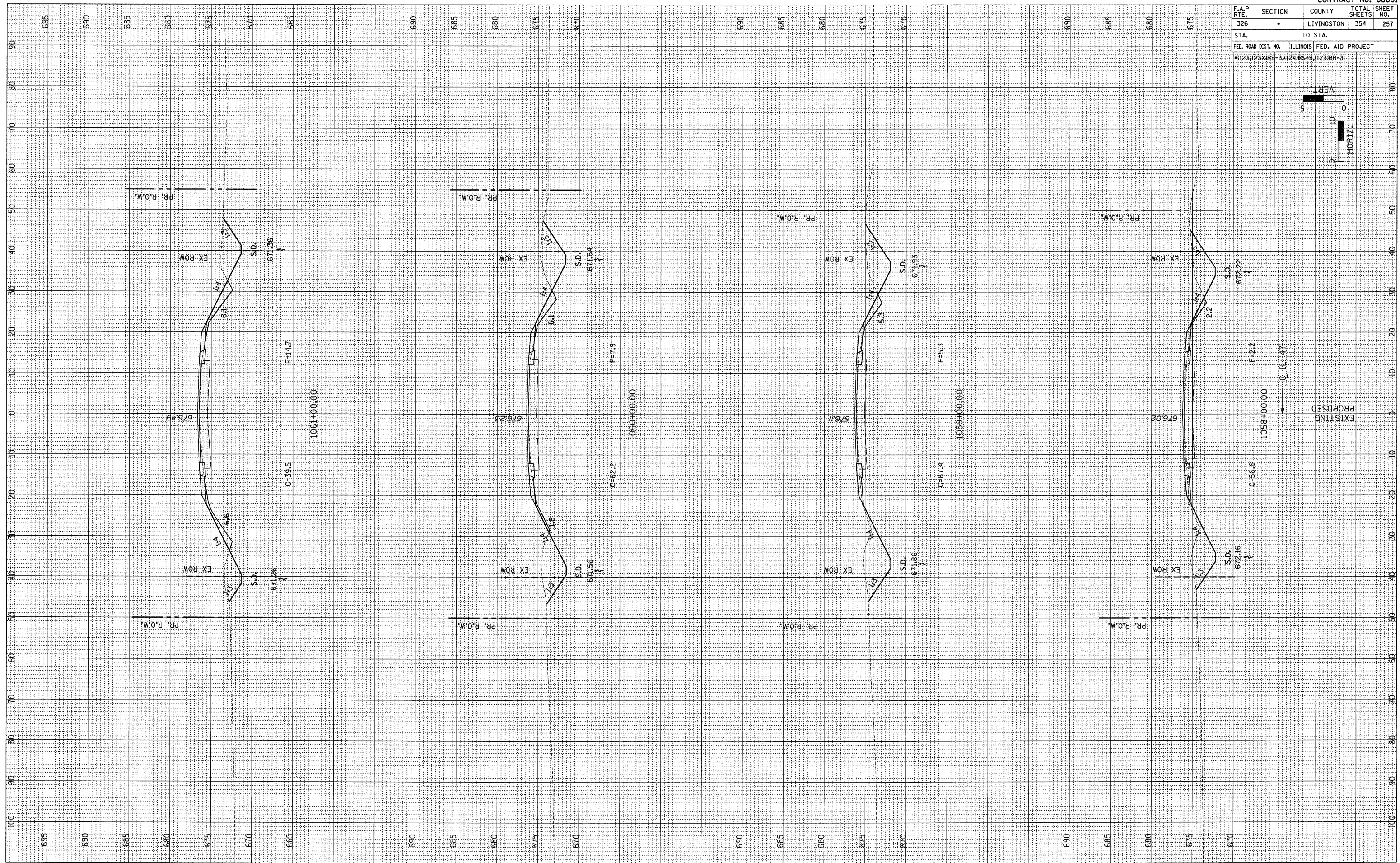
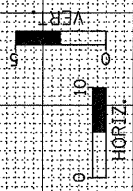

PROPOSED

EXISTING

FINAL SURVEY	DATE
REVISIONS	BY
PLOTTED	
TEMPLATE	
AREAS	
CHECKED	
NO.	

ORIGINAL SURVEY	DATE
REVISIONS	BY
PLOTTED	
TEMPLATE	
AREAS	
CHECKED	
NO.	