

F.A.P. RTE.	SECTION	COUNTY	TOTAL SHEETS	SHEET NO.
326	*	LIVINGSTON	354	259
STA. TO STA.		ILLINOIS FED. AID PROJECT		
*123,123XIRS-3;124IRS-5;123IBR-3				

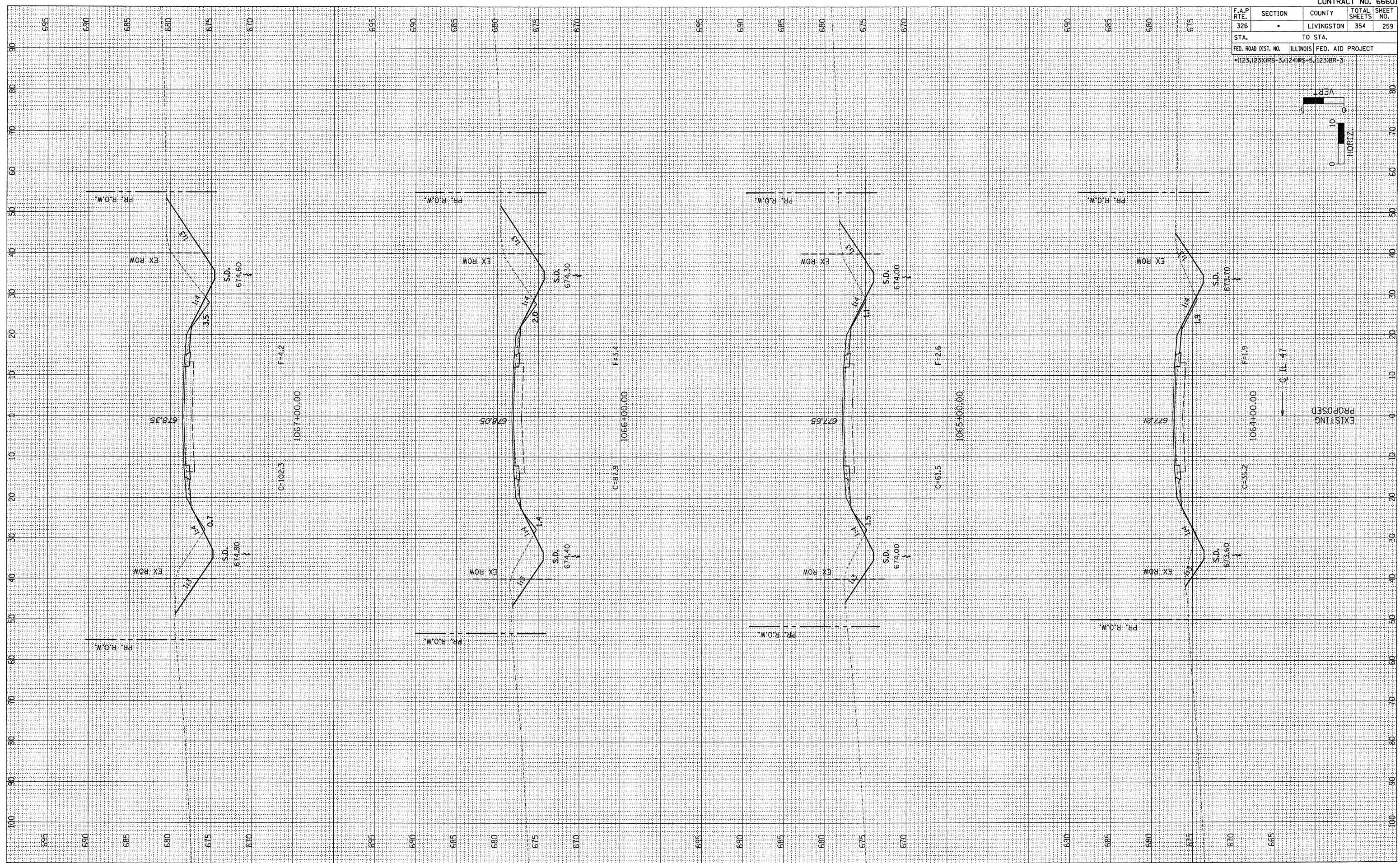
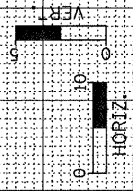

FINAL SURVEY	DATE	BY
CONVERTED PLOTTED		
NOTE BOOK		
AREAS CHECKED		
NO.		

ORIGINAL SURVEY	DATE	BY
CONVERTED PLOTTED		
NOTE BOOK		
AREAS CHECKED		
NO.		