

F.A.P. RTE.	SECTION	COUNTY	TOTAL SHEETS	SHEET NO.
326	•	LIVINGSTON	354	261
STA. TO STA.		FED. ROAD DIST. NO. ILLINOIS FED. AID PROJECT		
		•1123,123XIRS-3,1124IRS-5,1123IBR-3		

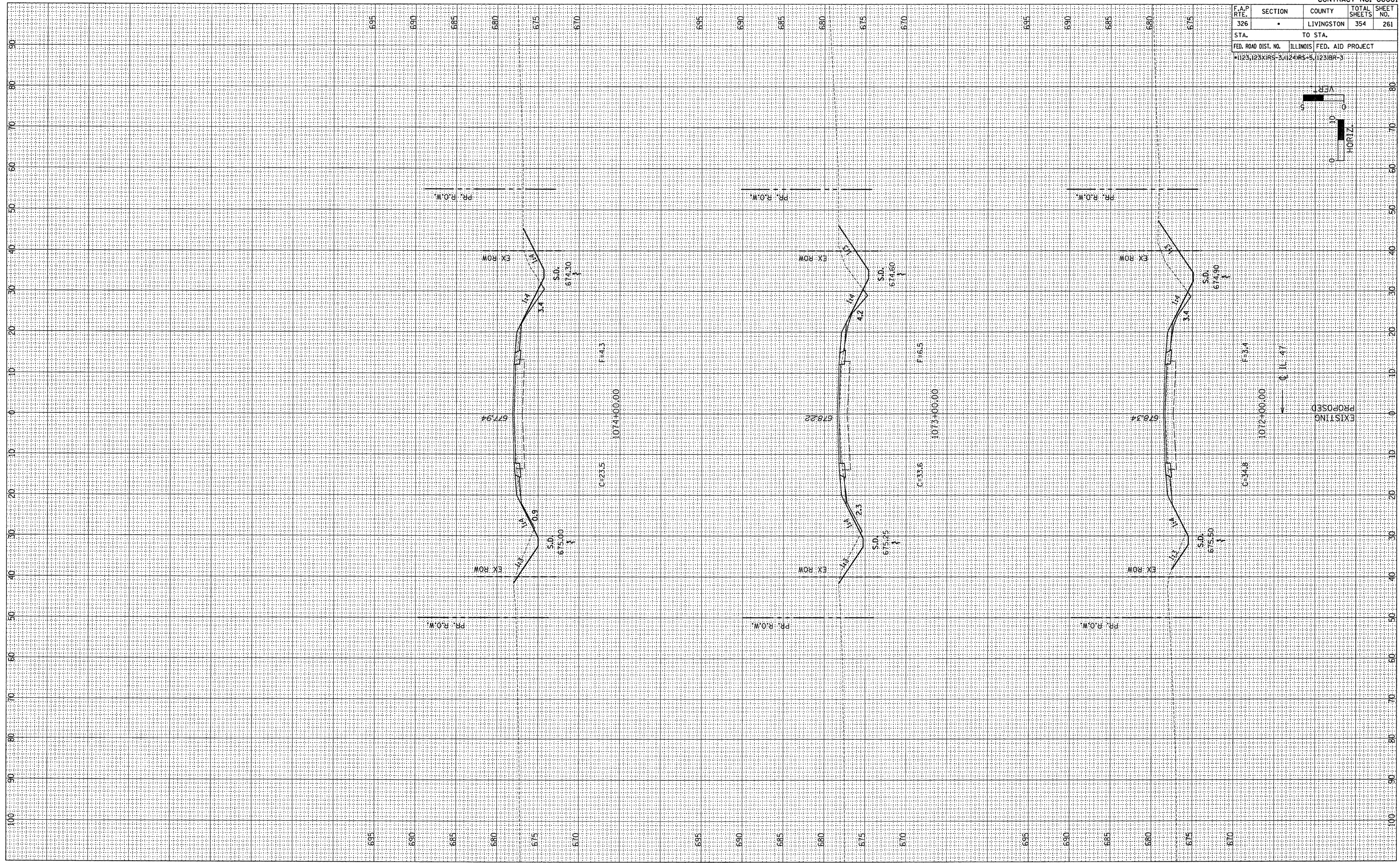
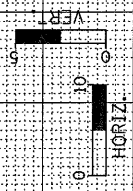

EXISTING
PROPOSED

FINAL SURVEY	DATE
REVIEWED	BY
PLOTTED	
TEMPLATE	
AREAS	
CHECKED	
NO.	

ORIGINAL SURVEY	DATE
REVIEWED	BY
PLOTTED	
TEMPLATE	
AREAS	
CHECKED	
NO.	