

F.A.P. RTE. 326	SECTION •	COUNTY LIVINGSTON	TOTAL SHEETS 354	SHEET NO. 277
STA.		TO STA.		
FED. ROAD DIST. NO.		ILLINOIS		FED. AID PROJECT
•1123,123XIRS-3,124IRS-5,123IBR-3				

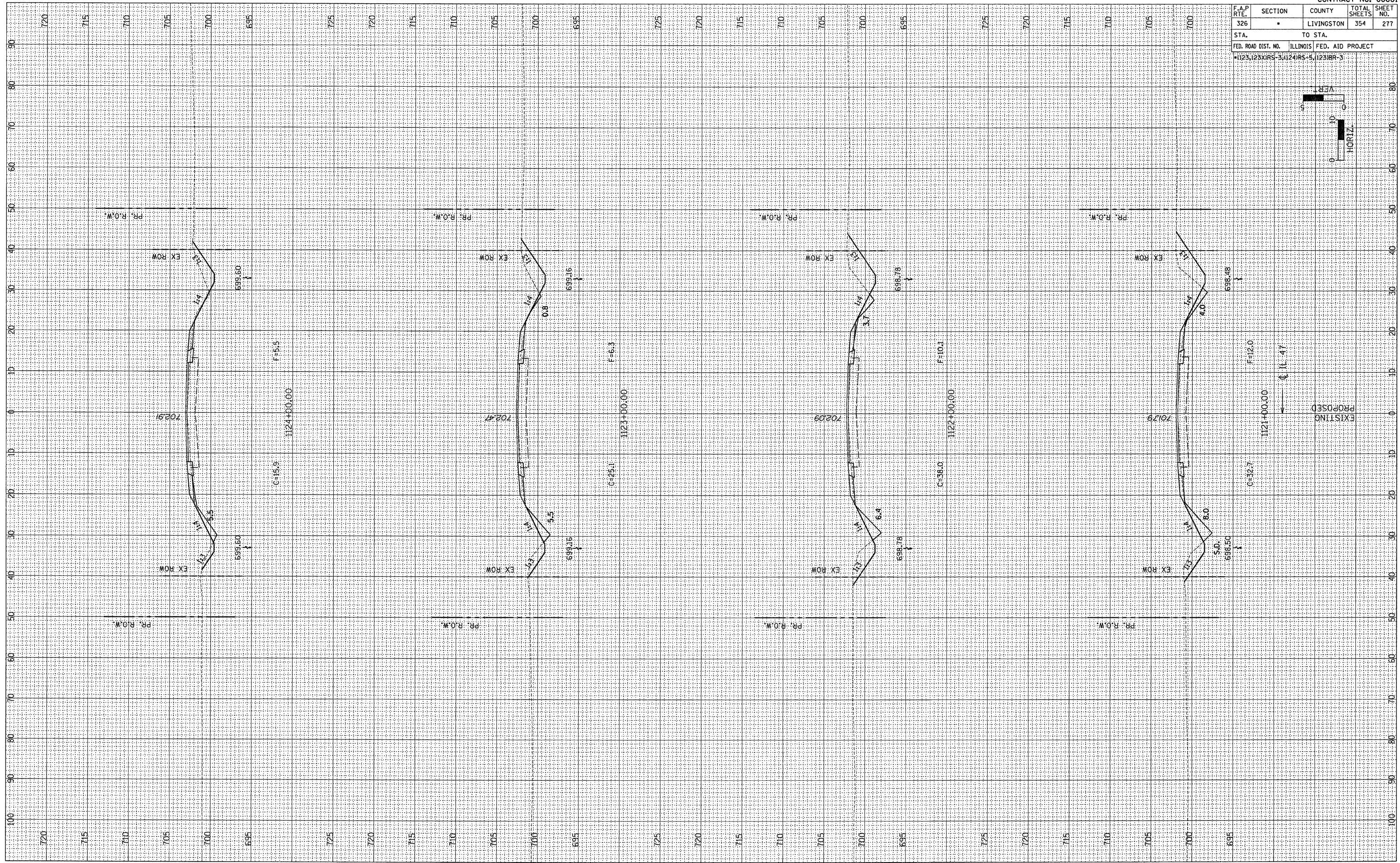
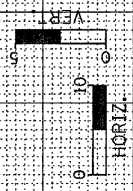

EXISTING
PROPOSED

FINAL SURVEY	BY	DATE
REVIEWED		
PLOTTED		
NOTE BOOK		
AREAS CHECKED		
NO.		

ORIGINAL SURVEY	BY	DATE
REVIEWED		
PLOTTED		
NOTE BOOK		
AREAS CHECKED		
NO.		