

F.A.P. RTE.	SECTION	COUNTY	TOTAL SHEETS	SHEET NO.
326	*	LIVINGSTON	354	279
STA. TO STA.		ILLINOIS FED. AID PROJECT		
FED. ROAD DIST. NO.		*023,128XRS-3,(124)RS-5,(123)BR-3		

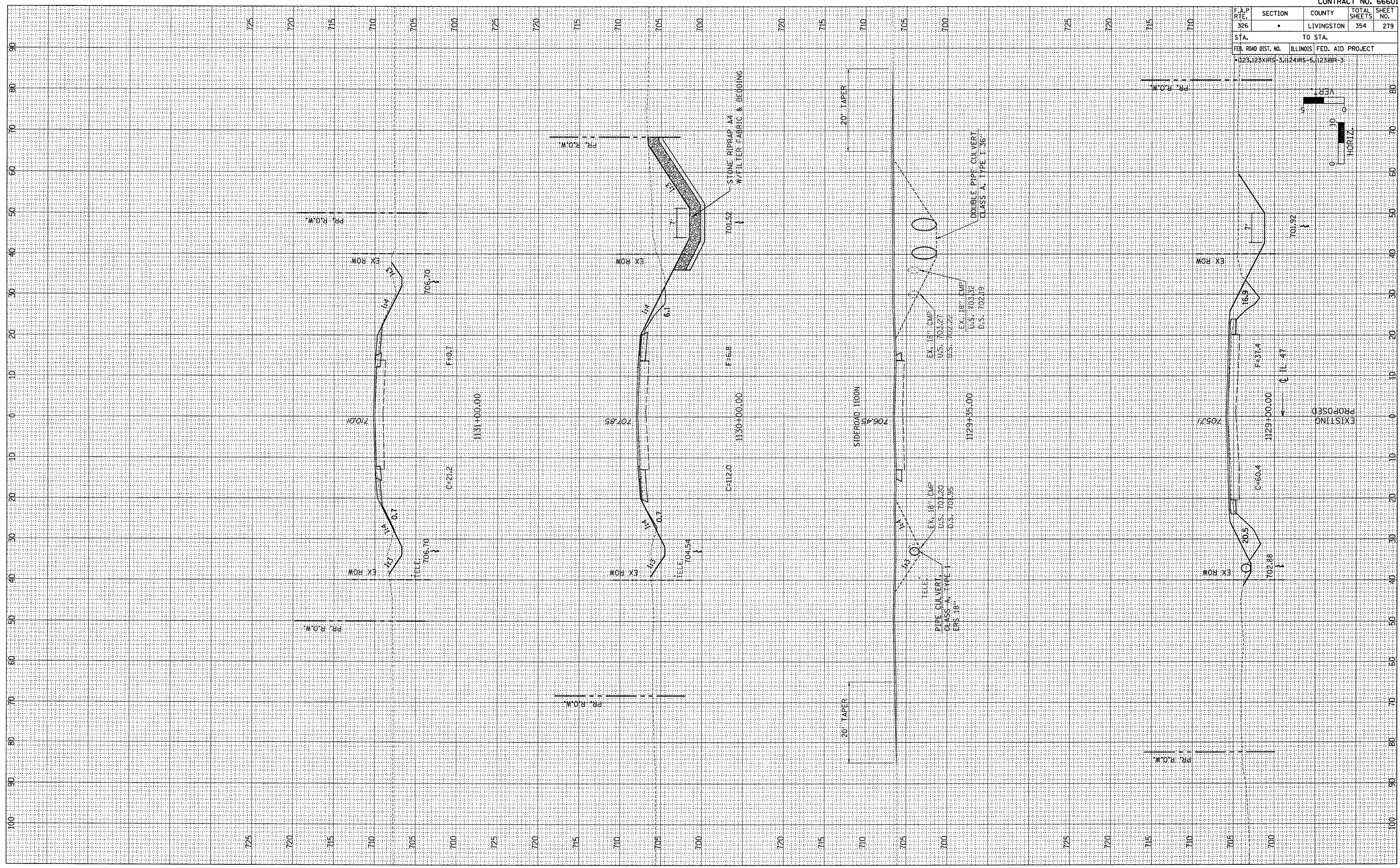
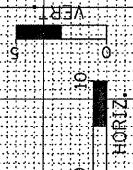

FINAL SURVEY	BY	DATE
REVISIONS		
NOTED		
NO. _____		

ORIGINAL SURVEY	BY	DATE
REVISIONS		
NOTED		
NO. _____		