

F.A.P. RTE.	SECTION	COUNTY	TOTAL SHEETS	SHEET NO.
326		LIVINGSTON	354	291
STA.		TO STA.		
FED. ROAD DIST. NO.		ILLINOIS FED. AID PROJECT		
•1123,123XIRS-3,124IRS-5,123IBR-3				

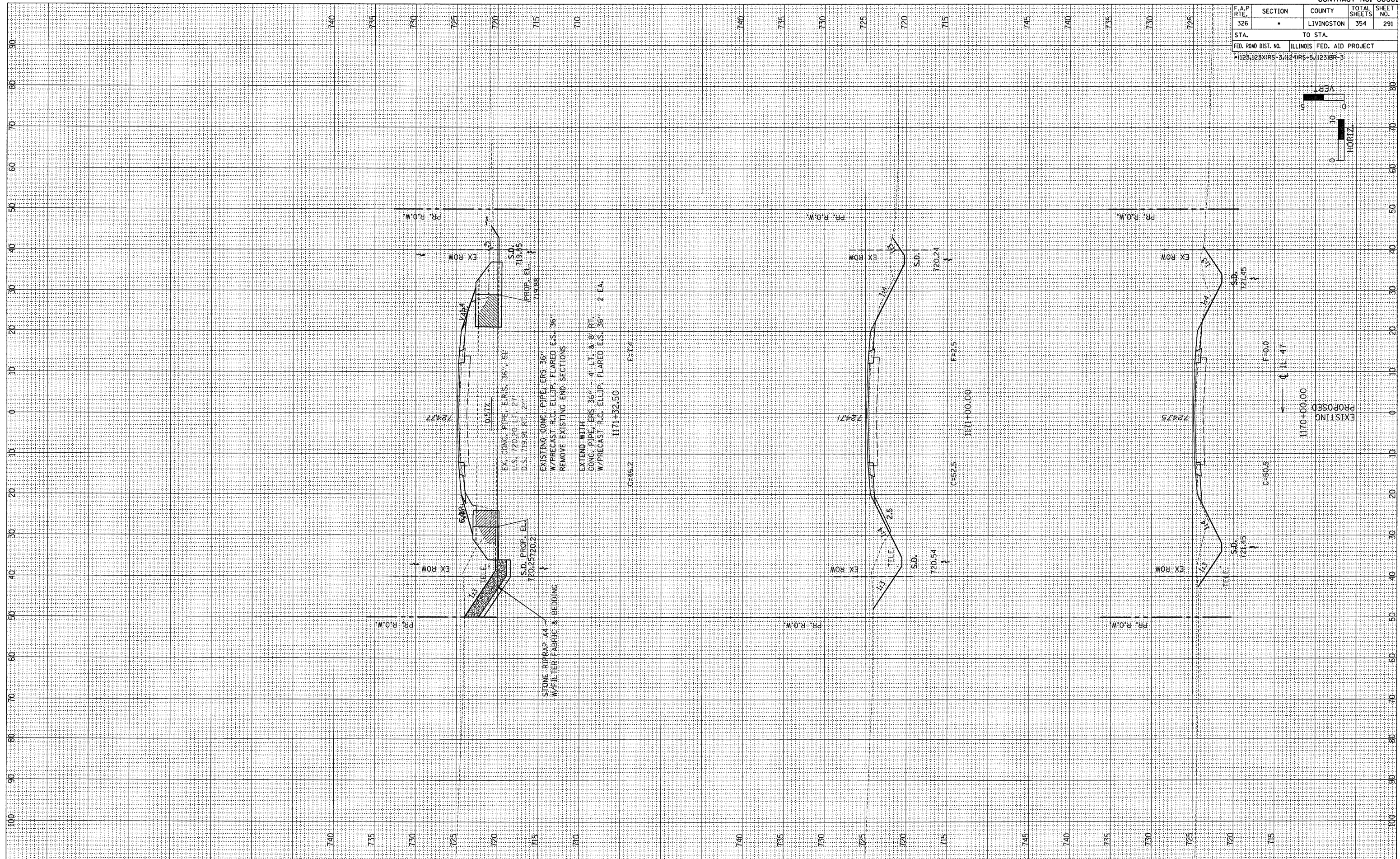
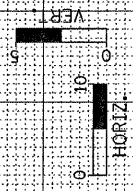

EXISTING CONC. PIPE, ERS, 36" SI
 U.S. 720.20 L.I., 27'
 D.S. 719.91 RT., 24'

EXISTING CONC. PIPE, ERS, 36"
 W/PRECAST R.C. ELLIP. FLARED E.S. 36"
 REMOVE EXISTING END SECTIONS

EXTEND WITH
 CONC. PIPE, ERS, 36" 4' L.T. & 8' RT.
 W/PRECAST R.C. ELLIP. FLARED E.S. 36" 2 EA.

STONE RIPRAP A4
 W/FILTER FABRIC & BEDDING

S.D. 720.24

S.D. 720.54

S.D. 721.75

S.D. 721.45

FINAL SURVEY	DATE
REVISED SURVEY	BY
NOTE BOOK	NO.
AREAS CHECKED	

ORIGINAL SURVEY	DATE
REVISED SURVEY	BY
NOTE BOOK	NO.
AREAS CHECKED	