

F.A.P. RTE.	SECTION	COUNTY	TOTAL SHEETS	SHEET NO.
326	.	LIVINGSTON	354	293
STA.		TO STA.		
FED. ROAD DIST. NO.	ILLINOIS	FED. AID PROJECT		
•1123,123X1RS-3,1241RS-5,1231BR-3				

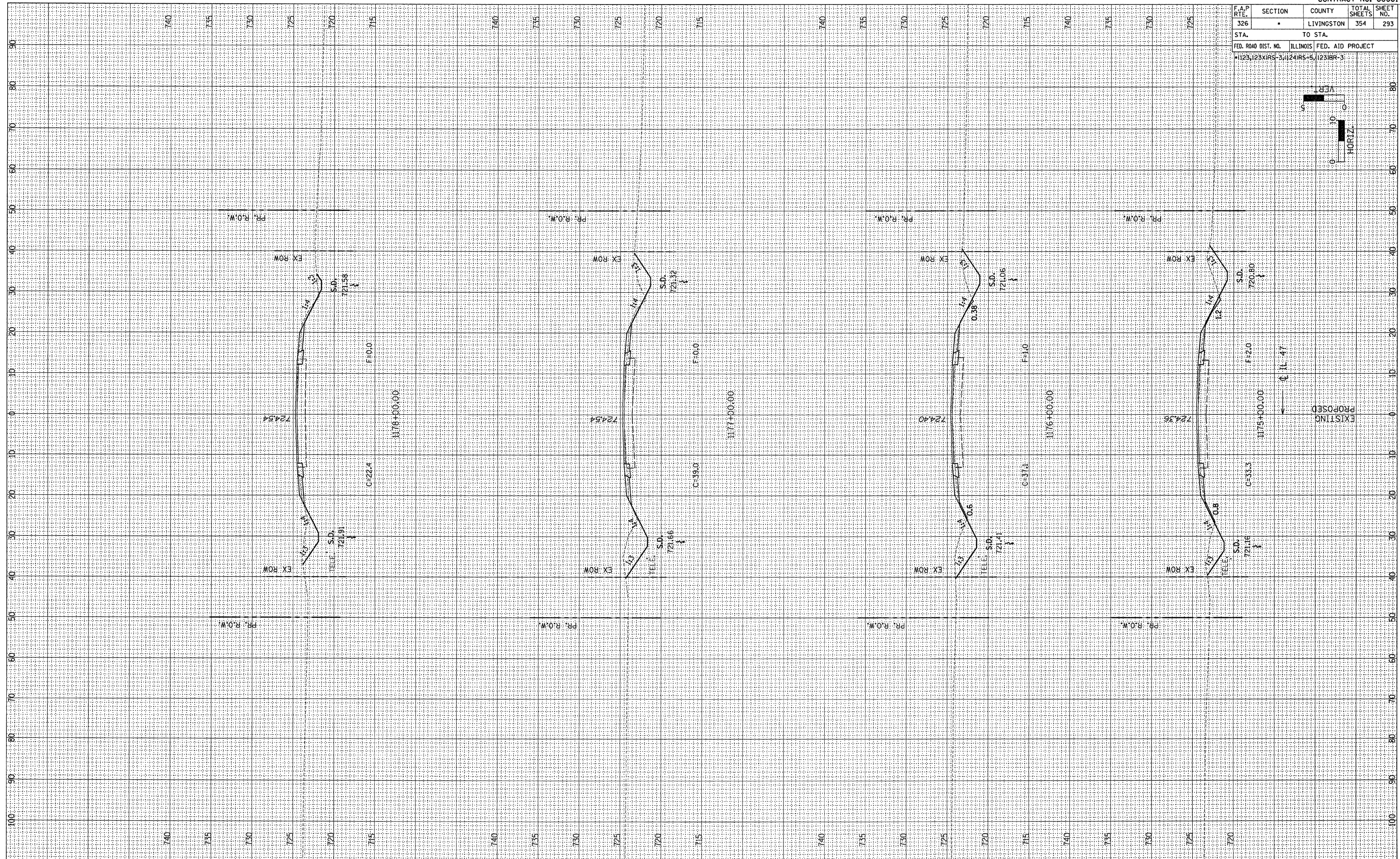
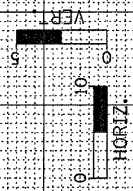

PROPOSED
EXISTING

FINAL SURVEY	DATE
SURVEYED	BY
NOTE BOOK	
TEMPLATE	
AREAS	
CHECKED	

ORIGINAL SURVEY	DATE
NOTED	BY
NOTE BOOK	
TEMPLATE	
AREAS	
CHECKED	