

F.A.P. RTE.	SECTION	COUNTY	TOTAL SHEETS	SHEET NO.
326	*	LIVINGSTON	354	296
STA.		TO STA.		
FED. ROAD DIST. NO.		ILLINOIS FED. AID PROJECT		
*123,125XRS-3,(124)RS+5,(123)BR-3				

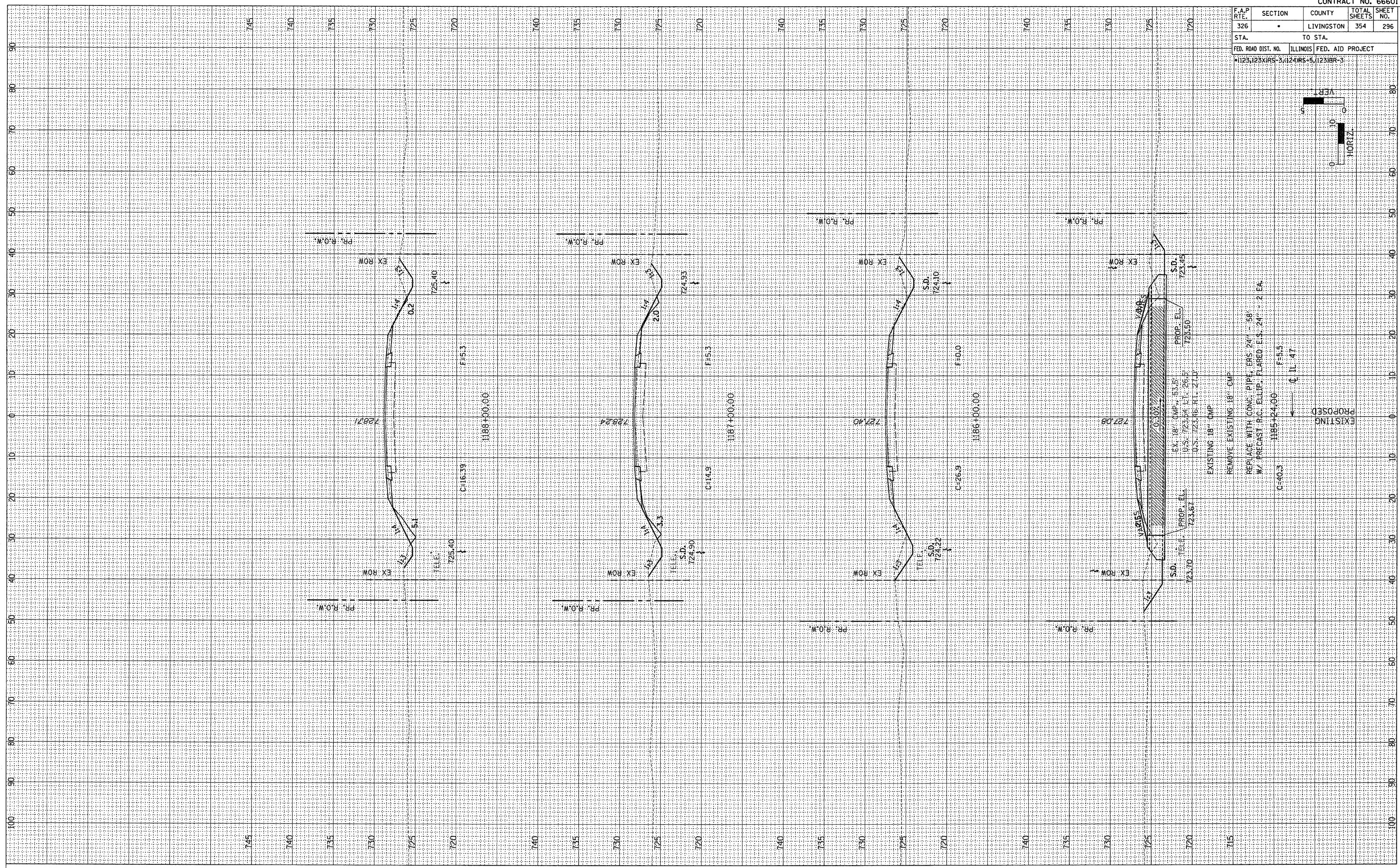
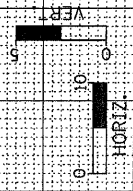

EXISTING 18" CMP  
 REMOVE EXISTING 18" CMP  
 REPLACE WITH CONC. PIPE, ERS 24" x 38"  
 W/ PRECAST R.C. ELLIP. FLARED ELS. 24" x 2 EA.  
 C=40.3 H85+24.00 F=5.5  
 C I L 47

PROPOSED

EXISTING

FINAL SURVEY	BY	DATE
SCHEMATIC		
NOTE BOOK		
AREAS CHECKED		

ORIGINAL SURVEY	BY	DATE
SCHEMATIC		
NOTE BOOK		
AREAS CHECKED		