

F.A.P. RTE. 326	SECTION •	COUNTY LIVINGSTON	TOTAL SHEETS 354	SHEET NO. 299
STA. 1123+125KRS-3, 1124+RS-5, 1123IBR-3		TO STA.		
FED. ROAD DIST. NO. ILLINOIS FED. AID PROJECT				

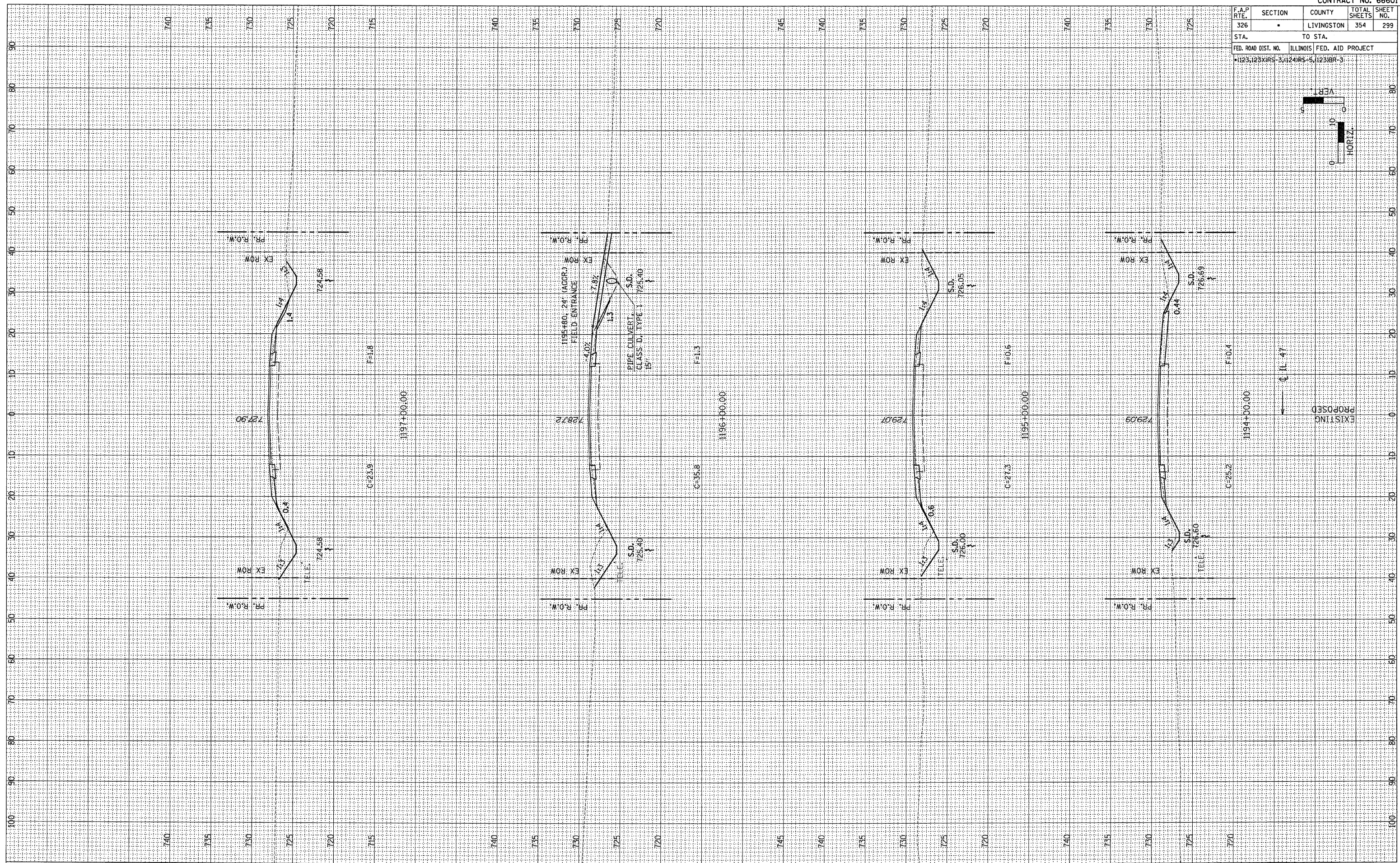
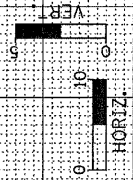

ORIGINAL SURVEY	BY	DATE
PLOTTED		
TEMPLATE		
AREAS CHECKED		
NO.		

ORIGINAL SURVEY	BY	DATE
PLOTTED		
TEMPLATE		
AREAS CHECKED		
NO.		