

F.A.P. RTE. 326	SECTION •	COUNTY LIVINGSTON	TOTAL SHEETS 354	SHEET NO. 304
STA.		TO STA.		
FED. ROAD DIST. NO.		ILLINOIS FED. AID PROJECT		
•1123,123XIRS-3,124IRS-5,123IBR-3				

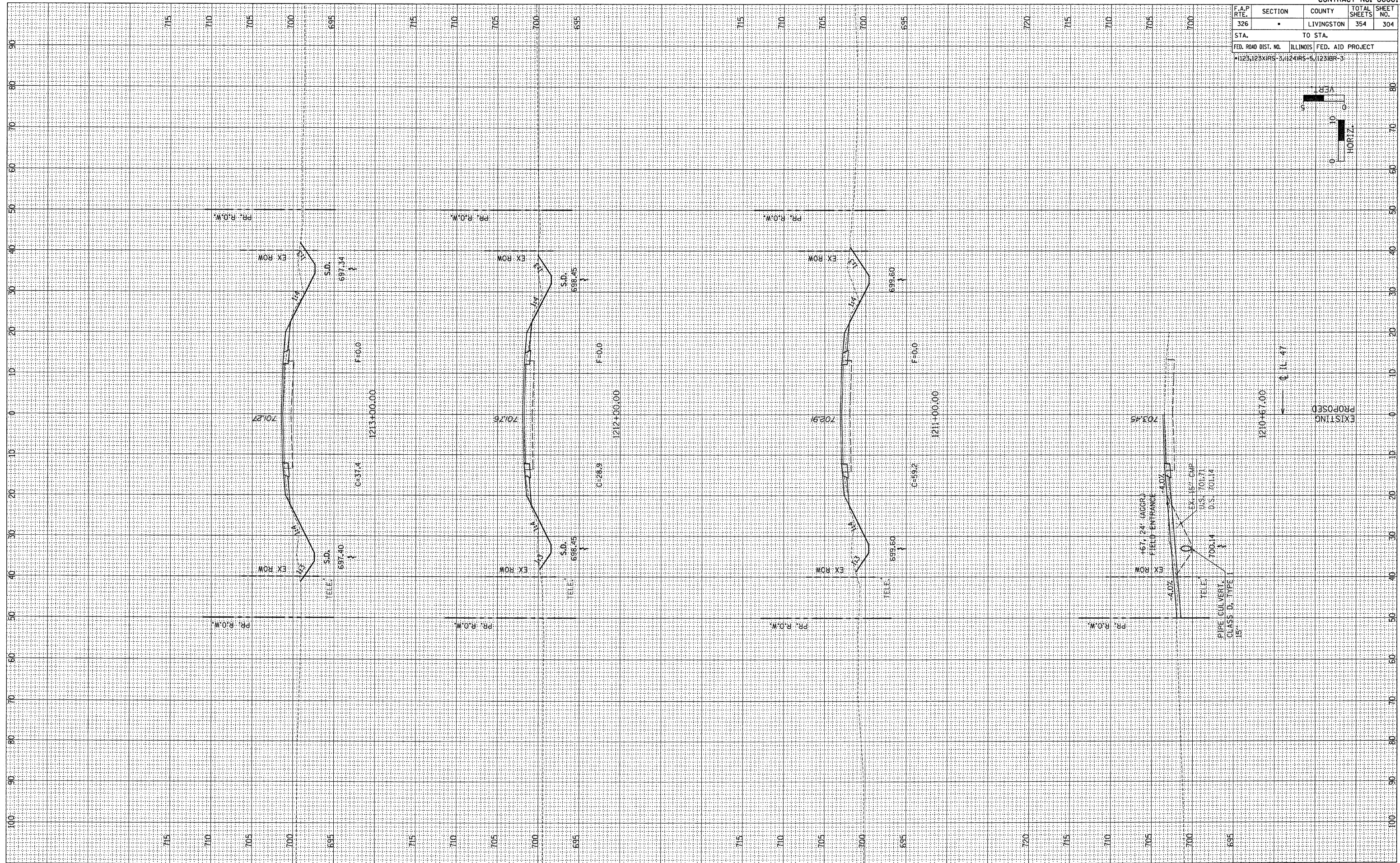
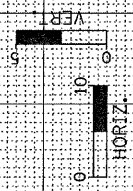

FINAL SURVEY	DATE
REVIEWED	BY
NOTED	
NO.	

ORIGINAL SURVEY	DATE
REVIEWED	BY
NOTED	
NO.	