

F.A.P. RTE.	SECTION	COUNTY	TOTAL SHEETS	SHEET NO.
326	*	LIVINGSTON	354	310
STA.		TO STA.		
FED. ROAD DIST. NO.		ILLINOIS	FED. AID PROJECT	
1123123XIR5-3, 1241RS-5, 1231BR-3				

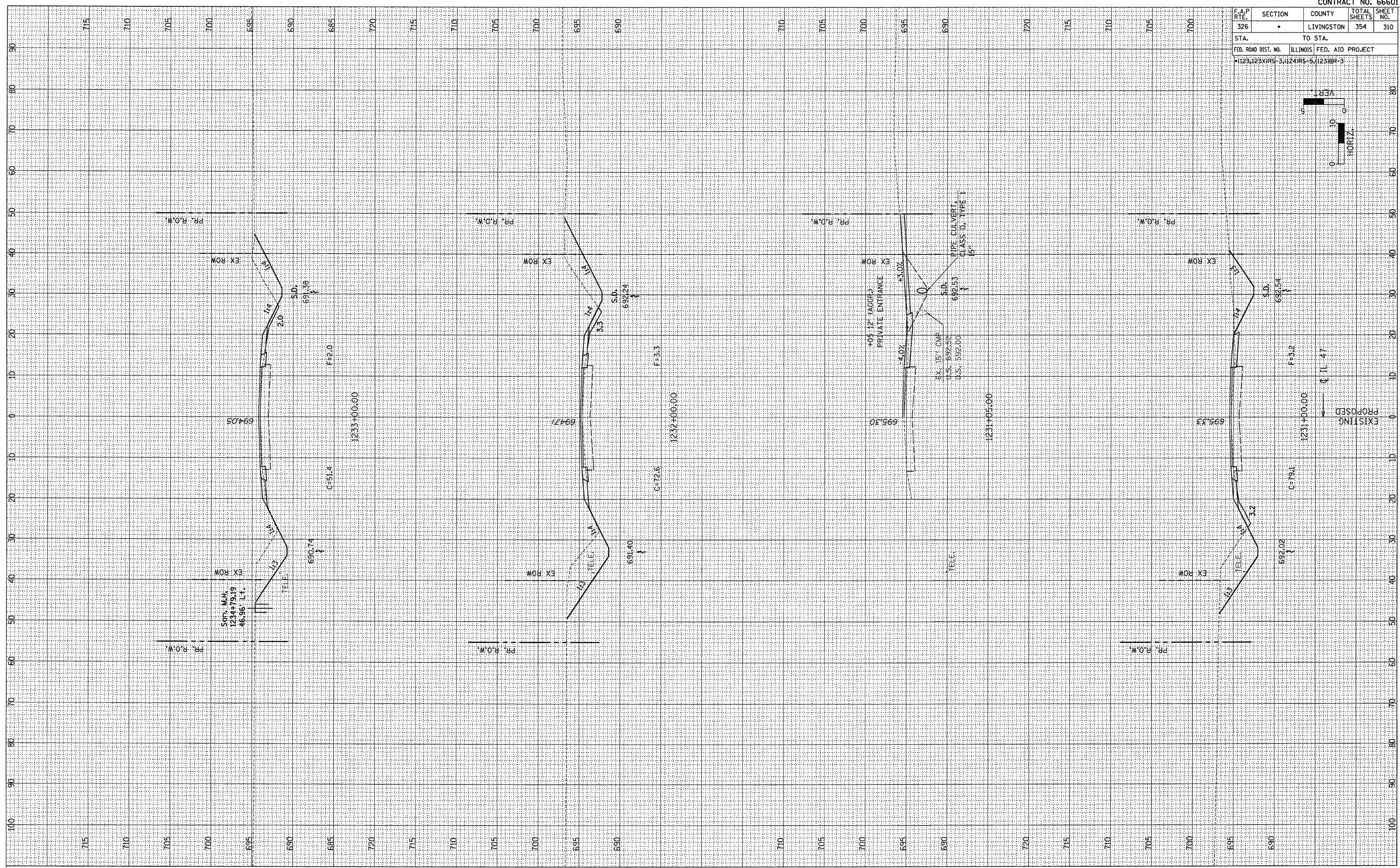
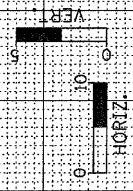

FINAL SURVEY	BY	DATE
REVISIONS		
PLOTTED		
TEMPLATE		
NOTE BOOK		
AREAS		
CHECKED		

ORIGINAL SURVEY	BY	DATE
REVISIONS		
PLOTTED		
TEMPLATE		
NOTE BOOK		
AREAS		
CHECKED		