

F.A.P. RTE.	SECTION	COUNTY	TOTAL SHEETS	SHEET NO.
326	*	LIVINGSTON	354	340
STA.		TO STA.		
FED. ROAD DIST. NO.		ILLINOIS FED. AID PROJECT		
4123.123XRS-3		124RS-5.023BR-3		

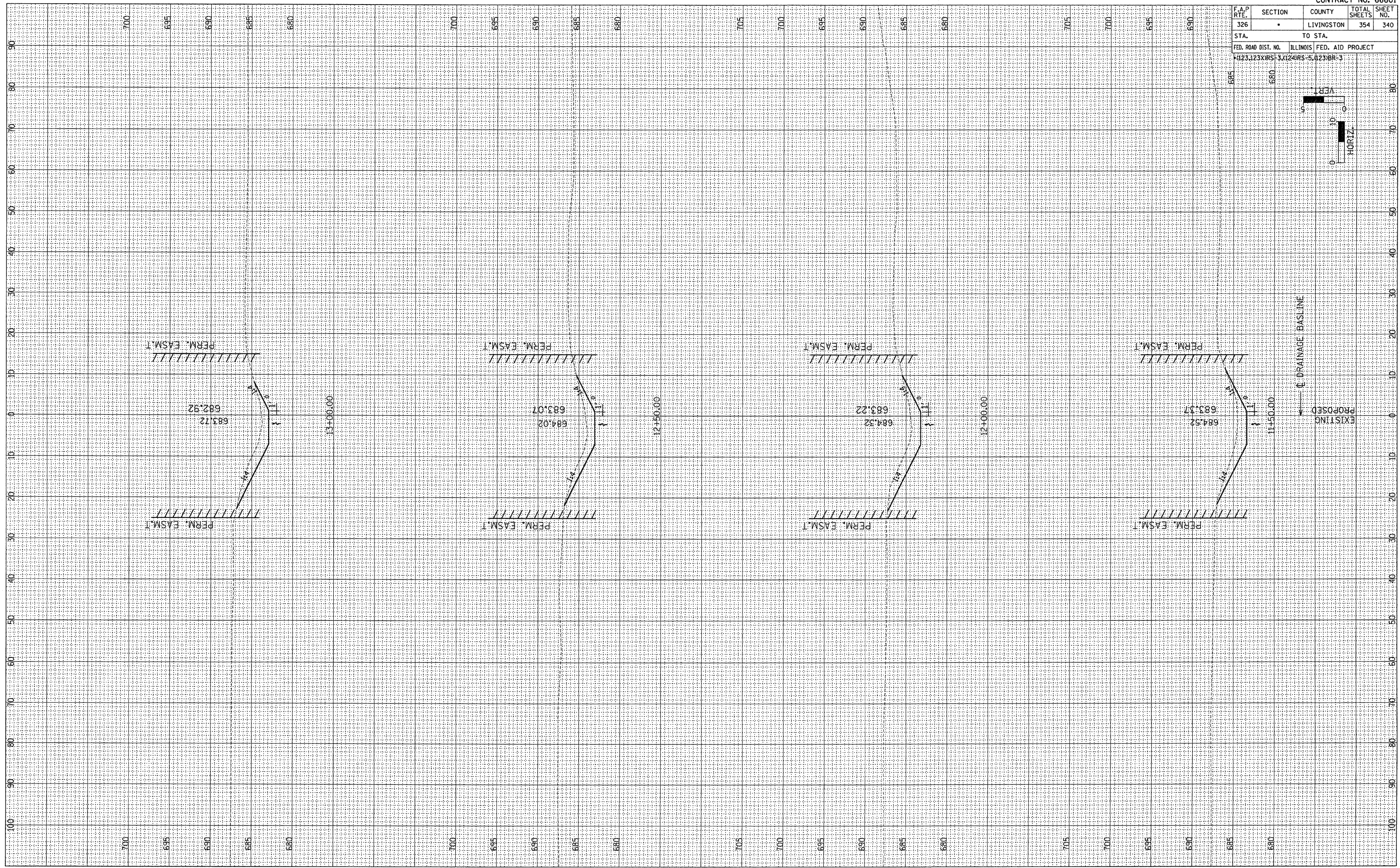
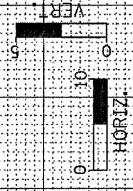

EXISTING  
PROPOSED

DRAINAGE BASLINE

FINAL SURVEY	BY	DATE
REVISIONS		
PLOTTED		
TEMPLATE		
AREAS		
CHECKED		

ORIGINAL SURVEY	BY	DATE
REVISIONS		
PLOTTED		
TEMPLATE		
AREAS		
CHECKED		