

F.A.P. RTE.	SECTION	COUNTY	TOTAL SHEETS	SHEET NO.
326		LIVINGSTON	354	354
STA.		TO STA.		
FED. ROAD DIST. NO.	ILLINOIS	FED. AID PROJECT		
•(123,123X)RS-3, (124)RS-5, (123)BR-3				

FOR INFORMATION ONLY

51

SO-DEEP
The Subsurface Utility Engineering Company
6877 Euclid Avenue
Manassas Park, VA 20111
703.261.0008

Designated By: C.C.
Drafted By: B.W.S.
Checked By: R.G.B.
Date: 8-24-2007

SIMB024

STATE OF ILLINOIS
RONALD G. BRIGHT
35-3157
ST. JACOB
ILLINOIS
PROFESSIONAL LAND SURVEYOR

I, RONALD G. BRIGHT, CERTIFY TO THE ILLINOIS DEPARTMENT OF TRANSPORTATION THAT TO THE BEST OF MY KNOWLEDGE AND BELIEF, THE UTILITY INFORMATION DEPICTED BY SO-DEEP ON THIS PLAN SHEET WAS OBTAINED AND COMPILED UNDER MY DIRECT SUPERVISION USING ACCEPTED PRACTICES AND PROCEDURES.

DATE: _____

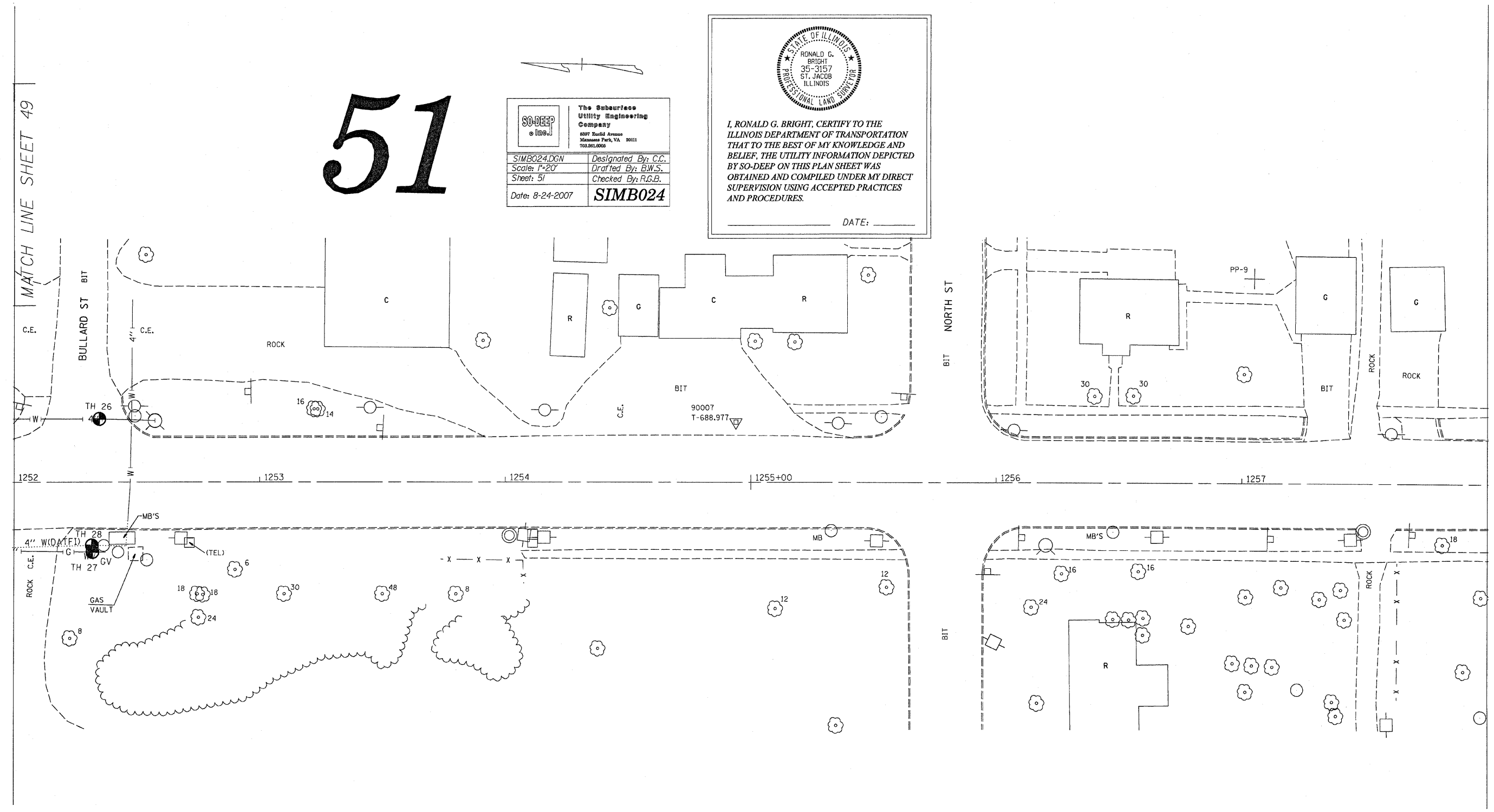

PLOT DATE = Dec. 18, 2007 - 11:07:54 AM
FILE NAME = c:\p09\mca26598\consult\wooddeep\simb024.dgn
PLOT SCALE = 28.5000 / 1 IN.
USER NAME = schuenkern

REVISIONS	
NAME	DATE

ILLINOIS DEPARTMENT OF TRANSPORTATION

SUBSURFACE UTILITY EXPLORATION

SCALE: VERT. _____
HORIZ. _____
DATE _____

DRAWN BY _____
CHECKED BY _____