

MATCH LINE STA. 332 + 00

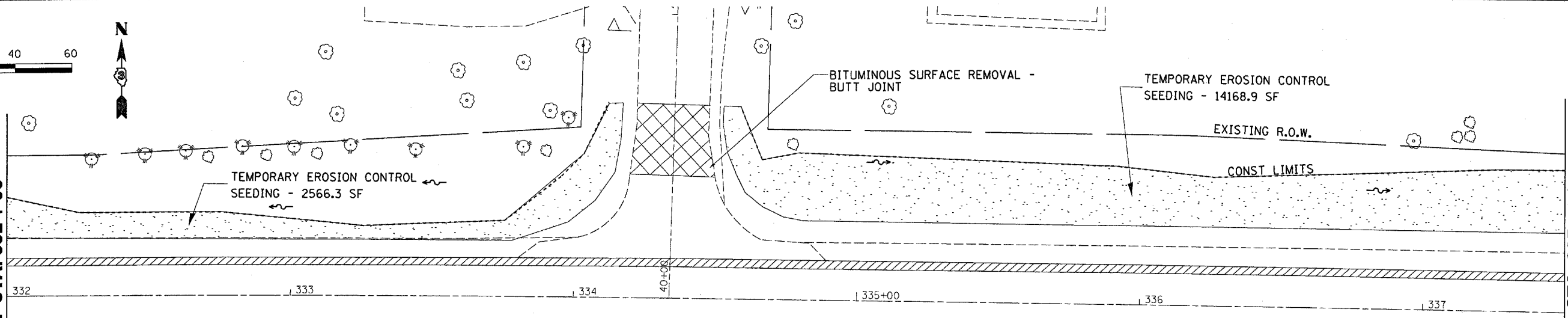

MATCH LINE STA. 337 + 50

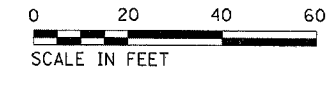

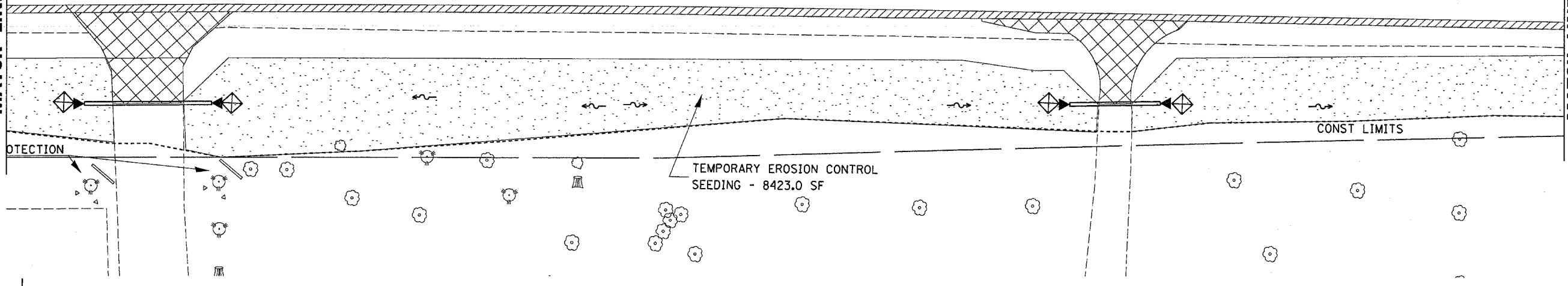

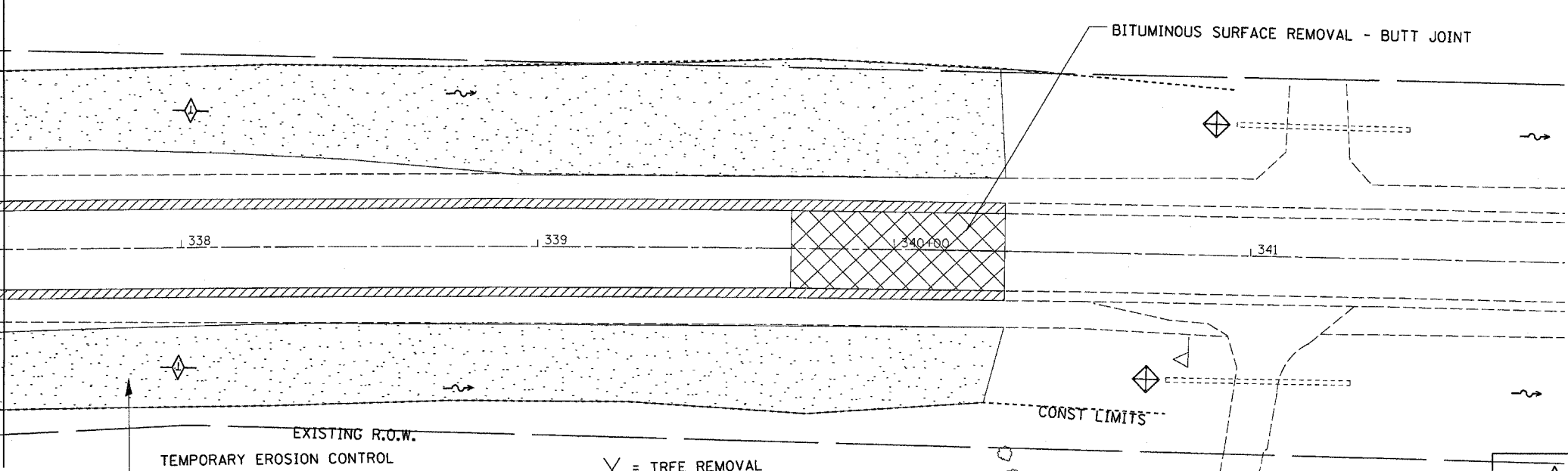

MATCH LINE STA. 337 + 50

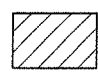

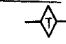
X = TREE REMOVAL

 BITUMINOUS SHOULDER REMOVAL

	TEMPORARY DITCH CHECK
	INLET AND PIPE PROTECTION
	PERIMETER EROSION CONTROL BARRIER
	TEMPORARY EROSION CONTROL SEEDING

FILE NAME = c:\projects\ed03006\planshta.dgn	USER NAME = ferguson	DESIGNED -	REVISED -	STATE OF ILLINOIS DEPARTMENT OF TRANSPORTATION	REMOVAL AND EROSION CONTROL PLAN	F.A.P. RTE. 567	SECTION 34 N & N-1	COUNTY DEKALB	TOTAL SHEETS 62	SHEET NO. 21
PLOT SCALE = 20.0000' / IN.	DRAWN -	REVISED -	SCALE:			SHEET NO. OF SHEETS STA. TO STA.	FED. ROAD DIST. NO.	ILLINOIS FED. AID PROJECT	CONTRACT NO. 66632	
PLOT DATE = Dec 17, 2007 - 09:26:15 AM	CHECKED -	REVISED -								
	DATE -	REVISED -								