

F.A.P. RTE.	SECTION	COUNTY	TOTAL SHEETS	SHEET NO.
41	12 I	KANKAKEE	21	7
STA. _____ TO STA. _____		FED. ROAD DIST. NO. _____ ILLINOIS FED. AID PROJECT		



AGGREGATE FOR TEMPORARY ACCESS	
LOCATION	TON
STA 1185+07.8 TO STA 1187+70.9, RT.	100
---	---
---	---
---	---
---	---
TOTAL	100

TEMPORARY BRIDGE TRAFFIC SIGNALS	
LOCATION	EACH
STA 1183+90 TO STA 1191+72.5	1
---	---
---	---
---	---
TOTAL	1

RELOCATE TEMPORARY CONCRETE BARRIER	
LOCATION	FOOT
STAGE III	312.5
---	---
---	---
---	---
TOTAL	312.5

IMPACT ATTENUATORS, RELOCATE (NON-REDIRECTIVE), TEST LEVEL 3	
LOCATION	EACH
STAGE III	2
---	---
---	---
---	---
TOTAL	2

TRAFFIC CONTROL SURVEILLANCE	
LOCATION	CAL DA
STAGE I	7
---	---
---	---
---	---
TOTAL	7

TEMPORARY CONCRETE BARRIER	
LOCATION	FOOT
STAGE II	312.5
STAGE III	50
---	---
---	---
TOTAL	362.5

IMPACT ATTENUATORS, TEMPORARY (NON-REDIRECTIVE), TEST LEVEL 3	
LOCATION	EACH
STAGE II	2
---	---
---	---
---	---
TOTAL	2

- LEGEND:
- IMPACT ATTENUATOR
 - DRUM WITH STEADY BURNING LIGHT
 - TEMPORARY BRIDGE TRAFFIC SIGNAL
 - TYPE III BARRICADE TO BE IN PLACE WHEN NO WORK IS BEING PERFORMED
 - TEMPORARY PAVEMENT
 - DOUBLE VERTICAL PANEL AT 50' O.C.

NOTE:
TRAFFIC SIGNALS FOR PRIVATE ENTRANCE SHALL BE EQUIPPED WITH MICROWAVE DETECTOR.

TEMPORARY PIPE CULVERT EQUIVALENT ROUND SIZE 42" 34 FOOT

TEMPORARY SOIL RETENTION SYSTEM

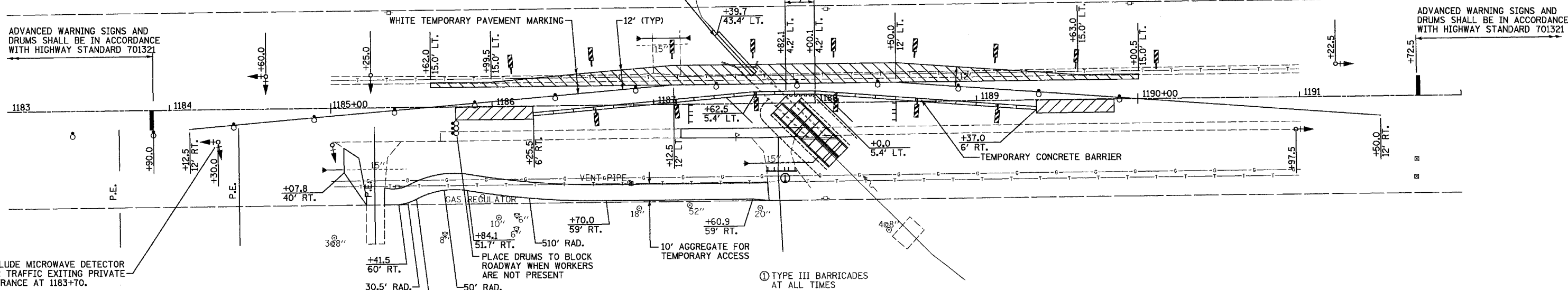

INCLUDE MICROWAVE DETECTOR FOR TRAFFIC EXITING PRIVATE ENTRANCE AT 1183+70.

ADVANCED WARNING SIGNS AND DRUMS SHALL BE IN ACCORDANCE WITH HIGHWAY STANDARD 701321

PLACE DRUMS TO BLOCK ROADWAY WHEN WORKERS ARE NOT PRESENT

TYPE III BARRICADES AT ALL TIMES

SEQUENCE OF WORK

- STAGE I (UTILIZING HIGHWAY STANDARD 701326)
 CONSTRUCT AGGREGATE FOR TEMPORARY ACCESS ALONG SOUTH ROW.
 INSTALL TEMPORARY PIPE CULVERT AT NORTH END OF EXISTING BOX CULVERT.
 CONSTRUCT TEMPORARY PAVEMENT WIDENING.
 ERECT STAGE II TRAFFIC CONTROL.
- STAGE II (UTILIZING HIGHWAY STANDARD 701321 AND DETAILS IN PLANS)
 CONSTRUCT SOUTH HALF OF NEW BOX CULVERT.
 PARTIALLY CONSTRUCT NEW PAVEMENT FOR EASTBOUND LANE.
 CONSTRUCT TEMPORARY PAVEMENT WIDENING.
 ERECT STAGE III TRAFFIC CONTROL

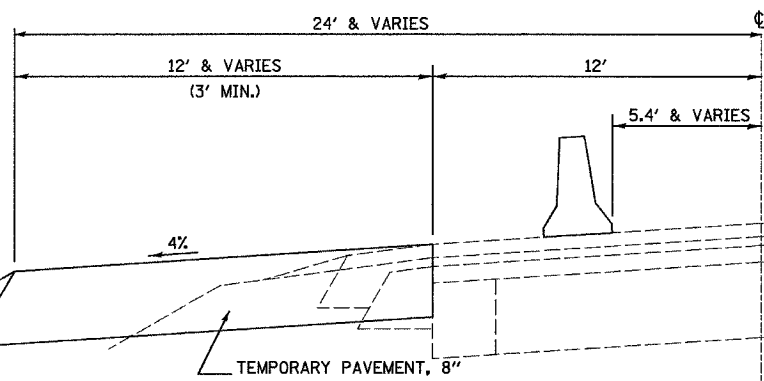

**STAGE I
PAVEMENT WIDENING**
 LT. STA 1185+62.0 TO STA 1190+00.5
 N.T.S.

REVISIONS	
NAME	DATE

ILLINOIS DEPARTMENT OF TRANSPORTATION
**STAGE II
 TRAFFIC CONTROL PLAN**
 FAP 41 (IL 17)
 SECTION 12 I
 KANKAKEE COUNTY

VERT. SCALE: _____
 HORIZ. SCALE: 10/07
 DRAWN BY: KKP
 CHECKED BY: JKC