

F.A.P. RTE.	SECTION	COUNTY	TOTAL SHEETS	SHEET NO.
646	(121)I-2	BUREAU	13	1
FED. ROAD DIST. NO.	ILLINOIS	CONTRACT NO. 66732		

STATE OF ILLINOIS
DEPARTMENT OF TRANSPORTATION
DIVISION OF HIGHWAYS
**PROPOSED
HIGHWAY PLANS**

FAP ROUTE 646 (IL ROUTE 40)
SECTION (121)I-2

BUREAU COUNTY
C-93-001-08
BOX CULVERT REPAIR

INDEX OF SHEETS

1. COVER SHEET
2. GENERAL NOTES
3. SUMMARY OF QUANTITIES
4. TYPICAL SECTIONS
5. GENERAL PLAN
6. STAGING DETAILS SB
7. STAGING DETAILS NB
8. EXISTING PLAN AND ELEVATIONS
9. BORING LOGS
10. CONCRETE REMOVAL DETAILS
11. CONCRETE BOX CULVERTS
12. WATERPROOFING DETAILS
13. EXISTING BOX CULVERT DETAILS

STANDARDS

- | | |
|-----------|--|
| 000001-05 | STANDARD SYMBOLS, ABBREVIATIONS AND PATTERNS |
| 001001-01 | AREAS OF REINFORCEMENT BARS |
| 001006 | DECIMAL OF AN INCH AND OF A FOOT |
| 482001-02 | HMA SHOULDER ADJACENT TO FLEXIBLE PAVEMENT |
| 630001-07 | STEEL PLATE BEAM GUARDRAIL |
| 630101-07 | GUARDRAIL MOUNTED ON EXISTING CULVERTS |
| 635011-01 | REFLECTOR MARKER AND MOUNTING DETAILS |
| 701001-01 | OFF-ROAD OPERATIONS 2L, 2W, MORE THAN 4.5 m (15') AWAY |
| 701006-02 | OFF-ROAD OPERATIONS 2L, 2W, 4.5 m (15') TO 600 mm (24") FROM PAVEMENT EDGE |
| 701201-02 | LANE CLOSURE, 2L, 2W, DAY ONLY, FOR SPEEDS ≥ 45 MPH |
| 701206-01 | LANE CLOSURE, 2L, 2W, NIGHT ONLY, FOR SPEEDS ≥ 45 MPH |
| 701316-03 | LANE CLOSURE, 2L, 2W, BRIDGE REPAIR, FOR SPEEDS ≥ 45 MPH |
| 701901 | TRAFFIC CONTROL DEVICES |

PROJECT LOCATION
SN 006-2523
8' X 6' BOX CULVERT
2.0 MI. SOUTH OF US ROUTE 6

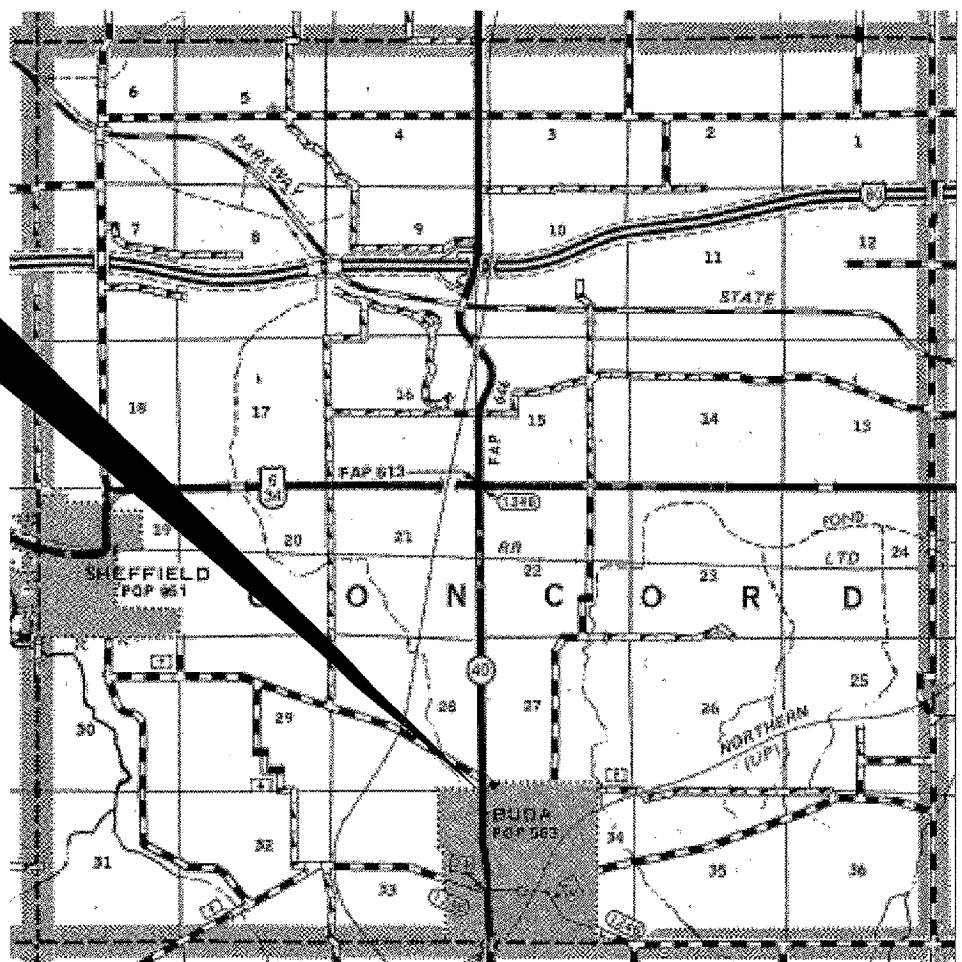

LOCATION MAP
NOT TO SCALE
POINT LOCATION

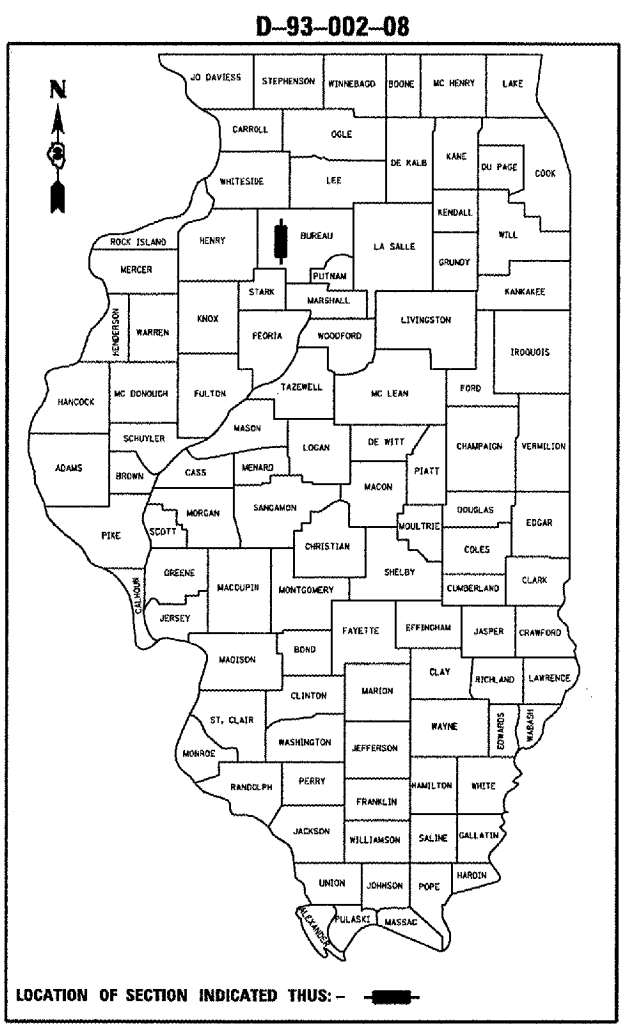

FUNCTIONAL CLASSIFICATION
RURAL - MINOR ARTERIAL
F.A.P. ROUTE 646 (IL 40)
2005 ADT = 1800
P.V = 82.0% M.U. = 9.7% S.U. = 8.3%

STATE OF ILLINOIS
DEPARTMENT OF TRANSPORTATION
DIVISION OF HIGHWAYS

SUBMITTED 12/20 20 07
George Lujan
DEPUTY DIRECTOR OF HIGHWAYS, REGION ENGINEER

February 1, 20 08
Eric E. Harm
ENGINEER OF DESIGN AND ENVIRONMENT

February 1, 20 08
Christine M. Reed
DIRECTOR OF HIGHWAYS, CHIEF ENGINEER

**PRINTED BY THE AUTHORITY
OF THE STATE OF ILLINOIS**

MICROFILMED _____
REEL NUMBER _____
AWARDED _____
RESIDENT ENGINEER _____
AS BUILT CHANGES WERE MADE
ON THE FOLLOWING SHEETS _____

J.U.L.I.E.
JOINT UTILITY LOCATION INFORMATION FOR EXCAVATION
1-800-892-0123

DISTRICT 3 NO. (815) 434-6131
PROJECT ENGINEER: JOE KANNEL
UNIT CHIEF: RON WOODSHANK
TOWNSHIP: CONCORD
CONTRACT NO. 66732