

ELEVATION

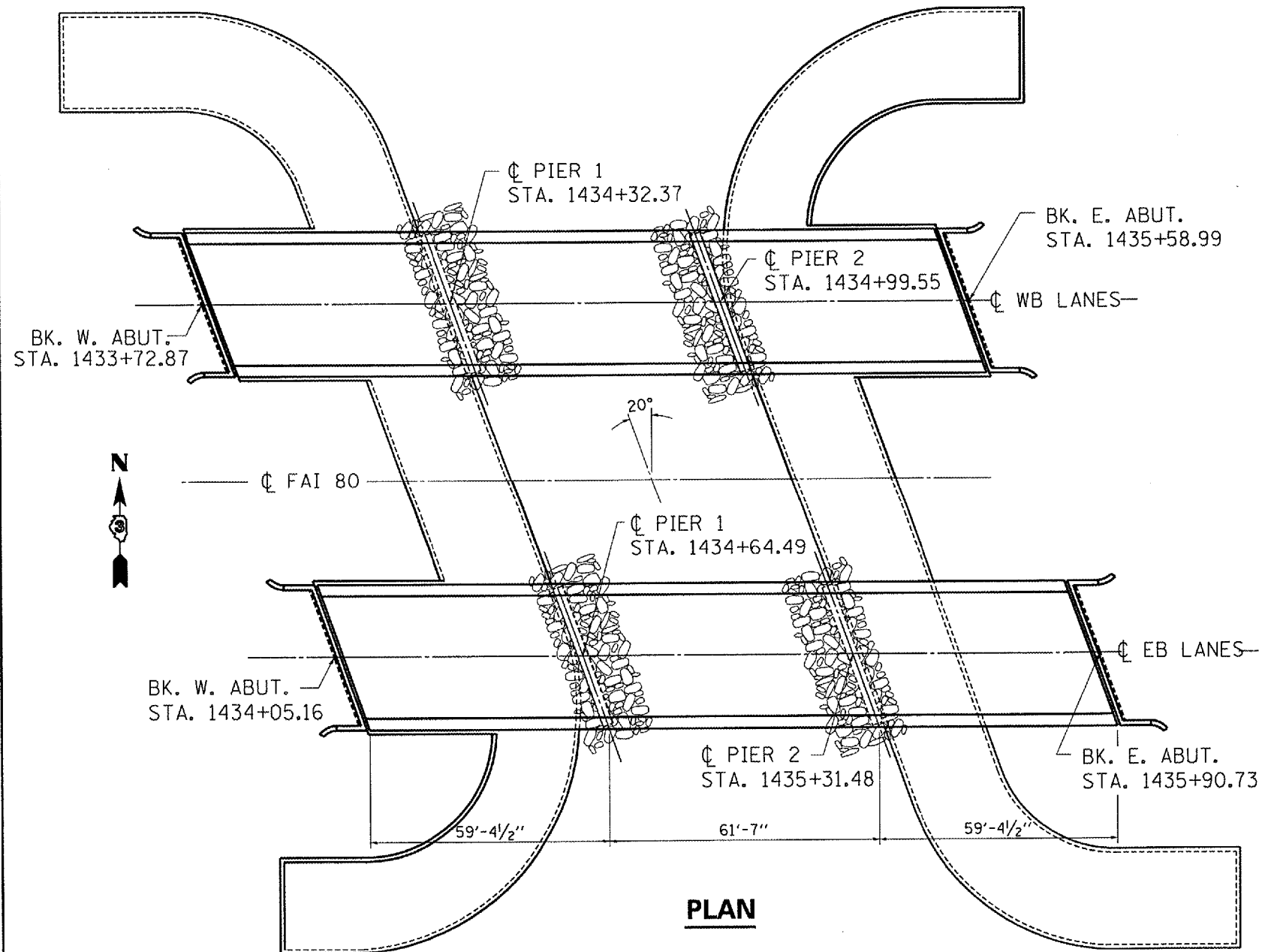

PLAN

NOTES

THE FOLLOWING RATES OF APPLICATION HAVE BEEN USED IN CALCULATING PLAN QUANTITIES:

GRANULAR MATERIALS	1.4	TONS / CU YD
--------------------	-----	--------------

STONE DUMPED RIPRAP, CLASS A4 SHALL BE PLACED AS SHOWN ON PLAN DETAILS OR AS DIRECTED BY THE ENGINEER. NO EXCAVATION SHALL BE PERMITTED FOR THE PLACEMENT OF THE RIPRAP.

TOTAL BILL OF MATERIALS

ITEM	UNIT	TOTAL
STONE DUMPED RIPRAP, CLASS A4	TON	455

FILE NAME = c:\projects\csm318\cm318\details.dgn	USER NAME = woodshankr1	DESIGNED - RON WOODSHANK	REVISED -
		DRAWN - RON WOODSHANK	REVISED -
		CHECKED -	REVISED -
		DATE -	REVISED -

**STATE OF ILLINOIS
DEPARTMENT OF TRANSPORTATION**

PLAN AND ELEVATION

SCALE: NONE SHEET NO. 5 OF 6 SHEETS STA. TO STA.

F.A. RTE. 80	SECTION (06-6B)	COUNTY BUREAU	TOTAL SHEETS 6	SHEET NO. 5
FED. ROAD DIST. NO. ILLINOIS			CONTRACT NO. 66743	