

F.A.P. RTE.	SECTION	COUNTY	TOTAL SHEETS	SHEET NO.
318	72-16-URS	PEORIA	89	26
STA.		TO STA.		
FED. ROAD DIST. NO.		ILLINOIS	FED. AID PROJECT	

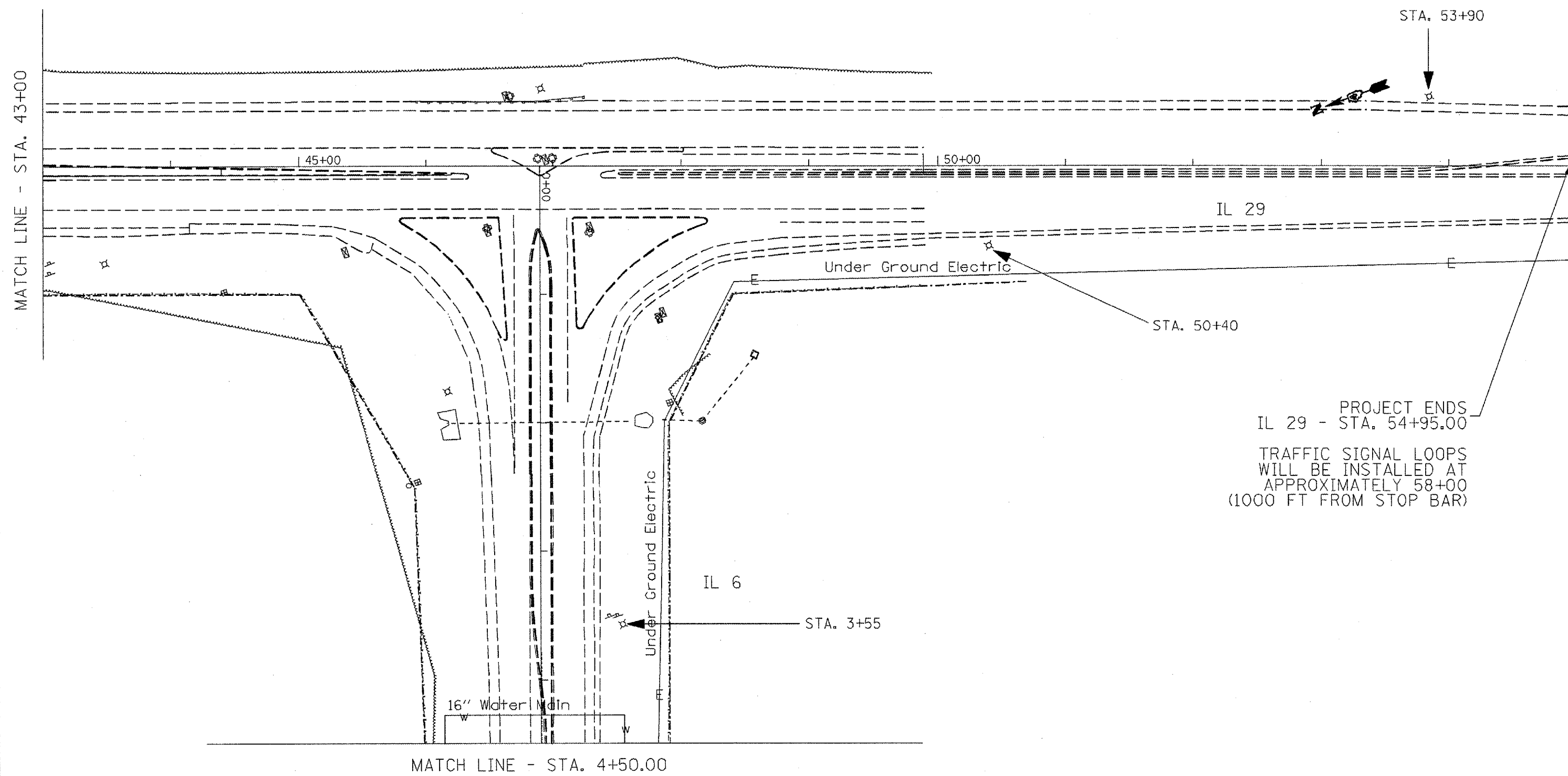

PROJECT ENDS
 IL 29 - STA. 54+95.00
 TRAFFIC SIGNAL LOOPS
 WILL BE INSTALLED AT
 APPROXIMATELY 58+00
 (1000 FT FROM STOP BAR)

REVISIONS		ILLINOIS DEPARTMENT OF TRANSPORTATION	
NAME	DATE		

EXISTING PLAN

SCALE:	VERT. DATE	HORIZ. DATE	DRAWN BY

DT DATE = 12/17/2007
 LE NAME = SAVENKRAFT\STDP\PLNS\SD\HQP\NEA\Native Contracta\68110\Cover sheet & 500.dgn
 DT SCALE = 1/8"=1'-0"
 ER NAME = brucecm