

F.A.P. RTE.	SECTION	COUNTY	TOTAL SHEETS	SHEET NO.
317	146-1/RS-7	PEORIA	62	23
STA.		TO STA.		
FED. ROAD DIST. NO.		ILLINOIS FED. AID PROJECT		

BENCHMARK #2
TOP OF ROW MARKER @
SW CORNER OF PERU ST.
ELEV. 470.57

STA. 58+07.92 FAP 317 (US 24) =
☉ ARGENTINA ST.

STA. 54+77.70 ☉ FAP 317 (US 24) =
☉ WEST PERU ST.

STA. 54+77.30 ☉ FAP 317 (US 24) =
☉ EAST PERU ST.

PAVING ENDS 114.5'
FROM US 24 ☉

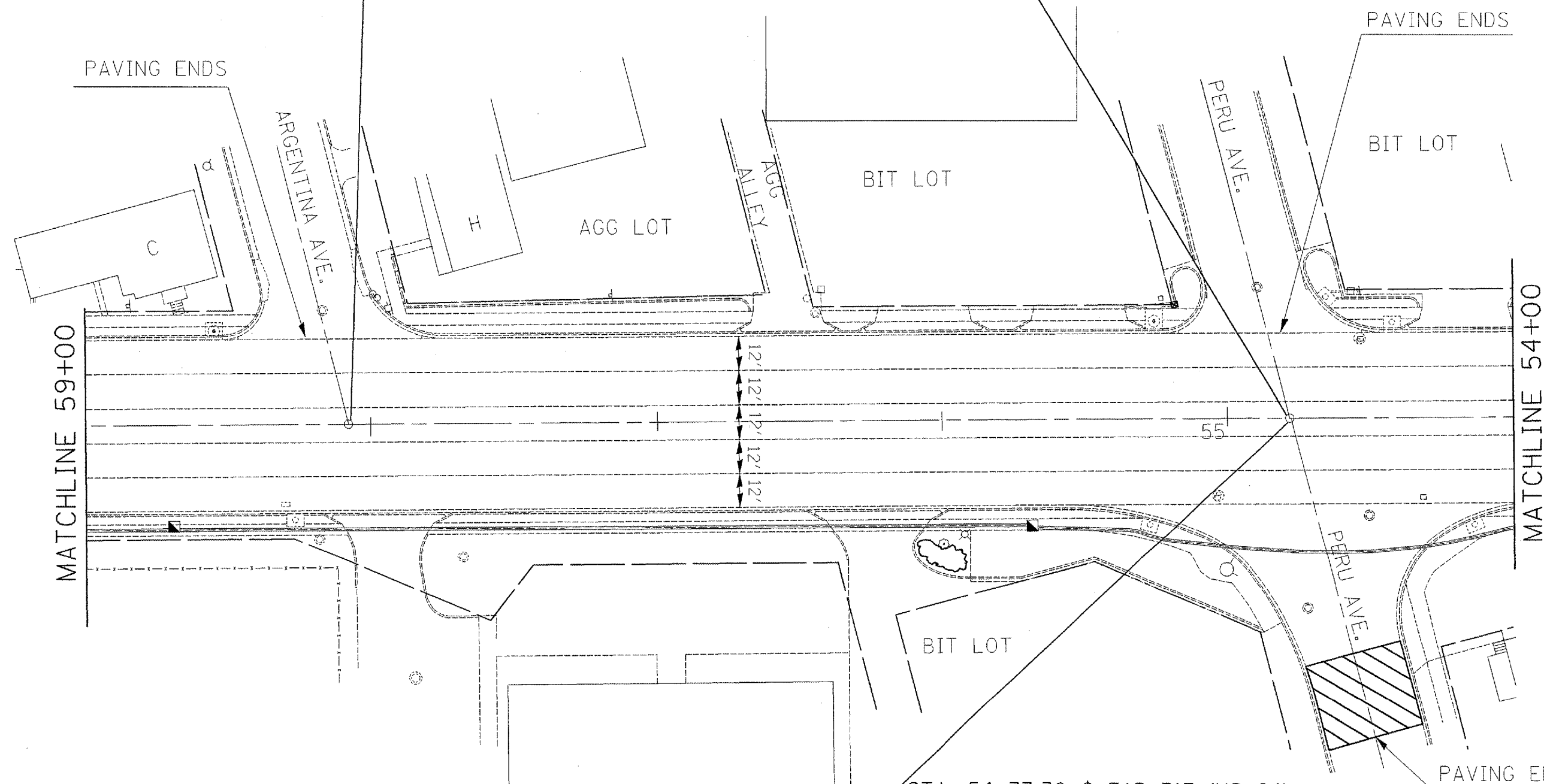

REMOVAL LEGEND

- BUTT JOINT
- CCC&G

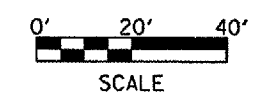
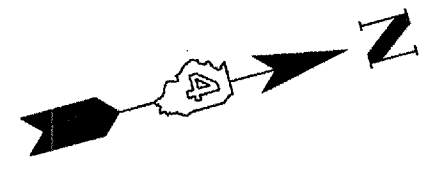

REVISIONS	
NAME	DATE

ILLINOIS DEPARTMENT OF TRANSPORTATION
**EXISTING
PLAN SHEETS**
STA 59+00 - 54+00

SCALE: VERT. _____
HORIZ. _____

DATE _____ DRAWN BY _____
CHECKED BY _____

PLOT DATE = 5/3/2007
 FILE NAME = a:\projects\146-1\rs-7\plan\sheet23.dgn
 PLOT SCALE = 40.0000 / IN
 USER NAME = gshoverp