

F.A.P. RTE.	SECTION	COUNTY	TOTAL SHEETS	SHEET NO.
317	(46-URS-7)	PEORIA	62	35
STA.		TO STA.		
FED. ROAD DIST. NO.		ILLINOIS FED. AID PROJECT		

BENCHMARK #2  
 TOP OF ROW MARKER @  
 SW CORNER OF PERU ST.  
 ELEV. 470.57

STA. 58+07.92 FAP 317 (US 24) =  
 CL ARGENTINA ST.

STA. 54+77.70 CL FAP 317 (US 24) =  
 CL WEST PERU ST.

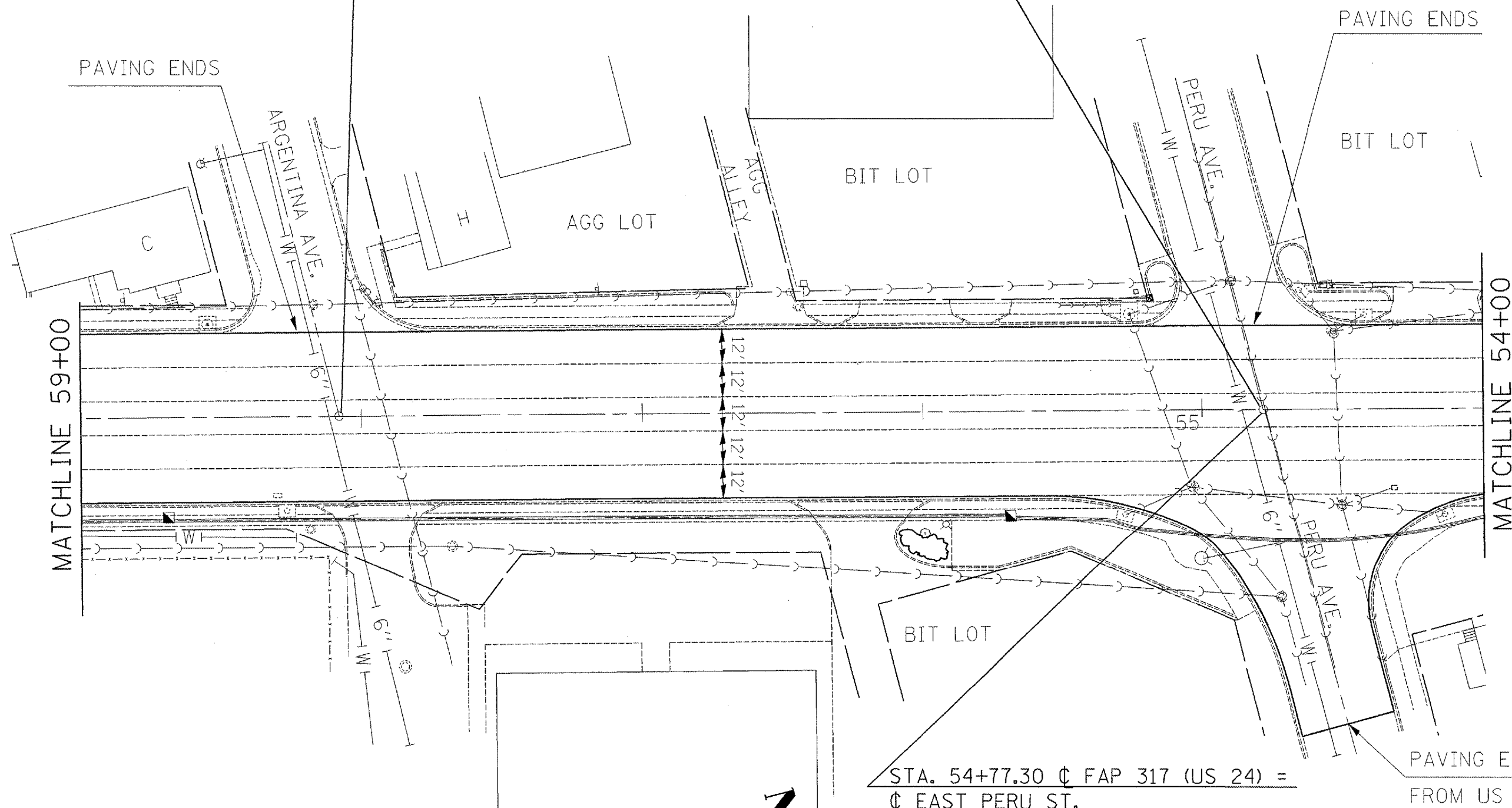

PLOT DATE = 10/3/2007  
 FILE NAME = c:\p\proj\p004\us24bar\plan\sheeta.dgn  
 PLOT SCALE = 1/8"=20' / IN.  
 USER NAME = cnsveerpj

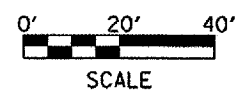
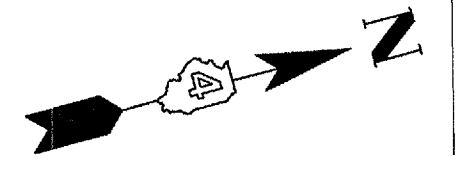

REVISIONS	
NAME	DATE

ILLINOIS DEPARTMENT OF TRANSPORTATION  
**PROPOSED**  
**PLAN SHEETS**  
**STA 59+00 - 54+00**

SCALE: VERT. \_\_\_\_\_  
 HORIZ. \_\_\_\_\_

DATE \_\_\_\_\_

DRAWN BY \_\_\_\_\_  
 CHECKED BY \_\_\_\_\_