

F.A.P. RTE.	SECTION	COUNTY	TOTAL SHEETS	SHEET NO.
317	146-1/RS-7	PEORIA	62	41
STA.		TO STA.		
FED. ROAD DIST. NO.	ILLINOIS	FED. AID PROJECT		

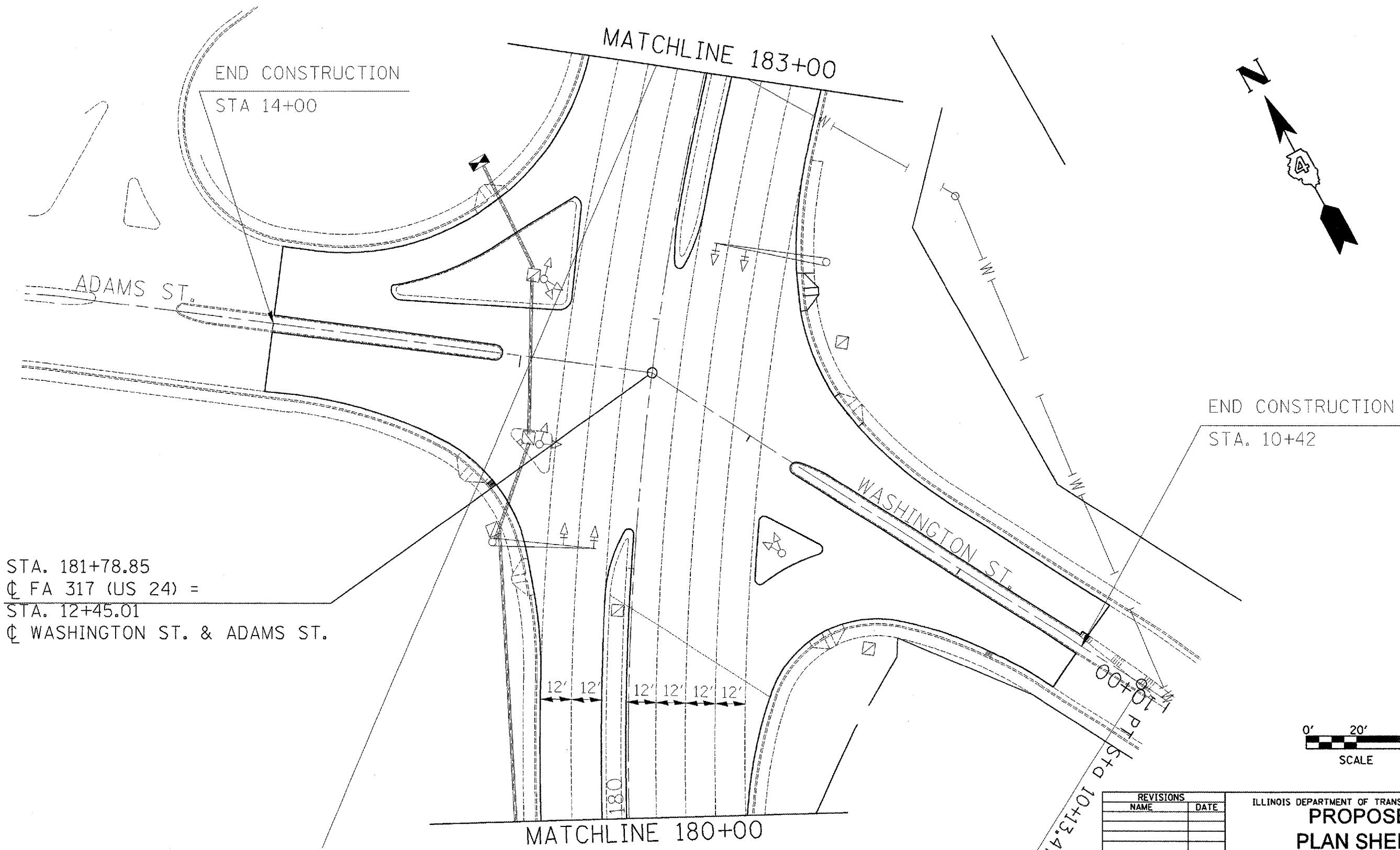

STA. 181+78.85  
 C FA 317 (US 24) =  
 STA. 12+45.01  
 C WASHINGTON ST. & ADAMS ST.

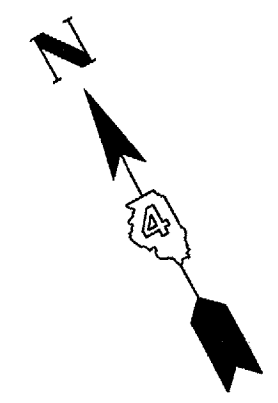
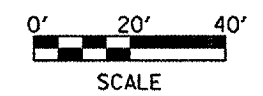

REVISIONS	
NAME	DATE

ILLINOIS DEPARTMENT OF TRANSPORTATION  
**PROPOSED**  
**PLAN SHEETS**  
**STA 180+00 - 183+00**

SCALE: VERT. \_\_\_\_\_  
 HORIZ. \_\_\_\_\_

DRAWN BY \_\_\_\_\_  
 CHECKED BY \_\_\_\_\_

PLOT DATE = 10/3/2007  
 FILE NAME = c:\p\proj\peoria\146-1\rs-7\plan\sheet41.dgn  
 PLOT SCALE = 48.0000 / IN.  
 USER NAME = cconoverpj