

F.A.P. RTE.	SECTION	COUNTY	TOTAL SHEETS	SHEET NO.
317	(46-1RS-7	PEORIA	62	60
STA.		TO STA.		
FED. ROAD DIST. NO.		ILLINOIS FED. AID PROJECT		

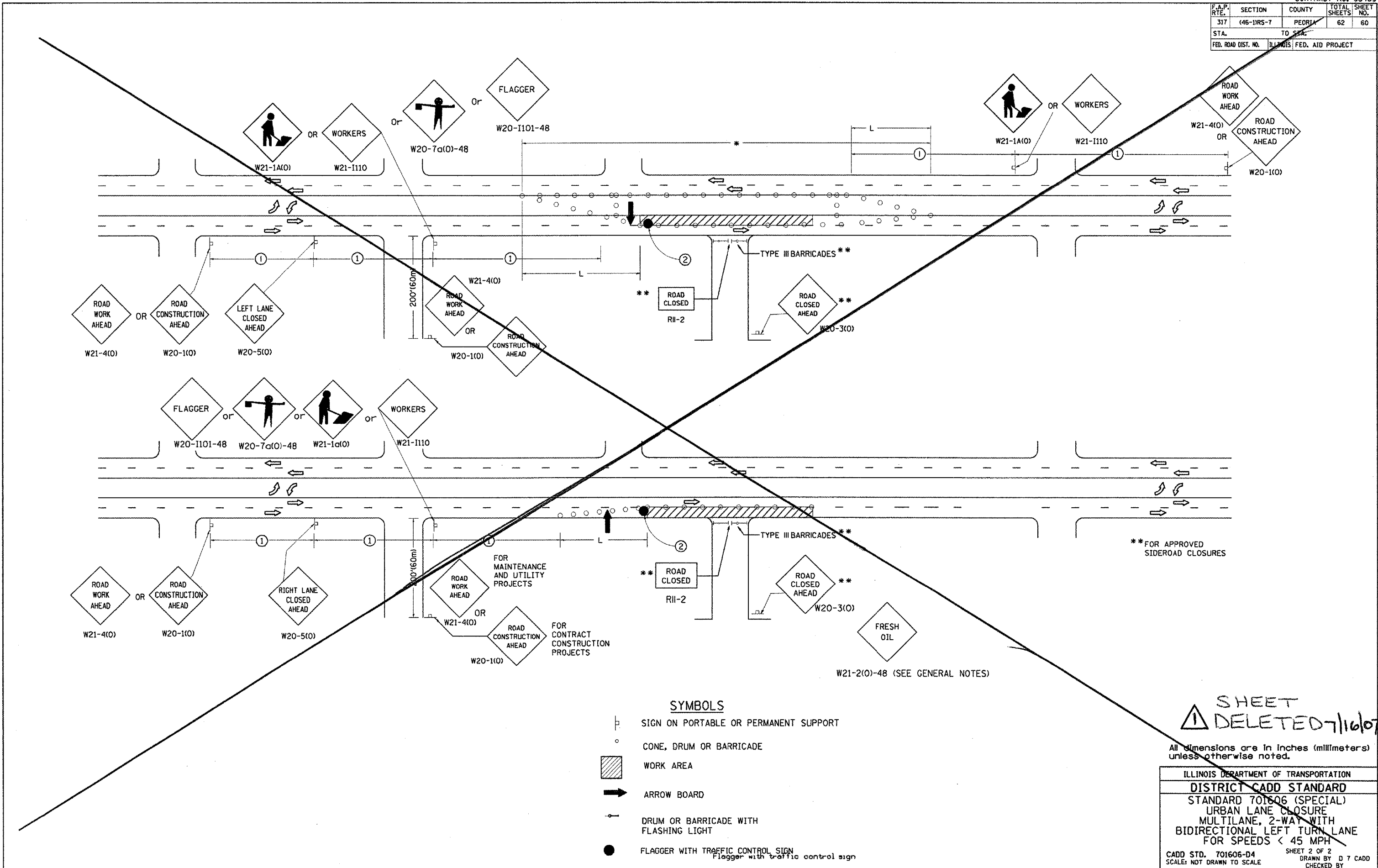

**FOR APPROVED SIDEROAD CLOSURES

W21-2(0)-48 (SEE GENERAL NOTES)

SYMBOLS

- SIGN ON PORTABLE OR PERMANENT SUPPORT
- CONE, DRUM OR BARRICADE
- WORK AREA
- ARROW BOARD
- DRUM OR BARRICADE WITH FLASHING LIGHT
- FLAGGER WITH TRAFFIC CONTROL SIGN
Flagger with traffic control sign

SHEET DELETED 7/16/07

All dimensions are in inches (millimeters) unless otherwise noted.

ILLINOIS DEPARTMENT OF TRANSPORTATION
DISTRICT CADD STANDARD
 STANDARD 701606 (SPECIAL)
 URBAN LANE CLOSURE
 MULTILANE, 2-WAY WITH
 BIDIRECTIONAL LEFT TURN LANE
 FOR SPEEDS < 45 MPH
 CADD STD. 701606-D4 SHEET 2 OF 2
 SCALE: NOT DRAWN TO SCALE DRAWN BY D 7 CADD
 CHECKED BY

\$\$\$DATE\$\$\$

DGN-ONLY