

F.A.P. RTE.	SECTION	COUNTY	TOTAL SHEETS	SHEET NO.
310	(102B)I	MERCER	11	1

+1  
12

D-94-003-08

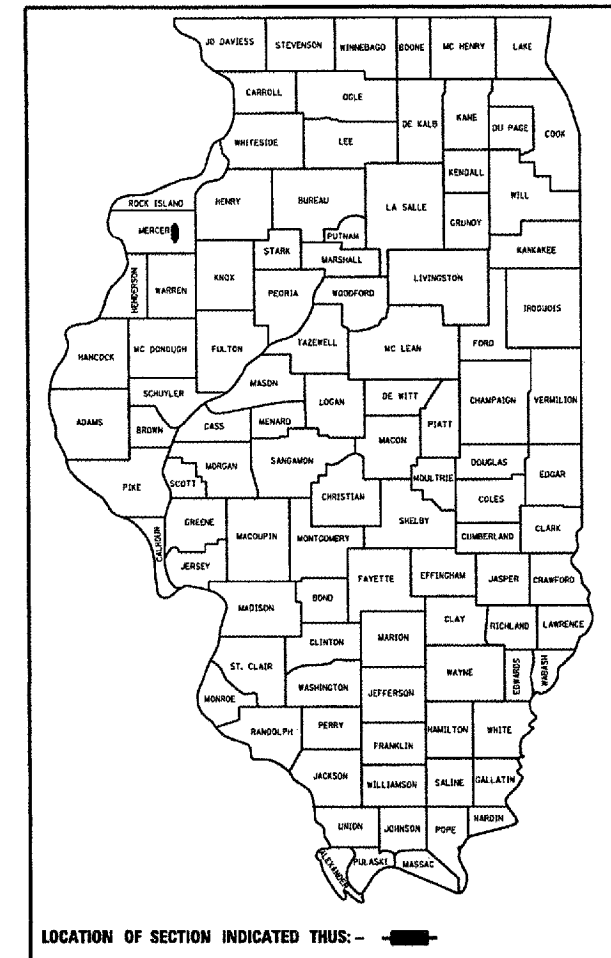

STATE OF ILLINOIS  
DEPARTMENT OF TRANSPORTATION  
DIVISION OF HIGHWAYS

**PROPOSED  
HIGHWAY PLANS**

FAP 310 (US 67)  
SECTION (102B)I  
MERCER COUNTY  
C-94-003-08

**INDEX OF SHEETS:**

1. COVER SHEET
2. GENERAL NOTES
3. SUMMARY OF QUANTITIES
4. TYPICAL SECTIONS
5. SCHEDULE OF QUANTITIES
- 6-7. PLAT SHEETS
8. GENERAL LAYOUT
9. TRAFFIC CONTROL
- 10-11. GENERAL PLAN & ELEVATION BEAM DETAILS

**STANDARDS:**

- 701001-01      701901
- 701006-02
- 701201-02

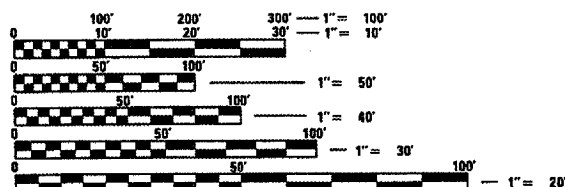

FULL SIZE PLANS HAVE BEEN PREPARED USING STANDARD ENGINEERING SCALES. REDUCED SIZED PLANS WILL NOT CONFORM TO STANDARD SCALES. IN MAKING MEASUREMENTS ON REDUCED PLANS, THE ABOVE SCALES MAY BE USED.

J.U.L.I.E.  
JOINT UTILITY LOCATION INFORMATION FOR EXCAVATION  
1-800-892-0123

SN.066-0004

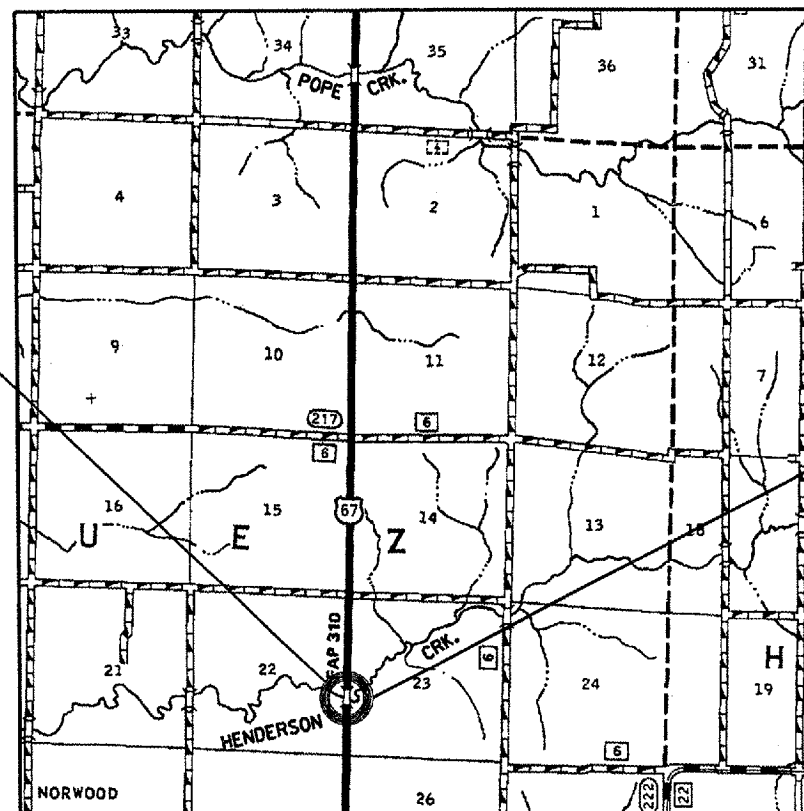

LOCATION MAP

PROJECT CONSISTS OF BEAM BRACING OF FIVE PPC BEAMS ON STRUCTURE (SN.066-0004) CARRYING US67 OVER HENDERSON CREEK, 6.7 MILES SOUTH OF VIOLA.

STATE OF ILLINOIS  
DEPARTMENT OF TRANSPORTATION  
DIVISION OF HIGHWAYS

SUBMITTED *DEC 16 20 09*

*[Signature]*  
DEPUTY DIRECTOR OF HIGHWAYS, REGION ENGINEER

*February 1, 2008*  
*Eric E. Harn*  
ENGINEER OF DESIGN AND ENVIRONMENT

*February 1, 2008*  
*Christine M. Reed*  
DIRECTOR OF HIGHWAYS, CHIEF ENGINEER

**PRINTED BY THE AUTHORITY  
OF THE STATE OF ILLINOIS**

DESIGNER: CLARK JONES  
PHONE: (309)671-3452

PROJECT ENGINEER: JIM MILLER  
PHONE: (309)671-3451