

F.A.S. RTE.	SECTION	COUNTY	TOTAL SHEETS	SHEET NO.
1517	08PPP	DEWITT	11	1

STATE OF ILLINOIS
 DEPARTMENT OF TRANSPORTATION
 DIVISION OF HIGHWAYS
**PROPOSED
 HIGHWAY PLANS**

FOR INDEX OF SHEETS, SEE SHEET NO. 2
 FOR SUMMARY OF QUANTITIES, SEE SHEET NO. 4

FAS ROUTE 1517 (US 150)
 SECTION 08PPP
 DEWITT COUNTY

C-95-053-07
 MICROSURFACING US 150 IN DEWITT COUNTY FROM
 MCLEAN COUNTY LINE TO PIATT COUNTY LINE



PROJECT ENGINEER: KEVIN TRAPP
 SQUAD LEADER: MICHAEL LEROY
 DESIGNER: MICHAEL LEROY

CURRENT ADT
 F. A. S. 1517 (US 150)
 CURRENT ADT (2007) 18,400

DESIGN DESIGNATION
 FUNCTIONAL CLASSIFICATION
 OTHER PRINCIPAL ARTERIAL

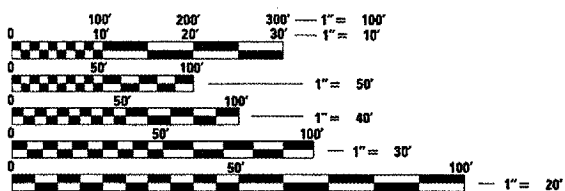

FULL SIZE PLANS HAVE BEEN PREPARED USING STANDARD ENGINEERING SCALES. REDUCED SIZED PLANS WILL NOT CONFORM TO STANDARD SCALES. IN MAKING MEASUREMENTS ON REDUCED PLANS, THE ABOVE SCALES MAY BE USED.

J.U.L.I.E.
 JOINT UTILITY LOCATION INFORMATION FOR EXCAVATION
 1-800-892-0123

CONTRACT NO. 70673

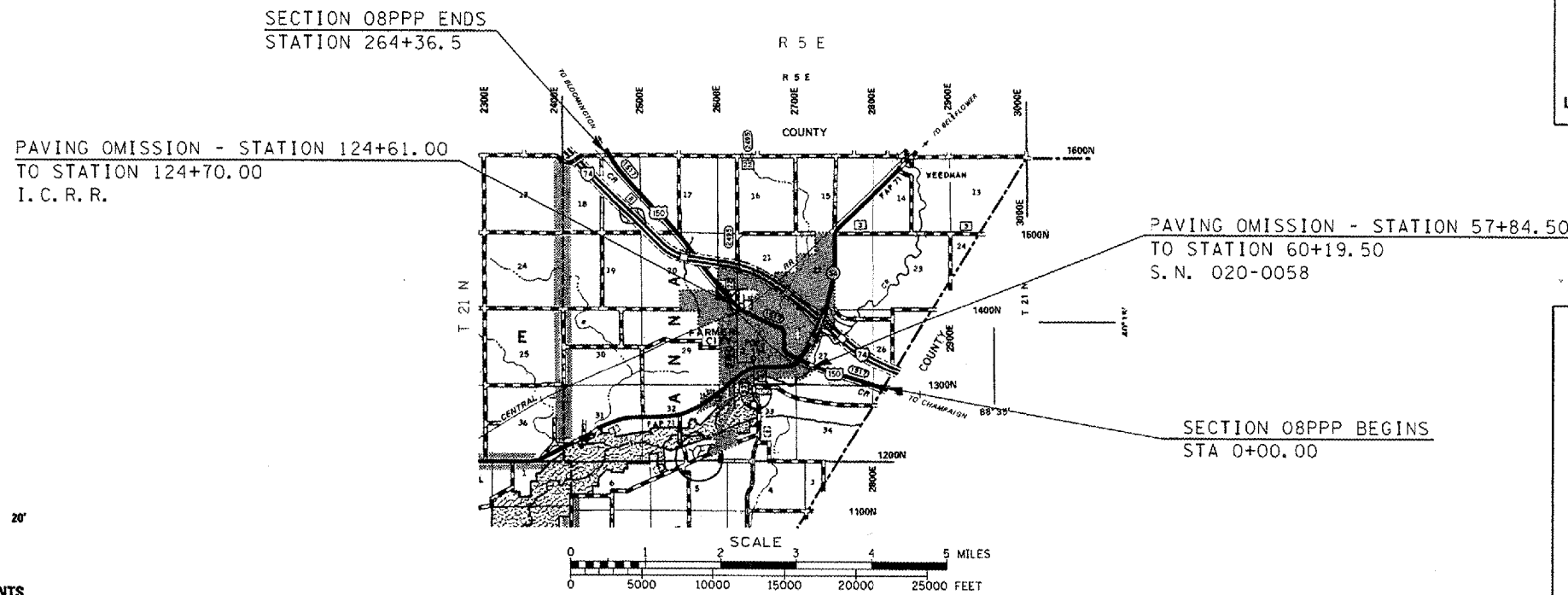

TOTAL LENGTH OF SECTION & PROJECT = 26,436.50 FEET = 5.001 MILES
 NET LENGTH OF SECTION & PROJECT = 25,614.50 FEET = 4.851 MILES

STATE OF ILLINOIS
 DEPARTMENT OF TRANSPORTATION
 DIVISION OF HIGHWAYS

SUBMITTED 10/17/2007

Joseph E. Dowse
 DEPUTY DIRECTOR OF HIGHWAYS, REGION THREE ENGINEER

February 1, 2008
Eric E. Harn
 INTERIM ENGINEER OF DESIGN AND ENVIRONMENT

February 1, 2008
Christine M. Reed
 DIRECTOR OF HIGHWAYS, CHIEF ENGINEER

**PRINTED BY THE AUTHORITY
 OF THE STATE OF ILLINOIS**

F.A.S. RTE.	SECTION	COUNTY	TOTAL SHEETS	SHEET NO.
1517	08PPP	DEWITT	11	2

INDEX OF SHEETS

INDEX OF SHEETS

SHEET NO.	DESCRIPTION
1	COVER SHEET
2	INDEX OF SHEETS/LIST OF HIGHWAY STANDARDS
3	GENERAL NOTES
4	SUMMARY OF QUANTITIES
5	EXISTING TYPICAL CROSS-SECTIONS
5	PROPOSED TYPICAL CROSS-SECTIONS
6	SCHEDULE OF QUANTITIES
7	DETAIL - PERMANENT SURVEY MARKERS TO BE PRESERVED
8-11	DETAIL - TYPICAL APPLICATIONS OF PAVEMENT MARKINGS & MARKERS (URBAN AND RURAL)

LIST OF STANDARDS

LIST OF HIGHWAY STANDARDS

STANDARD NO.	DESCRIPTION
001006	DECIMAL OF AN INCH AND A FOOT
701301-02	LANE CLOSURE, 2L, 2W SHORT TIME OPERATIONS
701306-01	LANE CLOSURE, 2L, 2W SLOW MOVING OPERATIONS DAY ONLY, FOR SPEEDS \geq 45 MPH
701311-02	LANE CLOSURE, 2L, 2W MOVING OPERATIONS - DAY ONLY
701901	TRAFFIC CONTROL DEVICES
780001-01	TYPICAL PAVEMENT MARKINGS
781001-02	TYPICAL APPLICATIONS RAISED REFLECTIVE PAVEMENT MARKERS

PLOT DATE : 08/27/2007
 FILE NAME : c:\projects\70673\dwg\1517\08PPP\1517.dwg
 PLOT SCALE : 42.3581 / IN.
 USER NAME : collierb

ILLINOIS DEPARTMENT OF TRANSPORTATION
**INDEX OF SHEETS &
 LIST OF STANDARDS**
 F.A.S. 1517 (U.S. 150)
 SECTION 08PPP
 CHAMPAIGN COUNTY
 SCALE: N/A
 DATE: 08/28/07
 DRAWN BY: RC
 CHECKED BY: MAL

F.A.S. RTE.	SECTION	COUNTY	TOTAL SHEETS	SHEET NO.
1517	08PPP	DEWITT	11	3

GENERAL NOTES

G.N.-100
 ENGLISH UNITS OF MEASUREMENT SHALL GOVERN OVER AND SUPERSEDE ANY METRIC UNITS SHOWN IN THIS CONTRACT. WHERE INCLUDED, METRIC UNITS ARE FOR INFORMATION ONLY

G.N.-1004.01
 COARSE AGGREGATE GRADATION CA-10 MAY BE USED WHENEVER COARSE AGGREGATE CA-6 IS SPECIFIED IN THE STANDARD SPECIFICATIONS.

G.N.-107.12
 THE NAME, ADDRESS AND TELEPHONE NUMBER OF THE LOCAL RAILROAD CONTACT IS:

Mr. Hardy Taylor
 1907 Marion Ave
 Mattoon, IL 61938
 (217) 238-2443

SPECIAL ATTENTION IS CALLED TO ARTICLE 107.12 REGARDING RAILROAD FLAGGERS. THE NAME, ADDRESS AND TELEPHONE NUMBER OF THE RAILROAD CONTACT PERSON FOR FLAGGERS IS:

Mr. Tom Tucker
 2800 Livemois Rd
 Troy, MI 48083
 (248) 740-6227

G.N. - 451 (SPECIAL)
 CRACK FILLING CONSISTS OF BOTH LONGITUDINAL AND TRANSVERSE CRACKS. AN APPLICATION RATE OF 0.40 LBS/FT WAS USED TO DETERMINE THE FIBER ASPHALT QUANTITY.

G.N.-667
 THE RESIDENT ENGINEER SHALL CONTACT THE PROGRAM DEVELOPMENT CHIEF OF SURVEYS PRIOR TO THE PRE-CONSTRUCTION CONFERENCE FOR INSTRUCTION AS TO SETTING OF TEMPORARY OR PERMANENT TIES FOR CENTERLINE ALIGNMENT CONTROL SURVEY MARKERS (PC'S, PT'S, AND PI'S). PROJECT IMPLEMENTATION PERSONNEL WILL BE RESPONSIBLE FOR SETTING THESE MARKERS.

G.N.-703A
 SHORT TERM PAVEMENT MARKING SHALL BE APPLIED TO THE PAVEMENT AFTER ANY OF THE FOLLOWING: COLD MILLING AND/OR PLACING BITUMINOUS MATERIALS (PRIME COAT), LEVELING BINDER (MACHINE METHOD), BINDER AND SURFACE COURSES. SHORT TERM PAVEMENT MARKING PLACED ON THE SURFACE, SHALL COINCIDE WITH THE FINAL PAVEMENT STRIPING. SHORT TERM PAVEMENT MARKING PLACED PRIOR TO THE SURFACE SHALL COINCIDE WITH THE EXISTING PAVEMENT MARKINGS. USE 4 FEET PER 40 FEET (OR 10% PER STATION).

G.N.-781
 RAISED REFLECTIVE PAVEMENT MARKERS SHALL BE PLACED IN ACCORDANCE WITH STANDARD 781001, AND THE DETAILS SHOWN IN THE PLANS. IF THERE IS ANY DISCREPENCY BETWEEN THE STANDARD AND THE DETAILS IN THE PLANS, THE DETAILS IN THE PLANS SHALL GOVERN. THE FINAL PAVEMENT MARKINGS SHALL BE IN PLACE PRIOR TO PLACING THE RAISED REFLECTIVE PAVEMENT MARKERS AND THE RAISED REFLECTIVE PAVEMENT MARKERS SHALL BE PLACED MIDWAY IN THE 30 FOOT (9 m) SPACE BETWEEN THE DASHED CENTERLINE STRIPES (WHEN APPLICABLE).

G.N. (SPECIAL)
 THE CONTRACTOR SHALL DEVISE AND SUBMIT A JOINT PLAN THAT MEETS THE APPROVAL OF THE ENGINEER.

NO COMMITMENTS

PLOT DATE : 10/17/2007
 FILE NAME : c:\p\projects\2006\08\1517\08PPP\gennotes.dgn
 PLOT SCALE : 42.3529 / IN.
 USER NAME : gaulters

ILLINOIS DEPARTMENT OF TRANSPORTATION	
GENERAL NOTES	
F.A.S. 1517 (U.S. 150)	
SECTION 08PPP	
CHAMPAIGN COUNTY	
SCALE: N/A	DRAWN BY: RC
DATE: 08/28/07	CHECKED BY: MAL

F.A.S. RTE.	SECTION	COUNTY	TOTAL SHEETS	SHEET NO.
1517	08PPP	DEWITT	11	4

SUMMARY OF QUANTITIES

LOCATION:

RURAL
DEWITT

FAS 1517 (US 150)
STA. 0+00 TO
STA. 264+36.5

100% STATE

CONSTRUCTION CODE:

1000

PAY ITEM CODE	PAY ITEM	UNIT	QTY
40600100	BITUMINOUS MATERIALS (PRIME COAT)	GALLON	7,567.0
40600300	AGGREGATE (PRIME COAT)	TON	162.0
48101200	AGGREGATE SHOULDERS, TYPE B	TON	882.0
67100100	MOBILIZATION	L SUM	1.0
70100460	TRAFFIC CONTROL AND PROTECTION, STANDARD 701306	L SUM	1.0
70300100	SHORT-TERM PAVEMENT MARKING	FOOT	5,132.0
70301000	WORK ZONE PAVEMENT MARKING REMOVAL	SQ FT	855.0
* 78000100	THERMOPLASTIC PAVEMENT MARKING - LETTERS AND SYMBOLS	SQ FT	123.0
* 78001110	PAINT PAVEMENT MARKING - LINE 4"	FOOT	60,916.0
* 78001180	PAINT PAVEMENT MARKING - LINE 24"	FOOT	106.0
* 78100100	RAISED REFLECTIVE PAVEMENT MARKER	EACH	333.0
78300200	RAISED REFLECTIVE PAVEMENT MARKER REMOVAL	EACH	333.0
X0325223	FIBER ASPHALT	POUND	11,040.0
X4480205	MICRO-SURFACING, 2 PASSES, TYPE 2	SQ YD	75,666.0
Z0048665	RAILROAD PROTECTIVE LIABILITY INSURANCE	L SUM	1.0

* SPECIALTY ITEMS

PLOT DATE : 12/13/2007
 FILE NAME : c:\pwworkspace\jess5287\csh\70673\quant.dgn
 USER : jess5287
 USER NAME : jess5287

ILLINOIS DEPARTMENT OF TRANSPORTATION

SUMMARY OF QUANTITIES

F.A.S. 1517 (U.S. 150)
SECTION 08PPP
CHAMPAIGN COUNTY

SCALE: N/A
DATE: 08/28/07

DRAWN BY: RC
CHECKED BY: MAL

F.A.S. RTE.	SECTION	COUNTY	TOTAL SHEETS	SHEET NO.
1517	08PPP	DEWITT	11	5

SCHEDULE OF QUANTITIES

**PERMANENT SURVEY MARKERS
TO BE PRESERVED
(COST INCIDENTAL TO CONTRACT)**

CL. STA.	EACH
171+03.831	1
192+84.80	1
TOTAL =	2 EACH

**PAINT PAVEMENT MARKINGS LINE 24"
(78001180)**

RAILROAD CROSSING:

LT. 124+50 ~ (1' - 11') RT. = 36 FT
 RT. 124+85 ~ (1' - 11') RT. = 36 FT

IL 105/IL 54 INTERSECTION:

LT. 69+50 = 17 FT
 RT. 68+75 = 17 FT

TOTAL= 106 FT

PAVEMENT MARKINGS

STATION	TO STATION	4"	4"	4"	SHORT TERM	WORK ZONE
		SKIP DASH YELLOW (FOOT) (78001110)	NO PASSING YELLOW (FOOT) (78001110)	EDGE LINE WHITE (FOOT) (78001110)	PAVEMENT MARKINGS (FOOT) (70300100)	PAVEMENT MARKING REMOVAL (SQ.FT.) (70301000)
0+00	55+50	1,398	0	11,100	1,110	185
55+50	62+54	0	0	0	0	0
62+54	68+75	165	0	1,242	124	21
68+75	69+50	29	0	150	0	0
69+50	77+50	210	0	1,600	160	27
77+50	82+50	0	1,000	1,000	100	17
82+50	97+50	385	0	3,000	300	50
97+50	107+50	260	2,000	2,000	200	33
107+50	124+50	435	0	3,400	340	57
124+50	124+85	0	70	70	7	1
124+85	264+37	3,498	0	27,904	2,790	465
SUB-TOTAL		6,380	3,070	51,466	5,132	855
TOTAL 4"		60,916				

**THERMOPLASTIC PAVEMENT MARKINGS LETTERS & SYMBOLS
(78000100)**

STA. RT. '122+29 ~ RT. 122+59 (1.5 ~ 9.5' RT.) = X = 54.0 SQ FT
 STA. RT. '122+40 ~ RT. 122+50 = R = 3.6 SQ FT
 STA. RT. '122+40 ~ RT. 122+50 = R = 3.6 SQ FT
 STA. LT. '122+97 ~ LT. 122+70 (1.5 ~ 9.5' LT.) = X = 54.0 SQ FT
 STA. LT. '122+72 ~ 122+87 = R = 3.6 SQ FT
 STA. LT. '122+72 ~ 122+87 = R = 3.6 SQ FT
TOTAL= 123.0 SQ.FT.

**RAISED REFLECTIVE PAVEMENT MARKER
(78100100)**

STATION TO STATION	EACH
0+00 264+36.5	333

**RAISED REFLECTIVE PAVEMENT MARKER REMOVAL
(78300200)**

STATION TO STATION	EACH
0+00 264+36.5	333

PLOT DATE: 18/17/2007
 FILE NAME: c:\projects\70673\quant\lqgn
 PLOT SCALE: 42.3529 / IN.
 USER NAME: callierb

SCHEDULE OF QUANTITIES

CONTRACT NO. 70673				
F.A.S. RTE.	SECTION	COUNTY	TOTAL SHEETS	SHEET NO.
1517	08PPP	DEWITT	11	6

EXISTING ROADWAY CROSS SECTION

STA. 0+00.00 to STA. 264+36.50

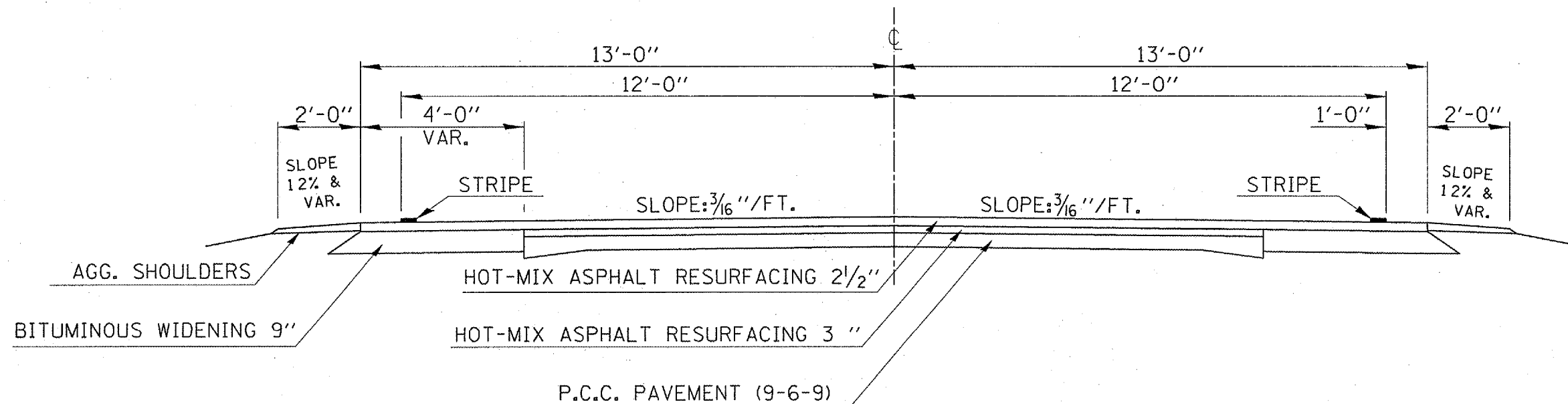

PROPOSED ROADWAY CROSS SECTION

STA. 0+00.00 to STA. 264+36.50

OMISSIONS: STA. 55+50 TO STA. 62+54 (S.N. 020-0058)
STA. 124+61 TO STA. 124+70 (I.C.R.R.)

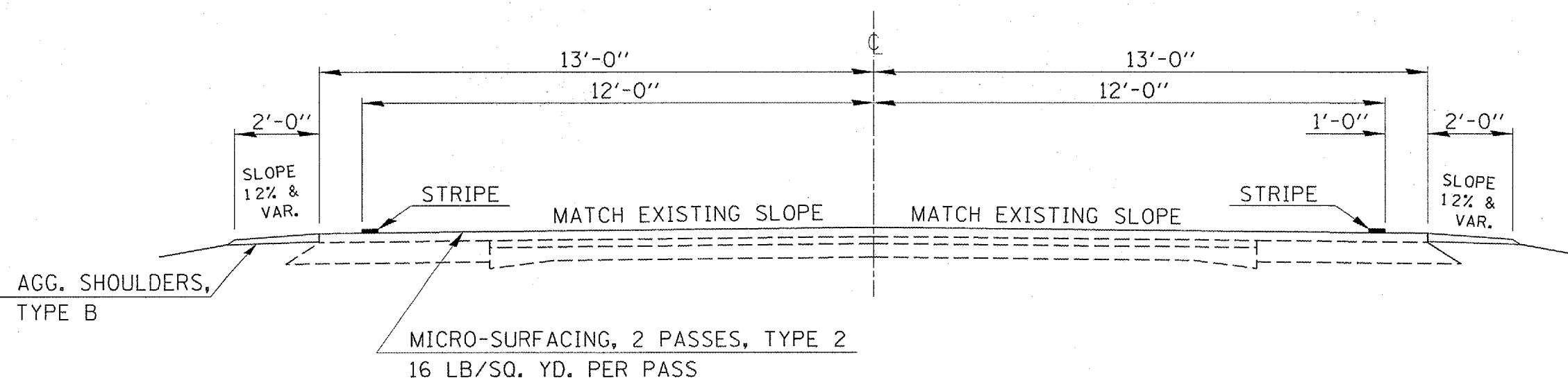

ILLINOIS DEPARTMENT OF TRANSPORTATION

TYPICAL CROSS-SECTIONS

F.A.S. 1517 (U.S. 150)
SECTION 08PPP
CHAMPAIGN COUNTY

SCALE: N/A
DATE: 08/28/07

DRAWN BY: RC
CHECKED BY: MAL

F.A.S. RTE.	SECTION	COUNTY	TOTAL SHEETS	SHEET NO.
1517	08PPP	DEWITT	11	7

CENTERLINE ALIGNMENT TIES

POT #1
STATION 171+03.831

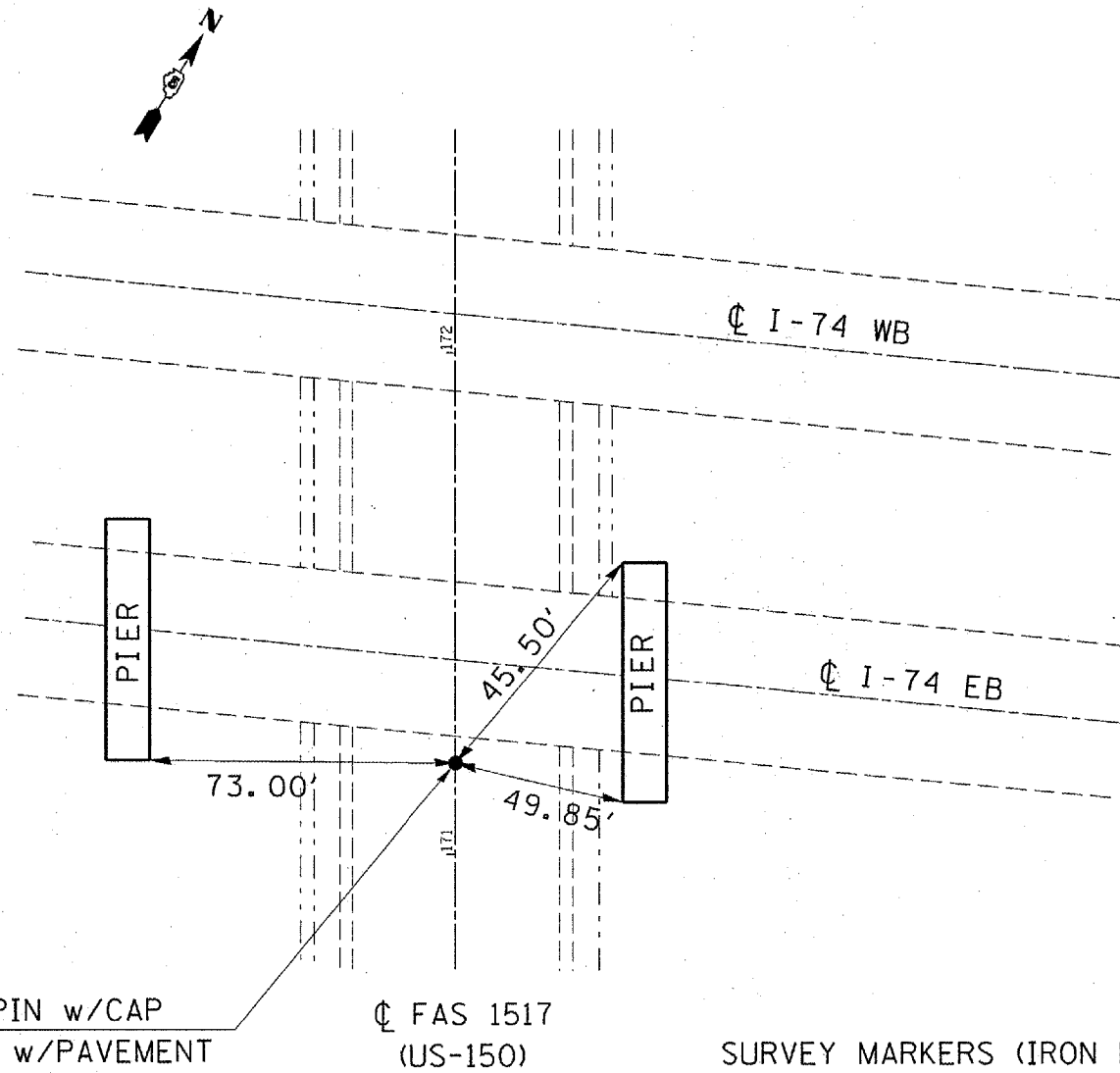

IRON PIN w/CAP
FLUSH w/PAVEMENT

☉ FAS 1517
(US-150)

SURVEY MARKERS (IRON PIN AND CAP) SHALL BE PRESERVED BY COVERING THEM WITH A 2"x2" SQUARE OF SHORT TERM PAVEMENT MARKING TAPE PRIOR TO MICRO-SURFACING. COST SHALL BE INCLUDED WITH OTHER VARIOUS ITEMS IN THE CONTRACT.

SEE SURVEY BOOK 4744 PG. 5-3 NOT TO SCALE

CENTERLINE ALIGNMENT TIES

POT #2
STATION 192+84.80

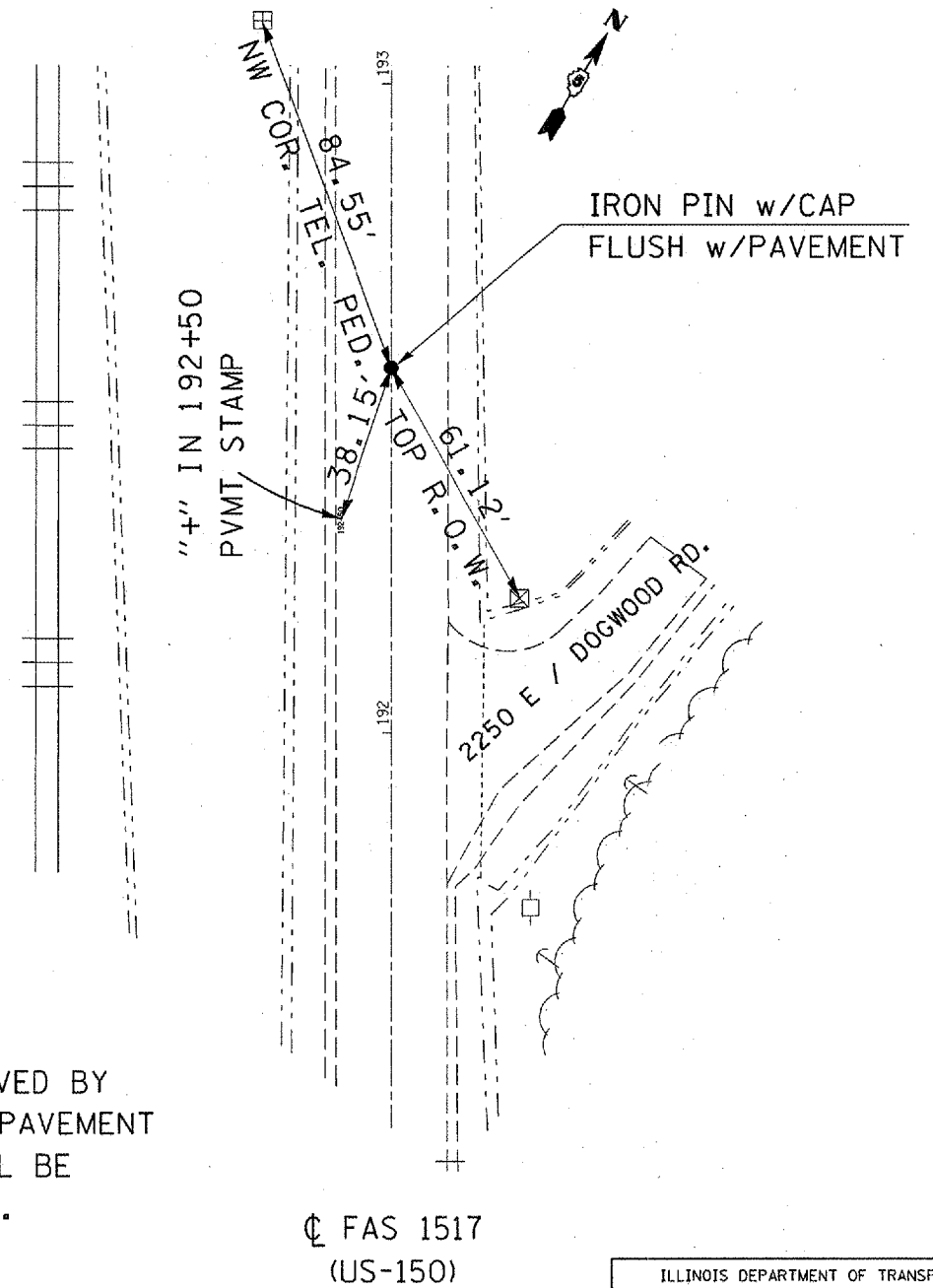

☉ FAS 1517
(US-150)

ILLINOIS DEPARTMENT OF TRANSPORTATION
**SURVEY MARKERS
 TO BE PRESERVED**
 F.A.S. 1517 (U.S. 150)
 SECTION 08PPP
 CHAMPAIGN COUNTY
 SCALE: N/A
 DATE: 08/28/07
 DRAWN BY: RC
 CHECKED BY: MAL

SEE SURVEY BOOK 4744 PG. 5-3 NOT TO SCALE

PLOT DATE : 10/17/2007
FILE NAME : c:\projects\1517\1517\1517.dwg
PLOT SCALE : 42.3295' / IN.
USER NAME : callie-b

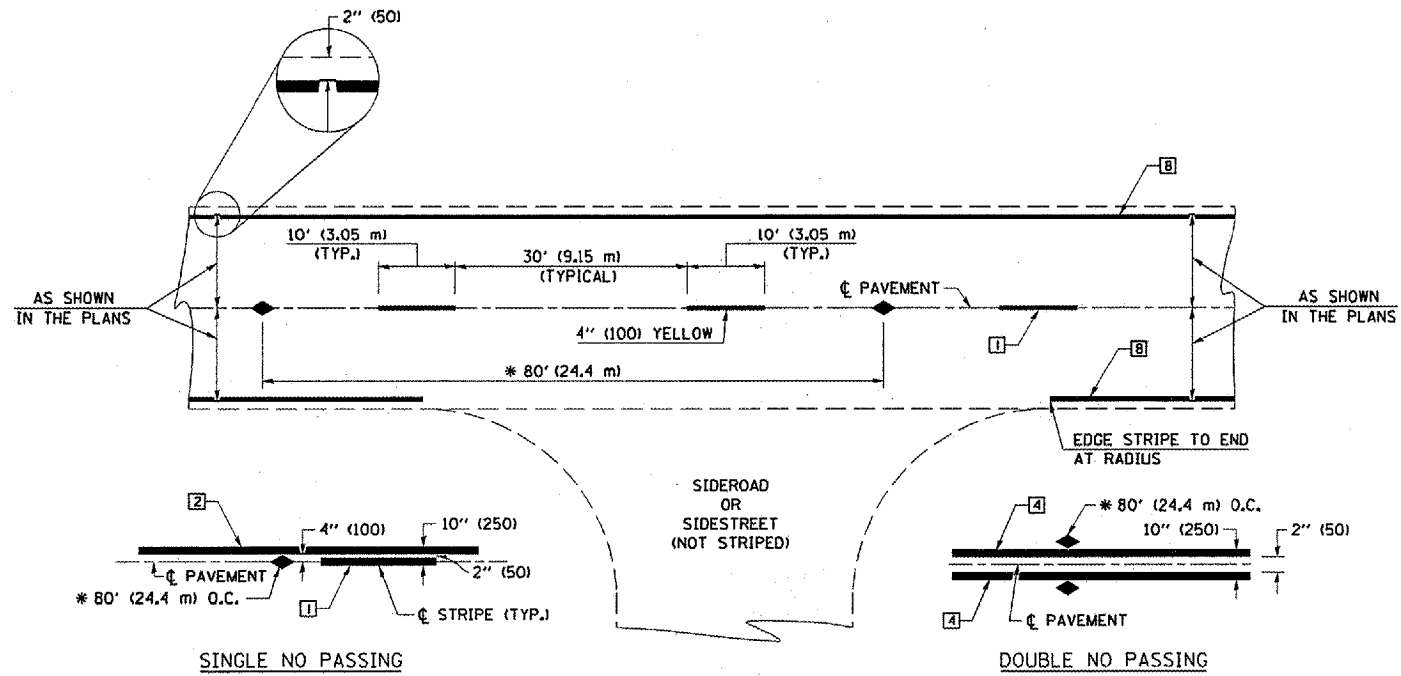

* REDUCE TO 40' (12.2 m) O.C. ON CURVES WITH POSTED OR ADVISORY SPEEDS OF 45 mph (70 km/h) OR LESS.

TWO LANE/TWO WAY

TYPICAL PAVEMENT MARKING LEGEND

- 1 4" (100) SKIP-DASH (YELLOW)
- 2 4" (100) SOLID (YELLOW)
- 3 12" (300) DIAGONAL (YELLOW)
- 4 4" (100) DOUBLE YELLOW (NARROW)
- 5 RESERVED
- 6 RESERVED
- 7 4" (100) SKIP-DASH (WHITE)
- 8 4" (100) SOLID (WHITE)
- 9 12" (300) DIAGONAL (WHITE)
- 10 6" (150) SOLID (WHITE)
- 11 24" (600) STOP BAR (WHITE)
- 12 8" (200) SOLID (WHITE)
- 13 4" (100) LANE LINE EXTENSIONS (WHITE)
- 14 4" (100) PARKING WHITE

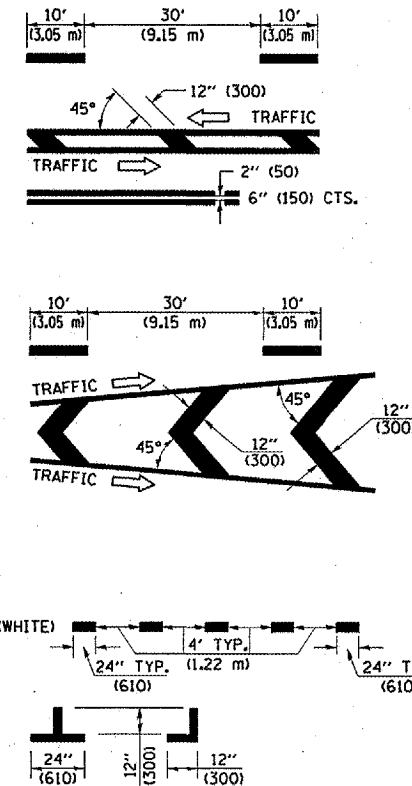

TYPICAL PAVEMENT MARKERS LEGEND

- ◆ TWO-WAY AMBER MARKER
- ▶ ONE-WAY AMBER MARKER
- ▷ ONE-WAY CRYSTAL MARKER

RURAL LEFT TURN

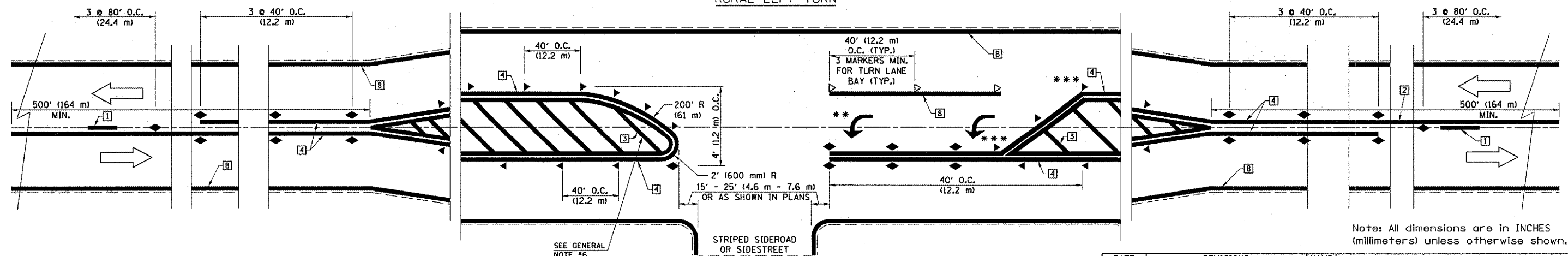

Note: All dimensions are in INCHES (millimeters) unless otherwise shown.

*** REDUCE SPACING IF NECESSARY TO ASSURE MARKERS AT CORNER POINTS.
 ** TURN ARROWS SHALL BE PLACED AS SHOWN ON SHEET *2.

DATE	REVISIONS	NAME
11/06	REPLACED DETAIL F-5.25	TJB

ILLINOIS DEPARTMENT OF TRANSPORTATION
PAVEMENT MARKING AND MARKERS (RURAL & URBAN APPLICATIONS)
DISTRICT 5 DETAIL NO. 7800AAAA

PLOT DATE : 10/17/2007
 FILE NAME : c:\pwworkspace\70673\106170673.dwg
 PLOT SCALE : 42.3025 / IN.
 USER NAME : coltrbrb

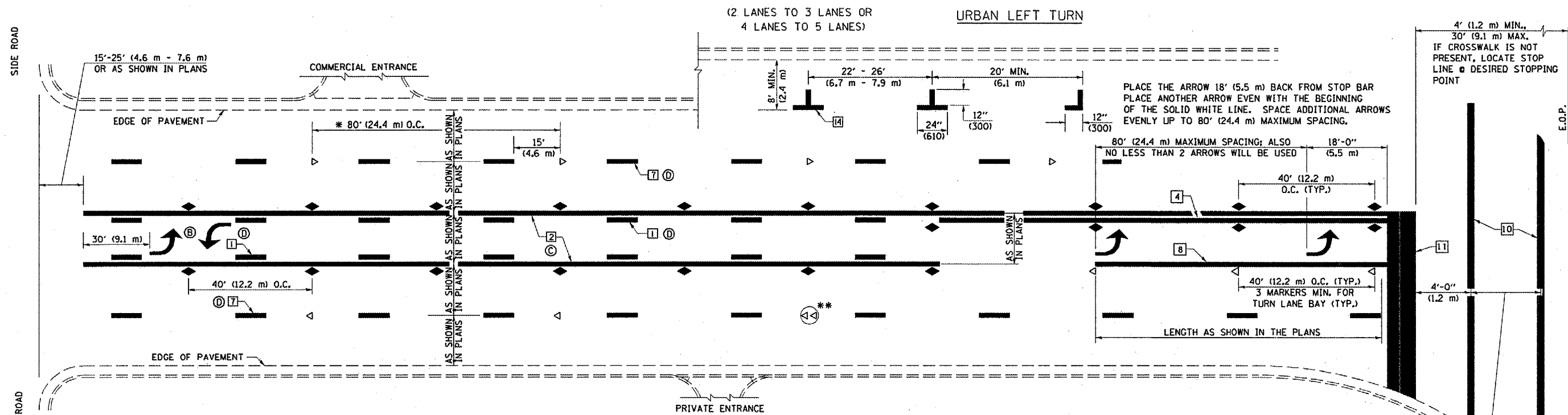

* REDUCE TO 40 FEET (12.2 METERS) ON CENTER ON CURVES WHERE ADVISORY SPEEDS ARE 10 MPH (15 km/h) LOWER THAN POSTED SPEEDS.

** DOUBLE LANE LINE MARKERS SHALL BE SPECIFIED AND SPACED AS SHOWN IN HIGHWAY STANDARD 781001 FOR MULTI-LANE DIVIDED AND UNDIVIDED HIGHWAYS.

GENERAL NOTES:

- (B) TURN ARROW PAIRS SHALL BE PLACED AT 250' (75 m) INTERVALS AND SHALL BE EVENLY SPACED BETWEEN BOTH ENDS OF THE BIDIRECTIONAL LEFT TURN LANE.
- (C) THE SOLID YELLOW PAVEMENT MARKINGS [2] SHOULD GENERALLY START OR END NEAR THE RADIUS POINT OF EACH STREET RETURN EXCEPT WHERE ONE OR BOTH ENDS WOULD INCLUDE STOP BARS.
- (D) THE SKIP-DASH PAVEMENT MARKINGS [1] OR [7] SHOULD BE CENTERED BETWEEN BOTH ENDS OF EACH CITY BLOCK AND SHALL BE PLACED SO THEY LINE UP ACROSS FROM EACH OTHER. SEE EXAMPLE ON SHEET 2 OF 3.
- (E) USE LARGE ARROW SIZE FOR BOTH RURAL AND URBAN LOCATIONS. (SEE LAST PAGE OF SECTION 780x FOR SYMBOLS TABLE)

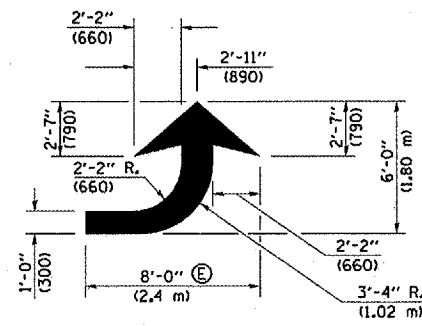

LEFT ARROW

REVERSE FOR RIGHT ARROW
AREA = 15.6 SQ. FT. (1.47 m²)
(WHITE)

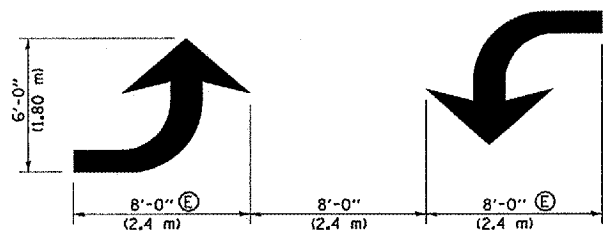

TYPICAL DOUBLE TURN ARROWS (WHITE)

BLOOMINGTON-NORMAL CITY LIMITS ONLY

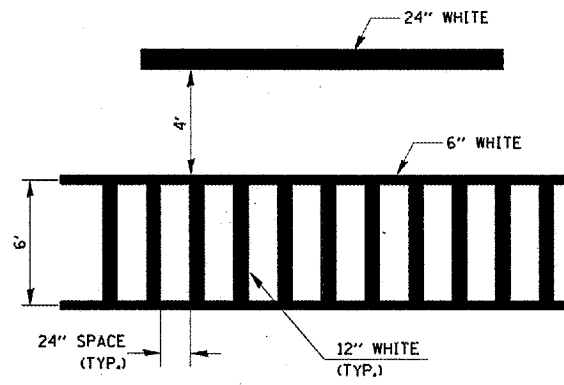

TYPICAL SPACING FOR CROSSWALKS & STOP BARS

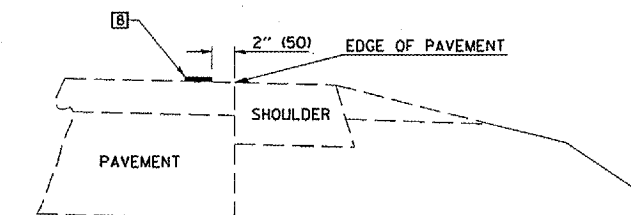

RELATIONSHIP OF EDGE LINE TO EDGE OF PAVEMENT
(SAFETY SHOULDER OR PAVED SURFACE)
SEE ARTICLE 780.04

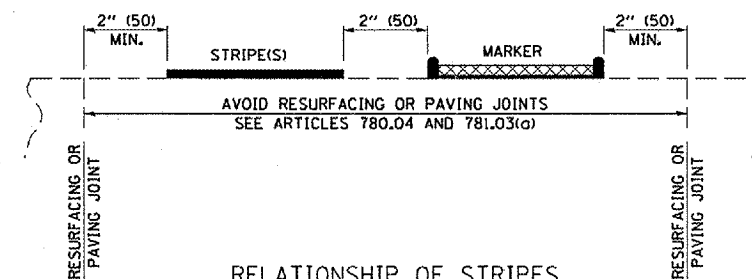

RELATIONSHIP OF STRIPES, MARKERS AND JOINTS

Note: All dimensions are in INCHES (millimeters) unless otherwise shown.

DATE	REVISIONS	NAME	ILLINOIS DEPARTMENT OF TRANSPORTATION
11/06	REPLACED DETAIL F-5.25	TJB	PAVEMENT MARKING AND MARKERS (RURAL & URBAN APPLICATIONS)
			DISTRICT 5 DETAIL NO. 7800AAA

F.A.S. RTE.	SECTION	COUNTY	TOTAL SHEETS	SHEET NO.
1517	08PPP	DEWITT		10

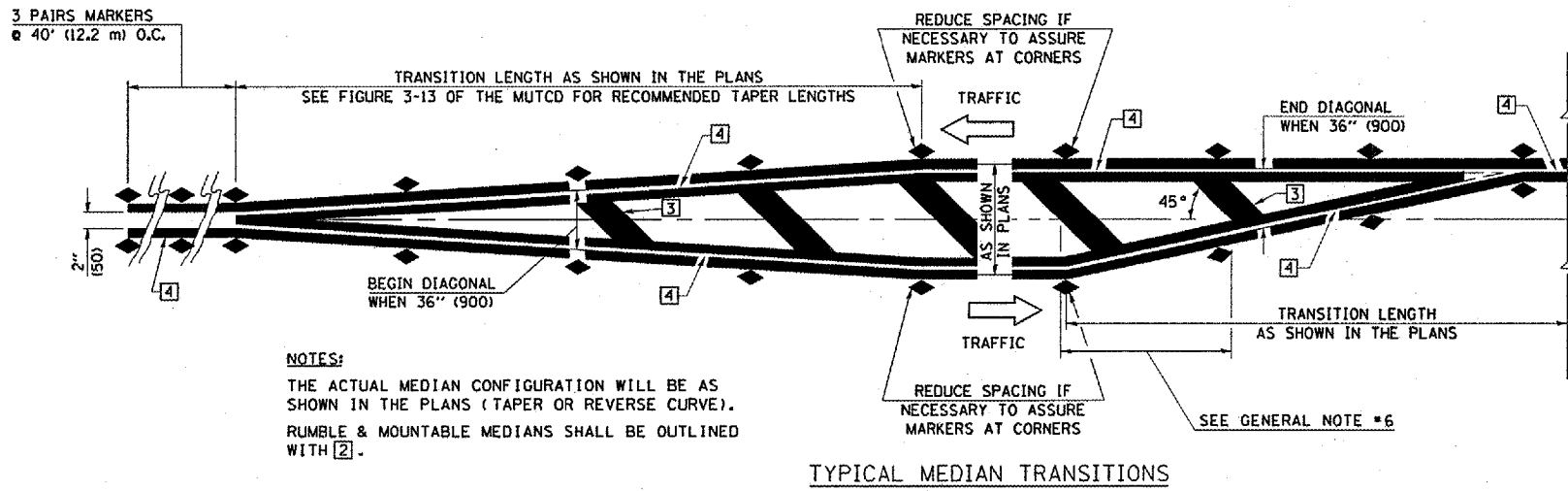

GENERAL NOTES

1. WHEN MEDIANS ARE PRESENT, PAVEMENT MARKINGS ARE TO BE PLACED ADJACENT TO MEDIANS.
2. SOME OF THE INFORMATION INCLUDED WITH THIS DETAIL MAY NOT BE APPLICABLE TO THIS IMPROVEMENT.
3. PAVEMENT MARKINGS ARE TO BE EXTENDED THROUGH OMISSIONS WHEN APPLICABLE.
4. A STRIPING KEY IS AVAILABLE ELSEWHERE AND SHALL BE SHOWN WHERE THE QUANTITIES ARE LISTED.
5. FINAL PAVEMENT MARKINGS SHALL BE IN PLACE PRIOR TO PLACING ANY RAISED REFLECTIVE PAVEMENT MARKERS.
6. THE FOLLOWING CRITERIA SHALL BE USED FOR SELECTING THE DIAGONAL PAVEMENT MARKING SPACING,
 < 30 MPH USE 15' (< 50 km/h USE 4.5 m)
 30-45 MPH USE 20' (50-75 km/h USE 6.0 m)
 > 45 MPH USE 30' (> 75 km/h USE 9.0 m)

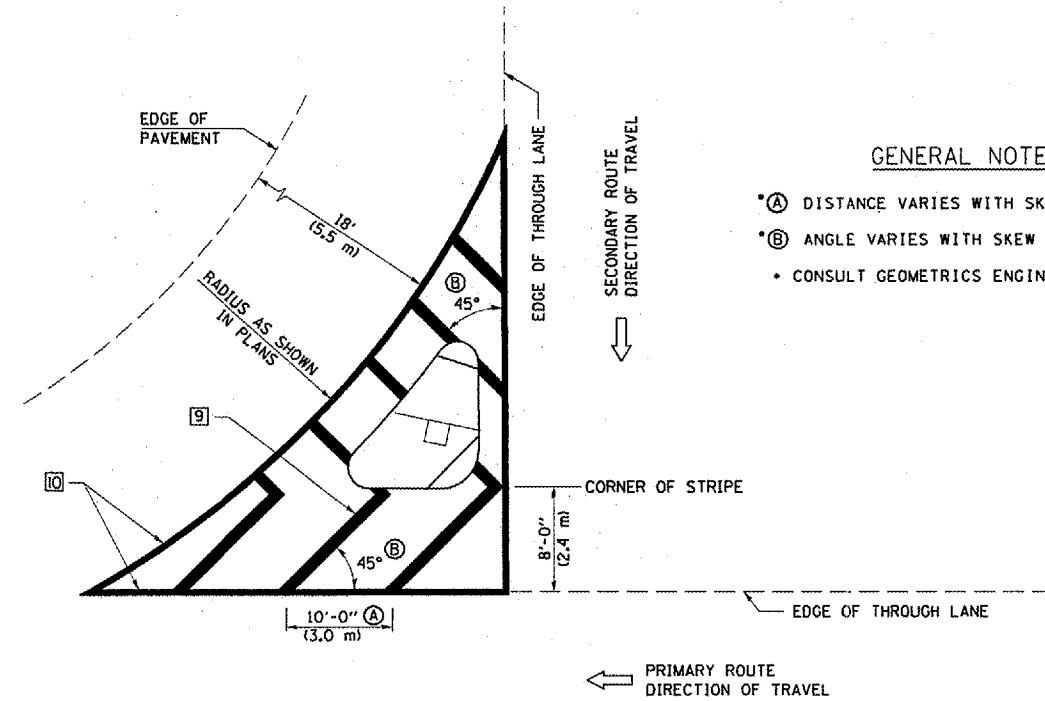
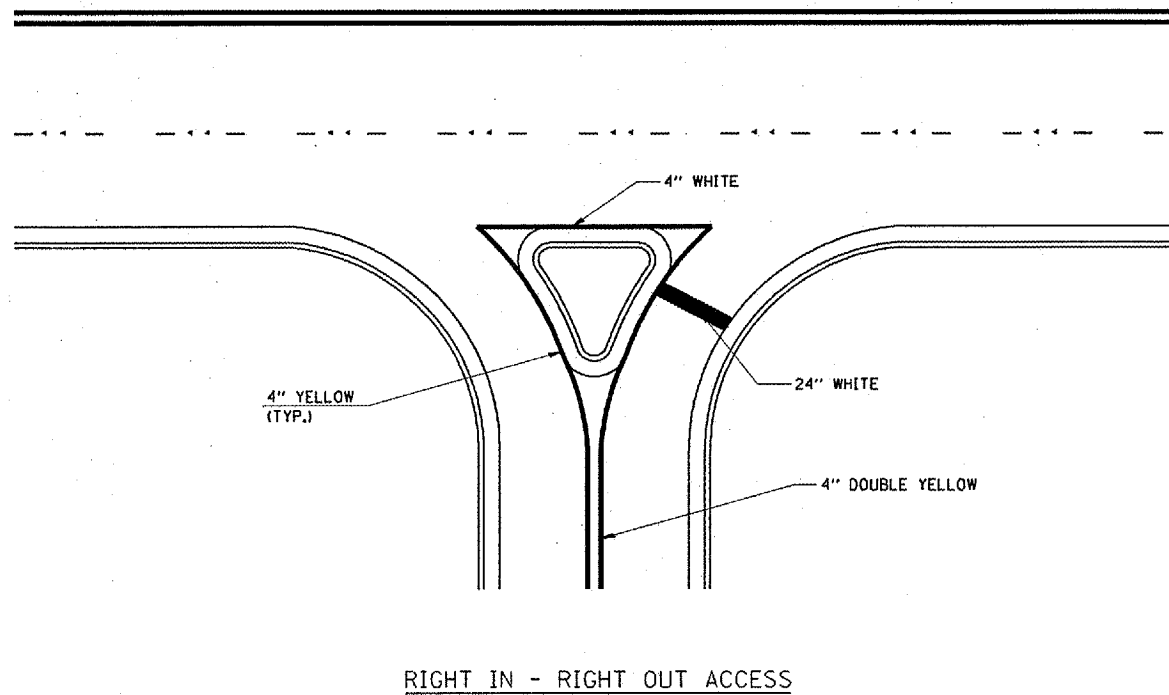

Note: All dimensions are in INCHES (millimeters) unless otherwise shown.

DATE	REVISIONS	NAME	ILLINOIS DEPARTMENT OF TRANSPORTATION
11/06	REPLACED DETAIL F-5,25	TJB	PAVEMENT MARKING AND MARKERS (RURAL & URBAN APPLICATIONS)
			DISTRICT 5 DETAIL NO. 7800AAAA

PLOT DATE: 18/17/2007
 FILE NAME: c:\proj\pav\4666387\1817\78073\detail3.dwg
 PLOT SCALE: 1/4" = 1'-0"
 USER NAME: collierb

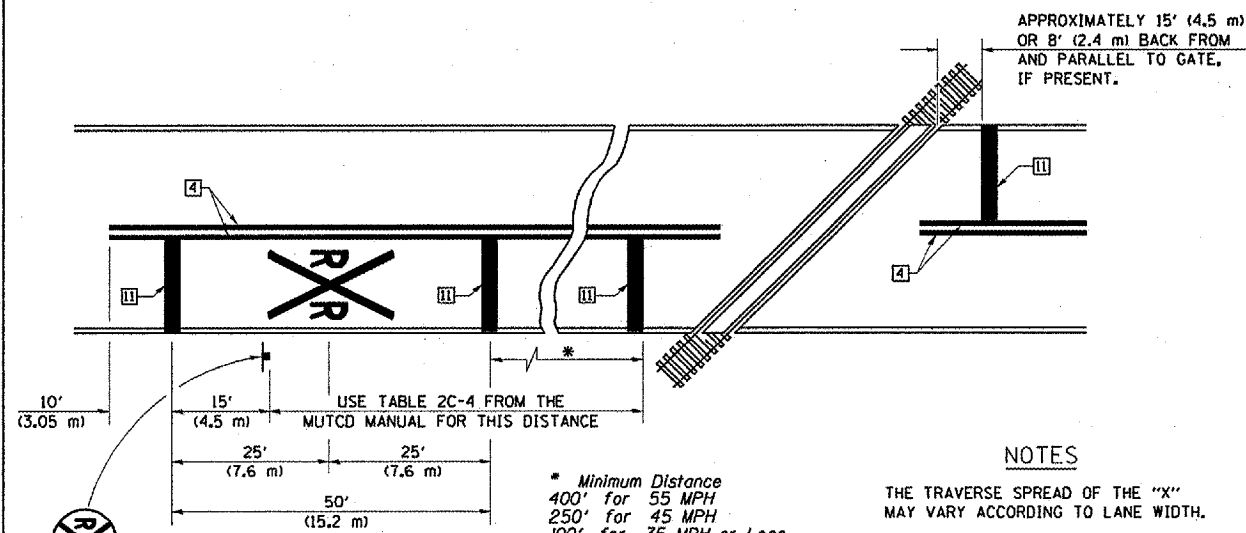

PAVEMENT MARKINGS AT RAILROAD-HIGHWAY GRADE CROSSING

NOTES

THE TRAVERSE SPREAD OF THE "X" MAY VARY ACCORDING TO LANE WIDTH.

ON MULTI-LANE ROADS, THE STOP LINES SHALL EXTEND ACROSS ALL APPROACH LANES AND SEPARATE RXR SYMBOLS SHALL BE PLACED ADJACENT TO EACH OTHER IN EACH LANE.

WHEN THE PAVEMENT MARKING SYMBOL IS USED, A PORTION OF THE SYMBOL SHOULD BE LOCATED DIRECTLY ADJACENT TO THE ADVANCE WARNING SIGN (W10-1) AS PLACED BY TABLE II-1, CONDITION B OF THE MUTCD.

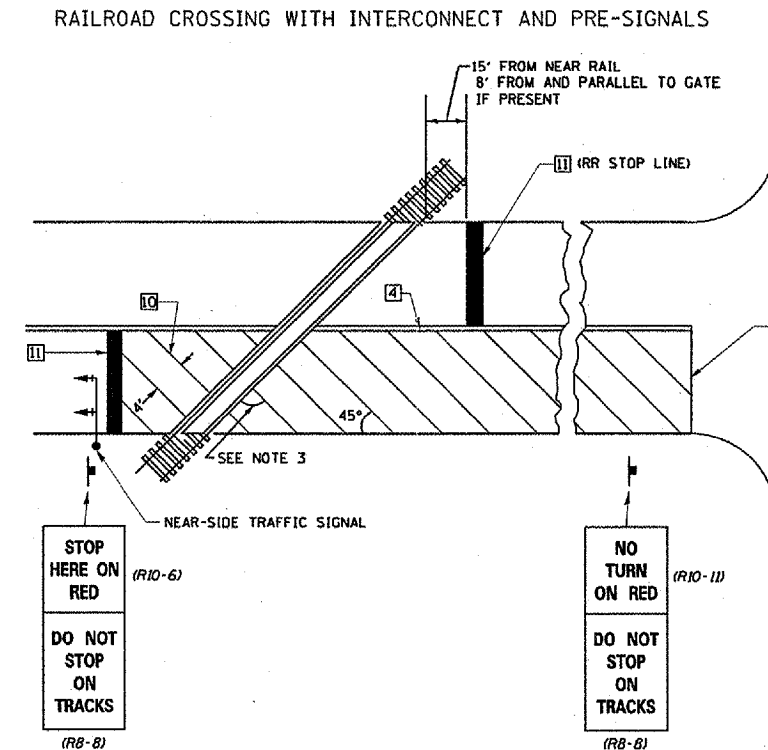
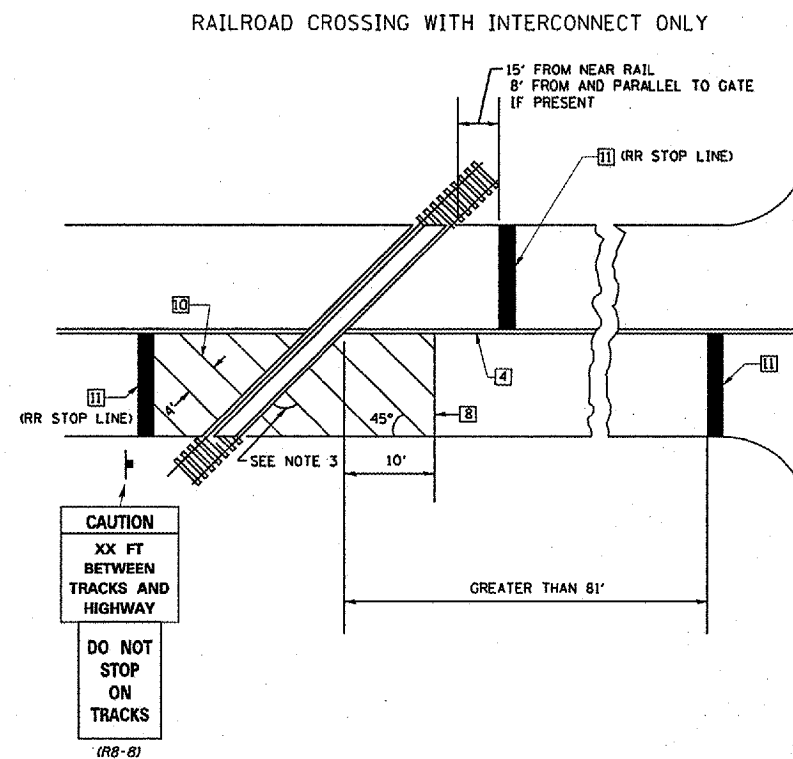

SUPPLEMENTAL PAVEMENT MARKING TREATMENT FOR RAILROAD-HIGHWAY GRADE CROSSING

GENERAL NOTES

- SUPPLEMENTAL PAVEMENT MARKINGS TO BE INSTALLED ONLY ON APPROACHES TO INTERSECTIONS CONTROLLED BY TRAFFIC SIGNALS WHICH ARE INTERCONNECTED WITH THE RAILROAD WARNING SIGNALS.
- EXTEND PAVEMENT MARKINGS TO THE INTERSECTION ONLY WHERE NEAR-SIDE TRAFFIC SIGNALS ARE USED.
- WHERE THE ANGLE BETWEEN THE DIAGONAL PAVEMENT MARKINGS AND THE TRACK WOULD BE LESS THAN 20°, THE PAVEMENT MARKINGS SHOULD BE PLACED IN THE OPPOSITE DIRECTION FROM THAT SHOWN.

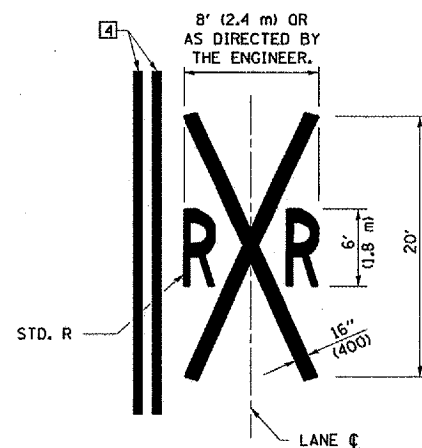

Note: All dimensions are in INCHES (millimeters) unless otherwise shown.

DATE	REVISIONS	NAME
11/06	REPLACED DETAIL F-5.25	TJB

ILLINOIS DEPARTMENT OF TRANSPORTATION

PAVEMENT MARKING AND MARKERS (RURAL & URBAN APPLICATIONS)

DISTRICT 5 DETAIL NO. 7800AAAA