

F.A.P. RTE.	SECTION	COUNTY	TOTAL SHEETS	SHEET NO.
753	143RS-6	CHRISTIAN	127	25
STA. 110+00.00		TO STA. 116+00.00		
FED. ROAD DIST. NO.		ILLINOIS	FED. AID PROJECT	

PLAN	SURVEYED	BY	DATE
NO. _____	PLOTTED		
	NOTED		
	CHK'D		
	APP'D		

PROFILE	SURVEYED	BY	DATE
NO. _____	PLOTTED		
	NOTED		
	CHK'D		
	APP'D		

PLOT DATE = Dec-12-2007 10:35:36AM
 FILE NAME = c:\p\proj\143rs-6\143rs-6.dgn
 PLOT SCALE = 4.23529' / IN.
 USER NAME = laughlin-1

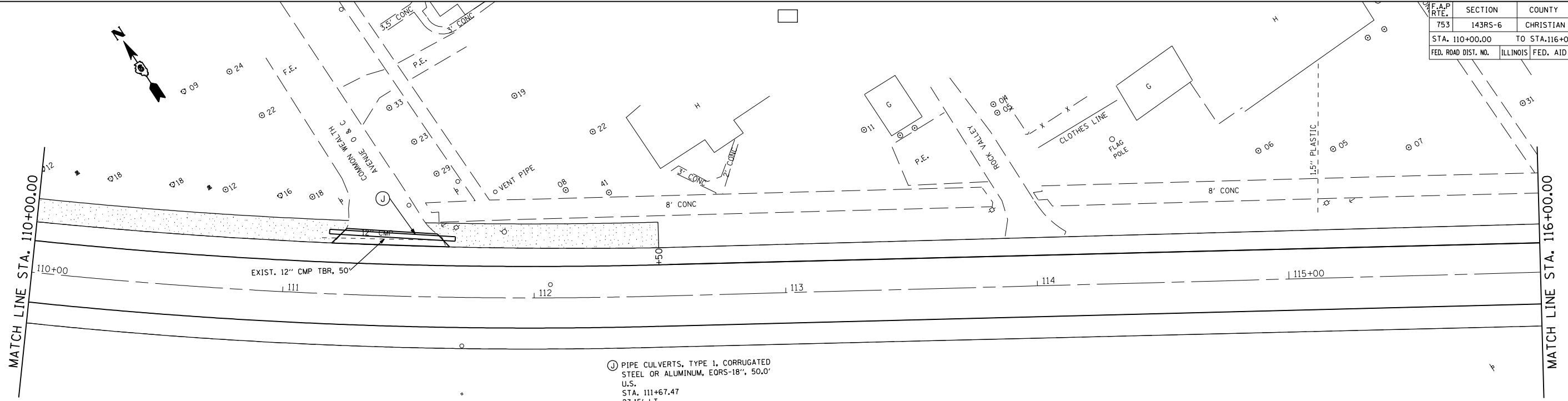

Ⓧ PIPE CULVERTS, TYPE 1, CORRUGATED STEEL OR ALUMINUM, EORS-18", 50.0' U.S. STA. 111+67.47 23.15' LT U.S. \bar{R}_L = 597.01 U.S. DITCH \bar{R}_L = 597.34 D.S. STA. 111+17.47 24.71' LT D.S. \bar{R}_L = 597.01 D.S. DITCH \bar{R}_L = 597.30

