

F.A.P. RTE.	SECTION	COUNTY	TOTAL SHEETS	SHEET NO.
753	143RS-6	CHRISTIAN	127	63
STA.		TO STA.		
FED. ROAD DIST. NO.	ILLINOIS	FED. AID PROJECT		

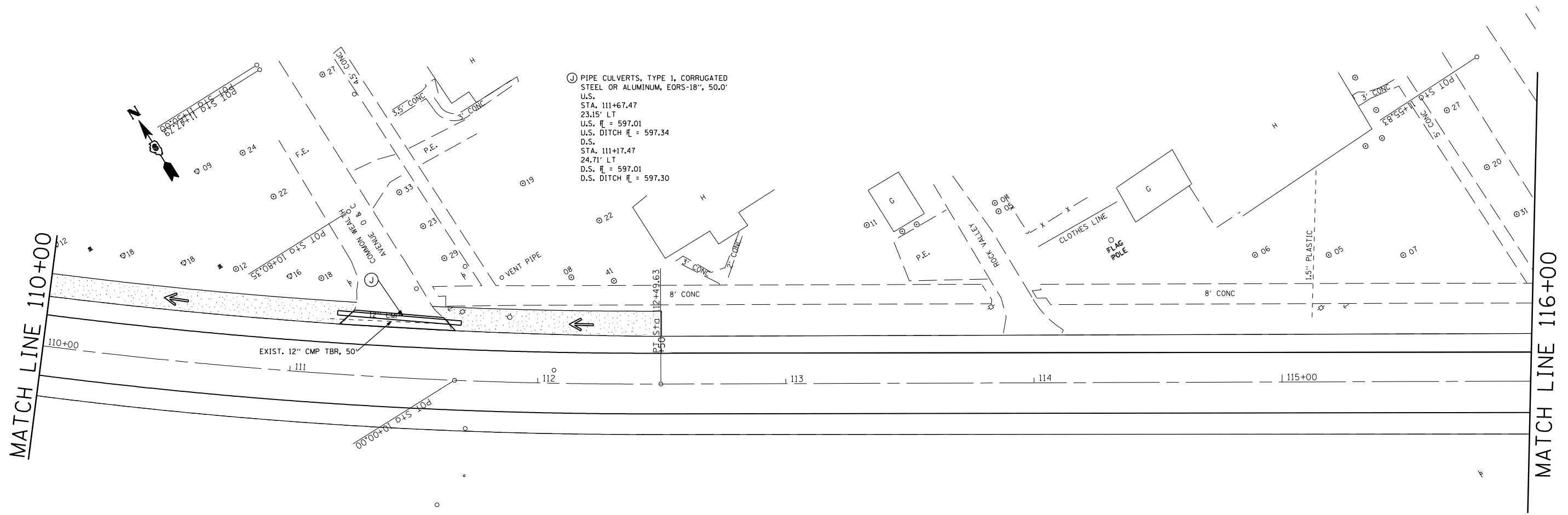

(C) PIPE CULVERTS, TYPE 1, CORRUGATED  
 STEEL OR ALUMINUM, EORS-18", 50.0'  
 U.S.  
 STA. 111+67.47  
 23.15' LT  
 U.S. E = 597.01  
 U.S. DITCH E = 597.34  
 D.S.  
 STA. 111+17.47  
 24.71' LT  
 D.S. E = 597.01  
 D.S. DITCH E = 597.30

REVISIONS	
NAME	DATE

ILLINOIS DEPARTMENT OF TRANSPORTATION

**STORM WATER POLLUTION PREVENTION PLAN**

SCALE: VERT.      DRAWN BY  
 HORIZ.              CHECKED BY  
 DATE