

CONTRACT NO. 72943

F.A.U. RTE.	SECTION	COUNTY	TOTAL SHEETS	SHEET NO.
11RS-8	ADAMS	64	38	
STA. 2314+00.00		TO STA. 2326+00.00		
FED. ROAD DIST. NO.		ILLINOIS FED. AID PROJECT		
• 7810 & 7825 (IL 96)				

(From Pg. 36)

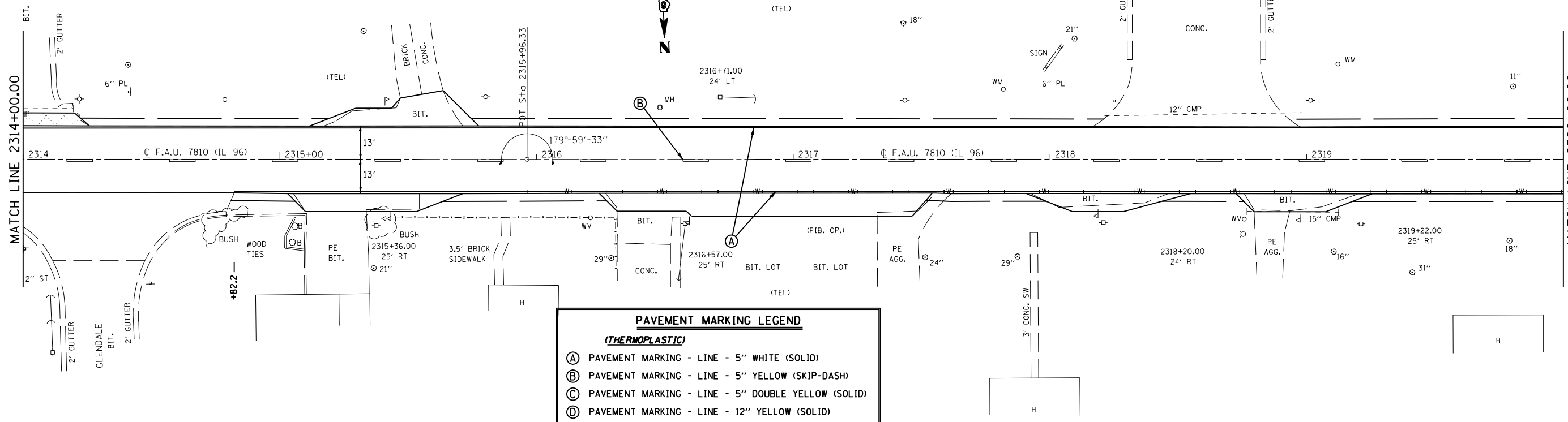

PAVEMENT MARKING LEGEND	
<b>(THERMOPLASTIC)</b>	
(A)	PAVEMENT MARKING - LINE - 5" WHITE (SOLID)
(B)	PAVEMENT MARKING - LINE - 5" YELLOW (SKIP-DASH)
(C)	PAVEMENT MARKING - LINE - 5" DOUBLE YELLOW (SOLID)
(D)	PAVEMENT MARKING - LINE - 12" YELLOW (SOLID)
<b>(PREFORMED PLASTIC, TYPE B)</b>	
(E)	PAVEMENT MARKING - LINE - 6" WHITE (SOLID)
(F)	PAVEMENT MARKING - LINE - 6" WHITE (SKIP-DASH)
(G)	PAVEMENT MARKING - LINE - 24" WHITE (SOLID)
(H)	PAVEMENT MARKING - LETTERS & SYMBOLS WHITE (SOLID)

(Con't on Pg. 39)

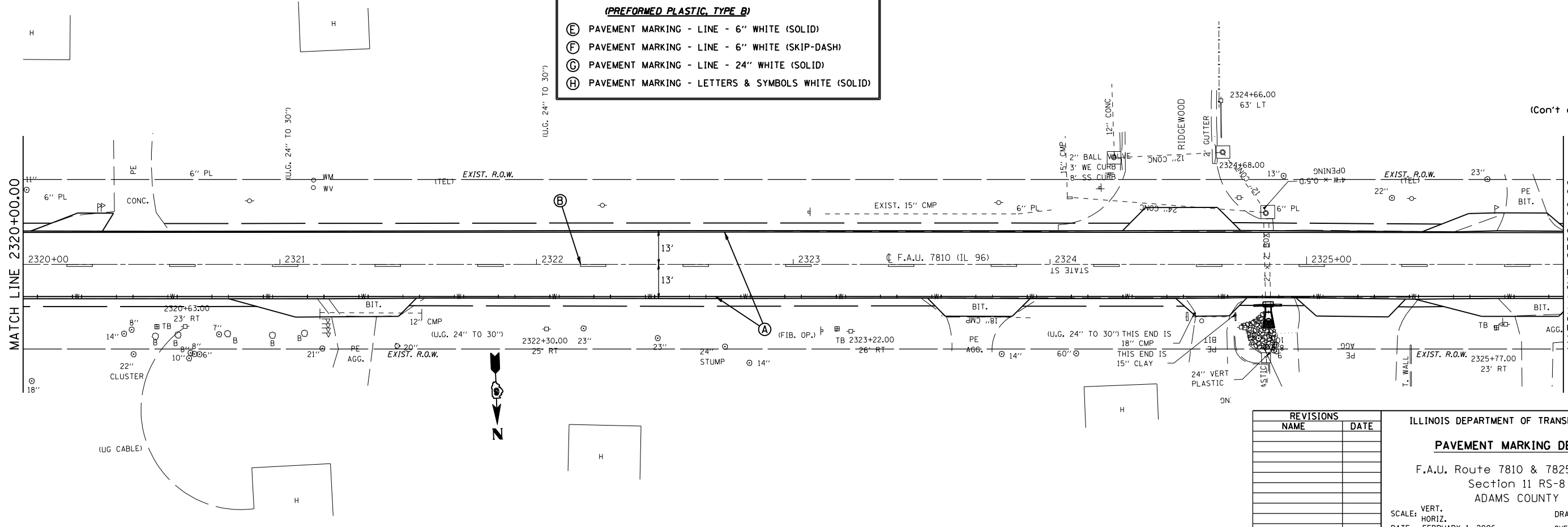

REVISIONS	
NAME	DATE

ILLINOIS DEPARTMENT OF TRANSPORTATION  
**PAVEMENT MARKING DETAIL**  
 F.A.U. Route 7810 & 7825 (IL 96)  
 Section 11 RS-8  
 ADAMS COUNTY  
 SCALE: VERT. 1" = 20'  
 HORIZ. 1" = 40'  
 DATE: FEBRUARY 1, 2006  
 DRAWN BY: JWC  
 CHECKED BY: RSC

PLOT DATE = Nov-02-2007 01:44:57PM  
 FILE NAME = c:\projects\650605\shpvtmrk196.dgn  
 PLOT SCALE = 42.352% / IN.  
 USER NAME = laughlinr1