

F.A.P. RTE.	SECTION	COUNTY	TOTAL SHEETS	SHEET NO.
320	*	LOGAN	12	9
STA.		TO STA.		
FED. ROAD DIST. NO.		ILLINOIS FED. AID PROJECT		

\* D-6 SHLDR RUMBLE STRIPS 2008-4

**CURVE DATA TAKEN FROM EXISTING PLANS**

**CURVE 503**

PI STA. = 340+00.00  
 $\Delta$  = 25°59' (LT)  
 D = 2°00'  
 R = 2,865.0'  
 T = 661.0'  
 L = 1299.2'  
 E = 75.3'  
 e = 5.6%  
 TR = 43'  
 SE RUN = 160'  
 P.C. STA. = 333+39.00  
 P.T. STA. = 346+38.20  
 SE ATTAINED FROM  
 STA. 331+89 TO STA. 333+92  
 SE REMOVED FROM  
 STA. 345+85 TO STA. 347+88

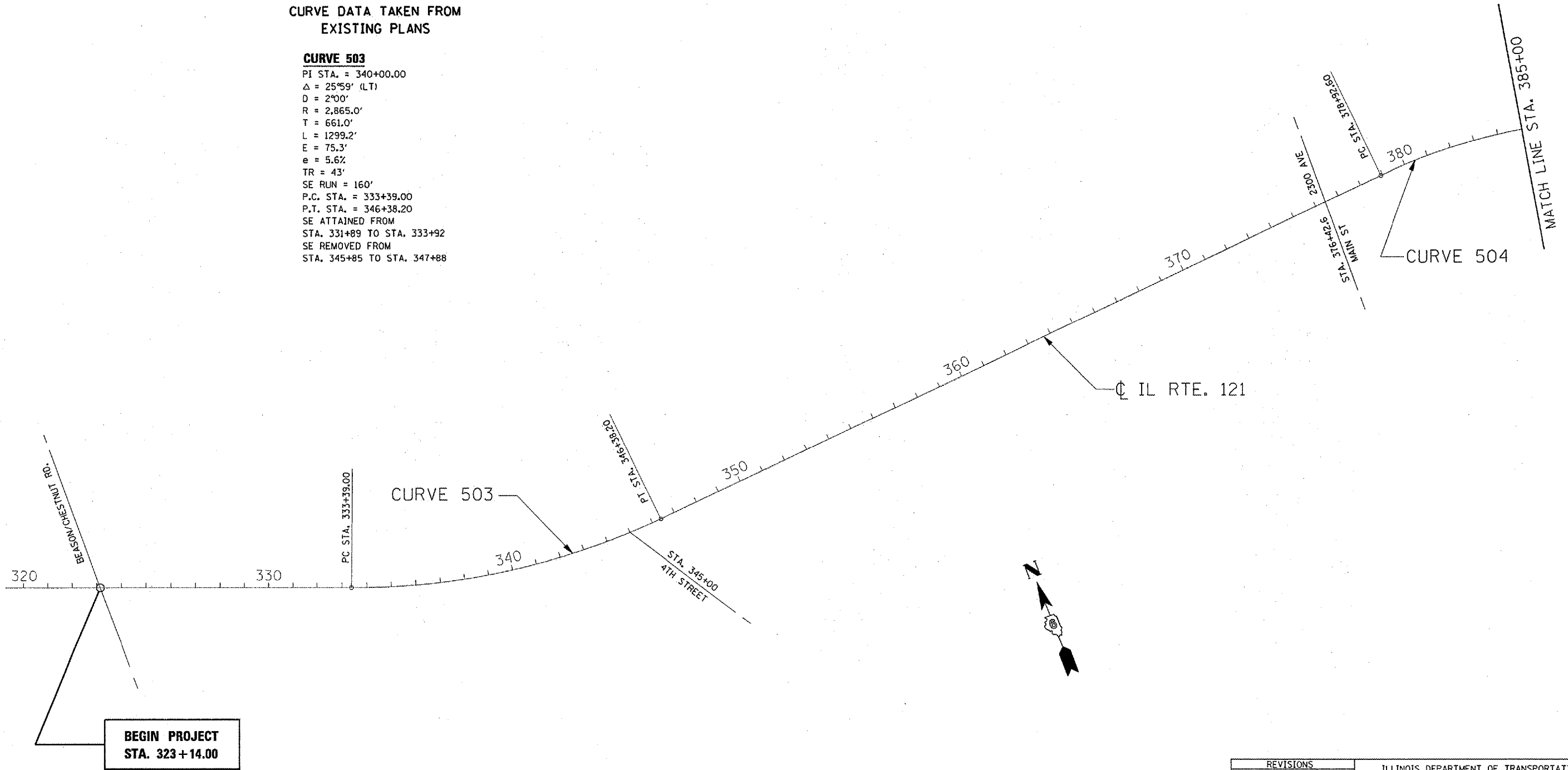

PLOT DATE = Nov-15-2007 07:24:28AM  
 FILE NAME = c:\projects\6611987\line.dwg  
 PLOT SCALE = 847.0288 / IN  
 USER NAME = Trougher1

REVISIONS	
NAME	DATE

ILLINOIS DEPARTMENT OF TRANSPORTATION  
**LINE DIAGRAM SHEETS**  
 FAP 320 (IL 121)  
 SECT. D-6 SHLDR RUMBLE STRIPS 2008-4  
 LOGAN COUNTY

SCALE: VERT. \_\_\_\_\_  
 HORIZ. \_\_\_\_\_

DATE \_\_\_\_\_ DRAWN BY \_\_\_\_\_  
 CHECKED BY \_\_\_\_\_