

F.A.P. RTE.	SECTION	COUNTY	TOTAL SHEETS	SHEET NO.
328	*	WAYNE	140	21
STA. 885+50.00		TO STA. 891+50.00		
FED. ROAD DIST. NO.		ILLINOIS FED. AID PROJECT		
* (8BR-2,10BR-3)B-1				

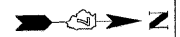

PLAN

DATE	
BY	
CHECKED	
DESIGNED	
NOTED	
PLANNED	
APPROVED	

PROFILE

DATE	
BY	
CHECKED	
DESIGNED	
NOTED	
PLANNED	
APPROVED	

Plot Date: 9/17/2007
 Plot Time: 10:07:53 AM
 Plotted By: sdonahue
 File Name: I:\06655\00\tracemgmt\construction\plans\06-0067.EC02.dgn

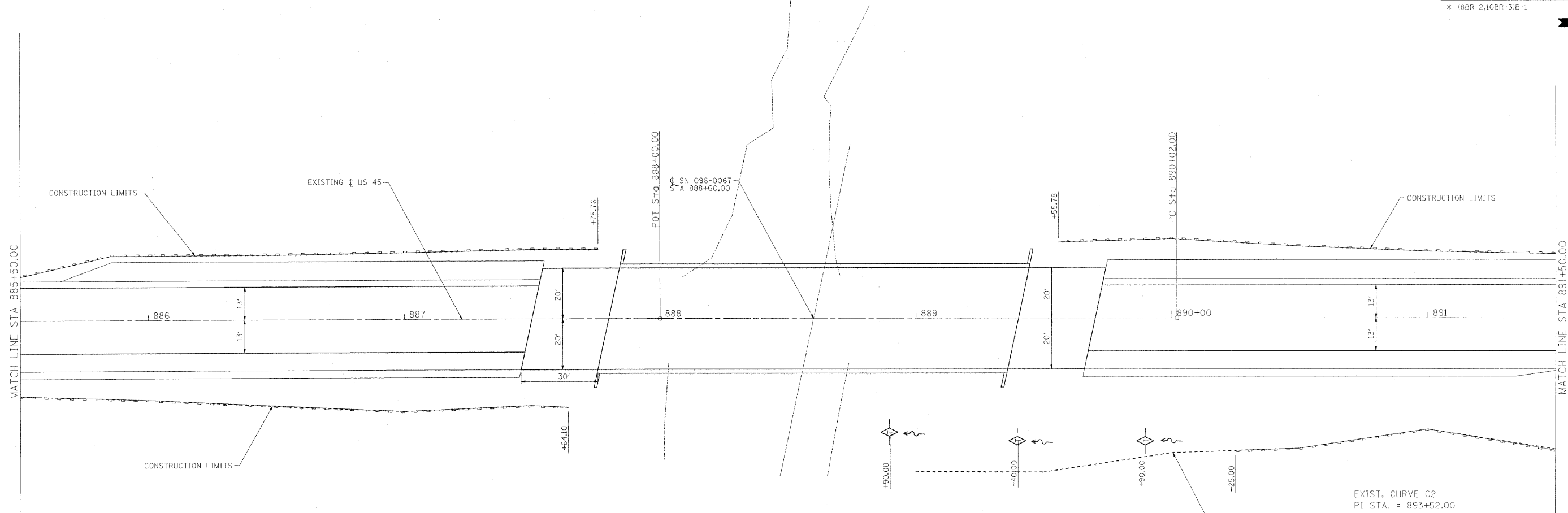

LEGEND

- TEMPORARY DITCH CHECK
- PERIMETER EROSION BARRIER

EXIST. CURVE C2
 P.I. STA. = 893+52.00
 $\Delta = 0^\circ 08' 15''$ (RT)
 $D = 0^\circ 01' 11''$
 $R = 291,687.46'$
 $T = 350.00'$
 $L = 700.00'$
 $E = 0.21'$
 $\theta =$
 $T.R. =$
 $S.E. RUN =$
 $P.C. STA. = 890+02.00$
 $P.T. STA. = 897+02.00$

