

F.A.P. No.	SECTION	COUNTY	TOTAL SHEETS	SHEET NO.
328	*	WAYNE	140	22
STA. 891+50.00		TO STA. 897+50.00		
FED. ROAD DIST. NO.		ILLINOIS FED. AID PROJECT		
* (8BR-2,10BR-3)B-1				

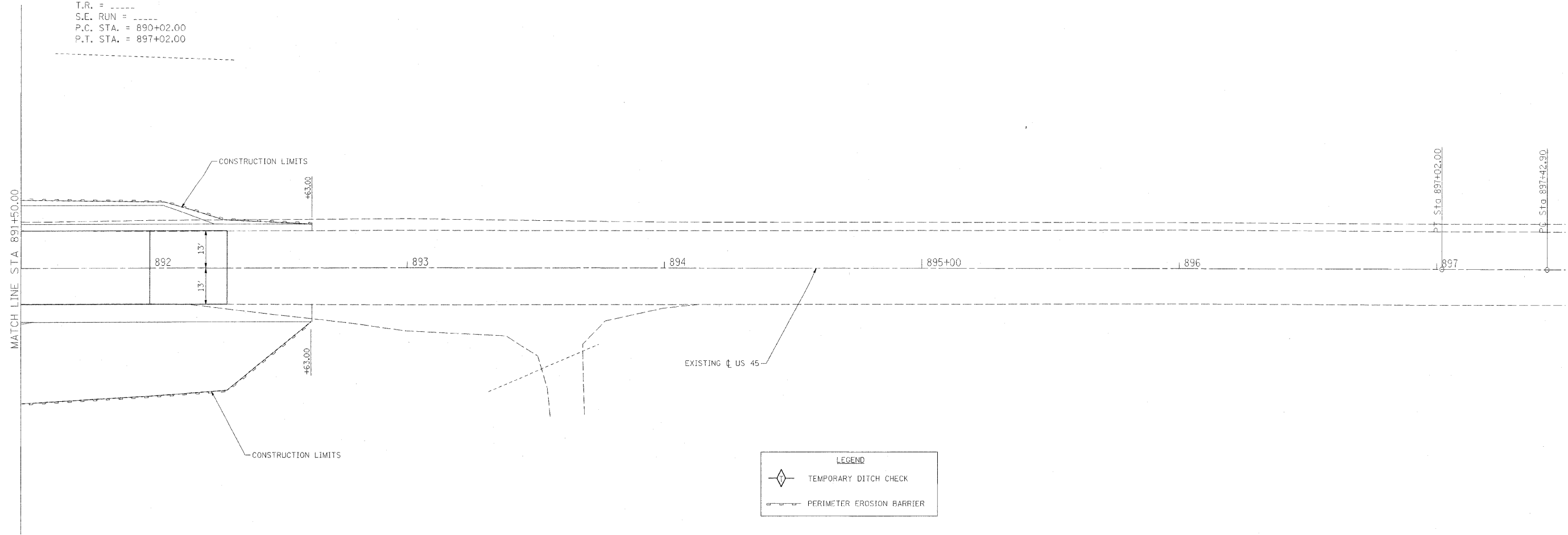

EXIST. CURVE C2
 PI STA. = 893+52.00
 $\Delta = 0^\circ 08' 15''$ (RT)
 $D = 0^\circ 01' 11''$
 $R = 291,687.46'$
 $T = 350.00'$
 $L = 700.00'$
 $E = 0.21'$
 $\phi =$ -----
 $T.R. =$ -----
 $S.E. RUN =$ -----
 $P.C. STA. = 890+02.00$
 $P.T. STA. = 897+02.00$



LEGEND

- TEMPORARY DITCH CHECK
- PERIMETER EROSION BARRIER

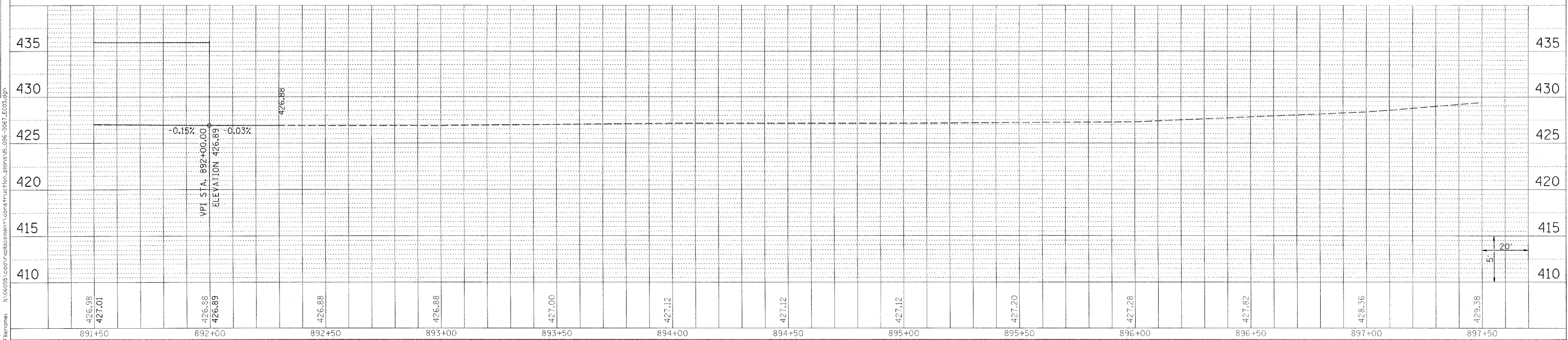
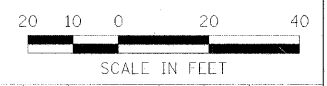

PLAN

DATE	
BY	
CHECKED	
DESIGNED	
NOTED	
NO.	

PROFILE

DATE	
BY	
CHECKED	
DESIGNED	
NOTED	
NO.	

Plot Date: 9/7/2007
 Plot Time: 10:01:06 AM
 Plotter: sdonahue
 Pen Table:
 Filename: I:\06055\cadd\placement\construction\plans\096-0067_EC05.dgn