

F.A.R. NO.	SECTION	COUNTY	TOTAL SHEETS	SHEET NO.
328	(10BR-2, 10BR-3, 8BR-2)B-1	WAYNE		
FED. ROAD DIST. NO. 7		ILLINOIS	FED. AID PROJECT NO.	
			TOTAL SHEETS	SHEET NO.
			140	137

STATE OF ILLINOIS
DEPARTMENT OF TRANSPORTATION
DIVISION OF HIGHWAY
RIGHT OF WAY PLANS
FOR PROPOSED
FEDERAL AID HIGHWAY
FAS ROUTE 328 (US ROUTE 45)
SECTION (10BR-2, 10BR-3, 8BR-2)B-1
WAYNE COUNTY
JOB NO. R-97-005-06

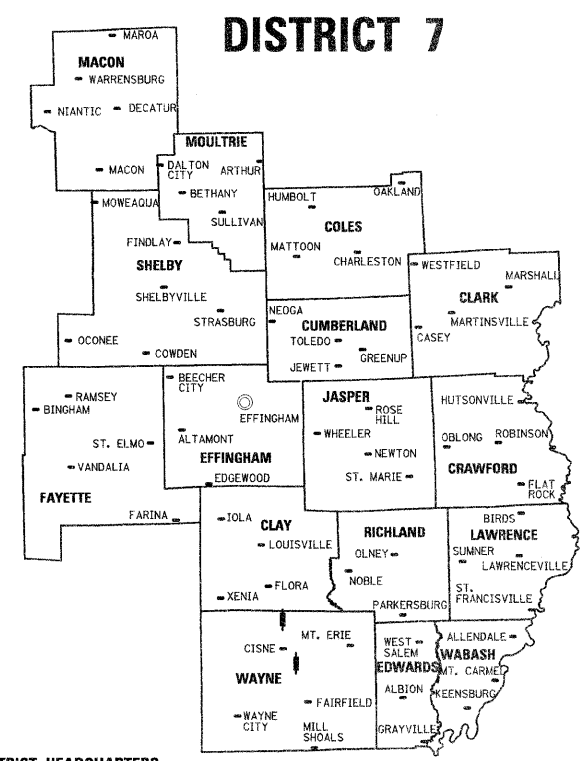

SECTION (8BR-2)B-1
 STA. 882+00 TO
 STA. 895+00

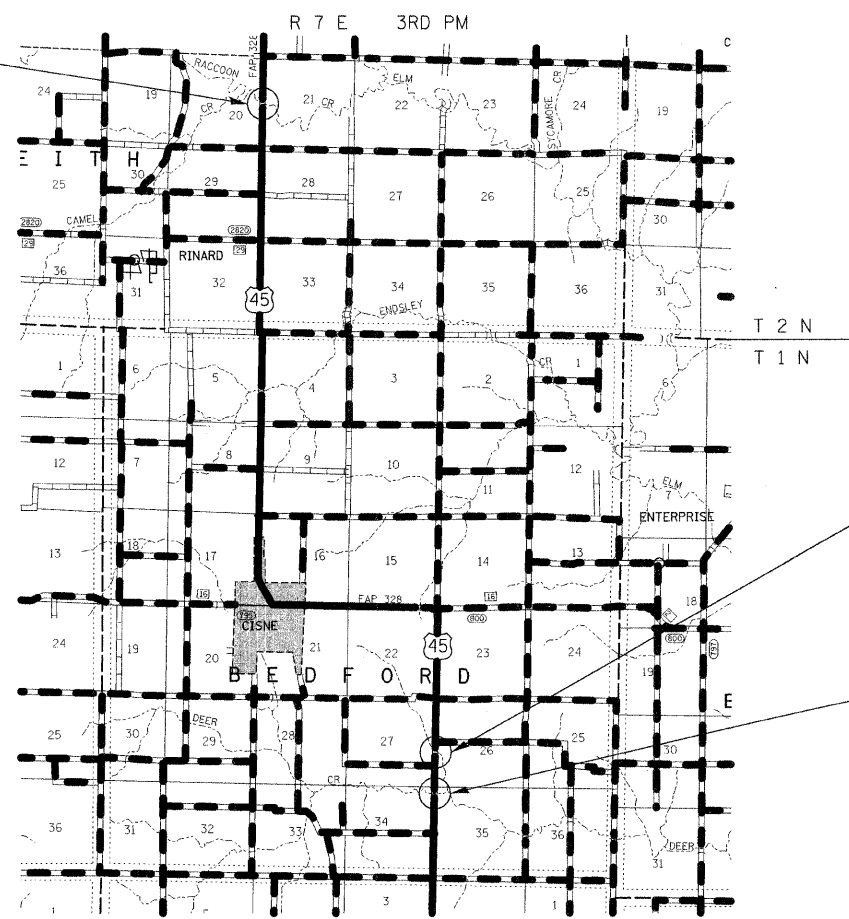

SECTION (10BR-3)B-1
 STA. 406+00 TO
 STA. 415+00

STATION EQUATION
 405+00 BK =
 405+06.39 AH

SECTION (10BR-2)B-1
 STA. 378+00 TO
 STA. 391+00

© DISTRICT HEADQUARTERS

LOCATION OF SECTION INDICATED THUS:

STATE OF ILLINOIS DEPARTMENT OF TRANSPORTATION DIVISION OF HIGHWAYS	
SUBMITTED _____	20 _____ DISTRICT ENGINEER
EXAMINED _____	20 _____ CHIEF OF PLATS AND PLANS
PASSED _____	20 _____ DISTRICT LAND ACQUISITION ENGINEER
REVIEWED _____	20 _____ CENTRAL BUREAU RIGHT OF WAY PLANS ENGINEER
APPROVED _____	20 _____ ENGINEER OF LAND ACQUISITION

NET LENGTH OF PROJECT= 3500.00 LIN. FT. = 0.663 MILES

CONTRACT NO. 74040

c:\projects\view\74040\10104pa.dgn DATE*