

F.A.S. RTE.	SECTION	COUNTY	TOTAL SHEETS	SHEET NO.
1832	5BR-2	WASHINGTON	97	61
STA. _____		TO STA. _____		
FED. ROAD DIST. NO. _____		ILLINOIS FED. AID PROJECT		

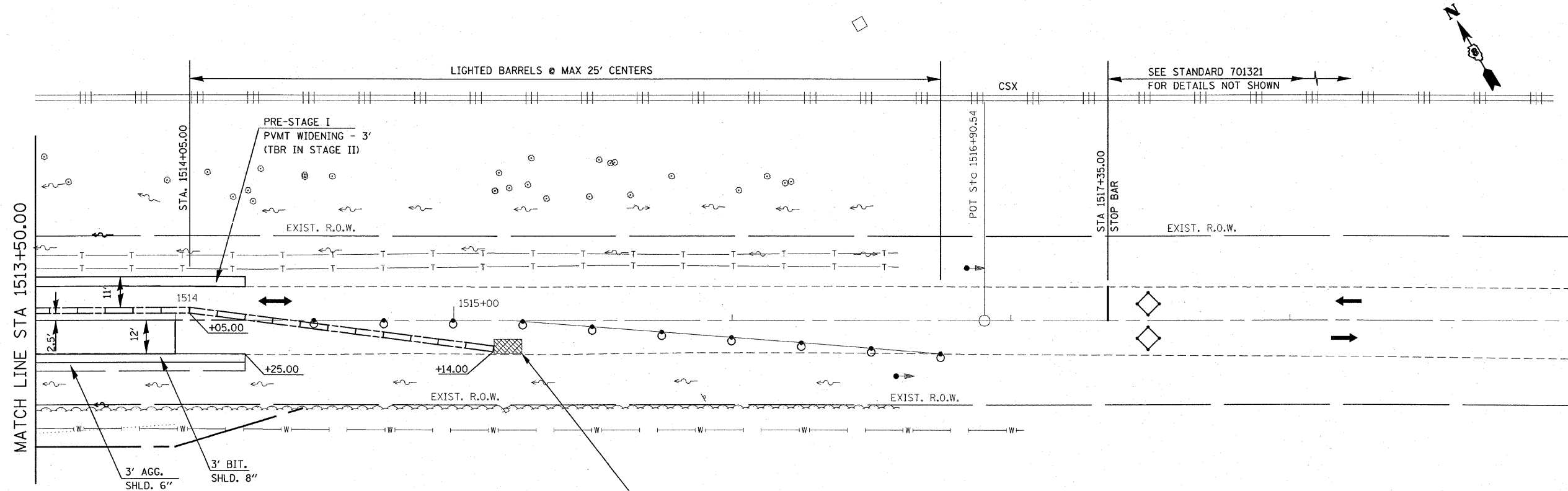

LEGEND:

- STRUCTURE REMOVAL
- PAVEMENT REMOVAL
- TEMPORARY CONCRETE BARRIER
- IMPACT ATTENUATOR
- INDUCTION LOOP DETECTOR
- DRUM WITH STEADY BURNING LIGHT
- SIGNALIZED TWO-WAY TRAFFIC LANE
- TEMPORARY BRIDGE TRAFFIC SIGNAL
- TYPE III BARRICADE

- LEGEND**
- ① EXISTING PAVEMENT
 - ⑤ PROPOSED HOT-MIX ASPHALT BASE COURSE WIDENING 9"
 - ⑧ PROPOSED HOT-MIX ASPHALT BINDER COURSE (VARIES 0.75" TO 15")
 - ⑨ PROPOSED HOT-MIX ASPHALT SURFACE COURSE 1 1/2 "
 - ⑩ PROPOSED HOT-MIX ASPHALT SHOULDERS, 8"
 - ⑪ PROPOSED AGGREGATE SHOULDER 6"

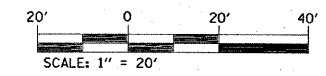
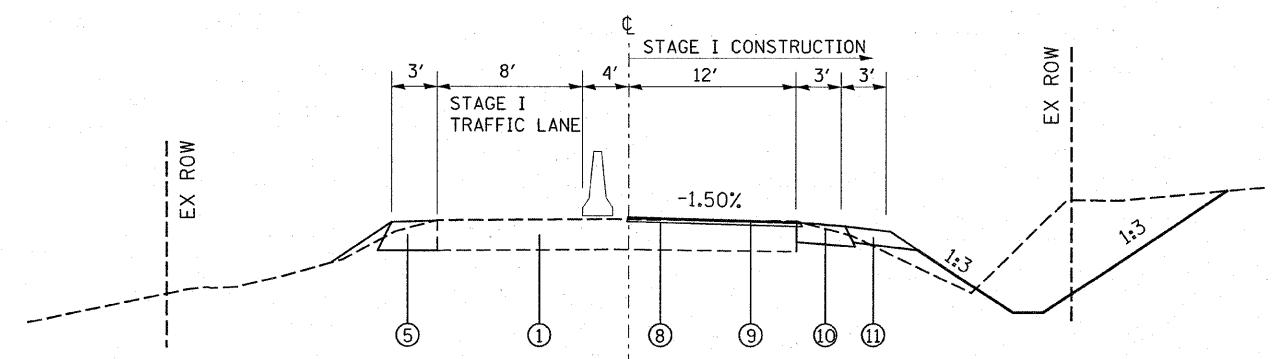

REVISIONS	
NAME	DATE

ILLINOIS DEPARTMENT OF TRANSPORTATION
SUGGESTED STAGE I CONSTRUCTION
 FAS ROUTE 1832
 SECTION 5BR-2
 WASHINGTON COUNTY

SCALE: VERT. _____
 HORIZ. _____
 DATE _____

DRAWN BY _____
 CHECKED BY _____

PLOT DATE = 12/7/2007
 PLOT SCALE = 1" = 20'
 USER NAME = gmlrkh

SN 095-0078