

F.A.S. RTE.	SECTION	COUNTY	TOTAL SHEETS	SHEET NO.
1832	5BR-2	WASHINGTON	97	63
STA. _____		TO STA. _____		
FED. ROAD DIST. NO. _____		ILLINOIS FED. AID PROJECT		

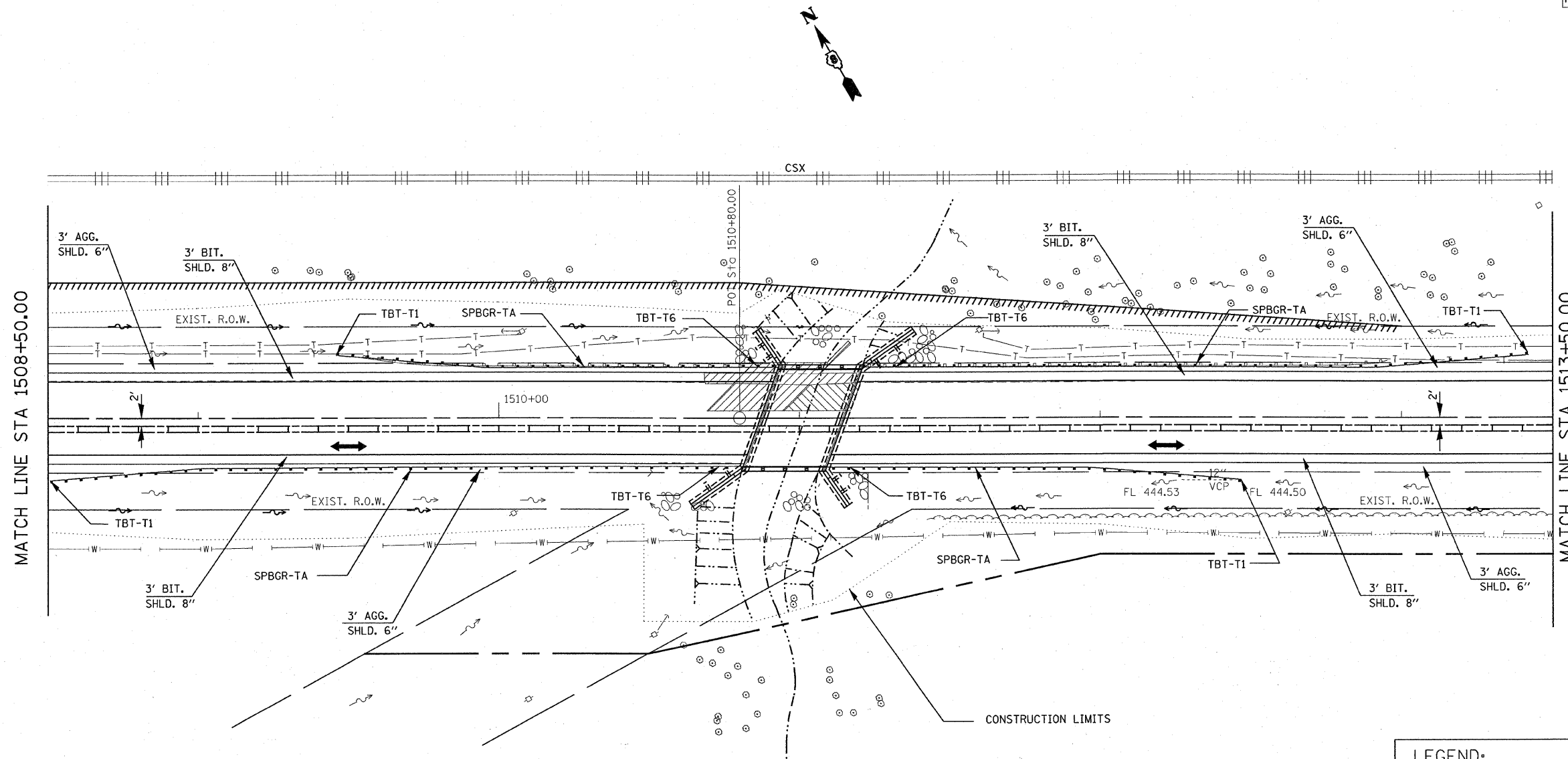

LEGEND:

- STRUCTURE REMOVAL
- PAVEMENT REMOVAL
- TEMPORARY CONCRETE BARRIER
- IMPACT ATTENUATOR
- INDUCTION LOOP DETECTOR
- DRUM WITH STEADY BURNING LIGHT
- SIGNALIZED TWO-WAY TRAFFIC LANE
- TEMPORARY BRIDGE TRAFFIC SIGNAL
- TYPE III BARRICADE

- LEGEND**
- ① EXISTING PAVEMENT
 - ⑤ PROPOSED HOT-MIX ASPHALT BASE COURSE WIDENING 9"
 - ⑧ PROPOSED HOT-MIX ASPHALT BINDER COURSE (VARIES 0.75" TO 15')
 - ⑨ PROPOSED HOT-MIX ASPHALT SURFACE COURSE 1 1/2 "
 - ⑩ PROPOSED HOT-MIX ASPHALT SHOULDERS, 8"
 - ⑪ PROPOSED AGGREGATE SHOULDER 6"
 - ⑫ PROPOSED GUARDRAIL

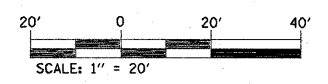
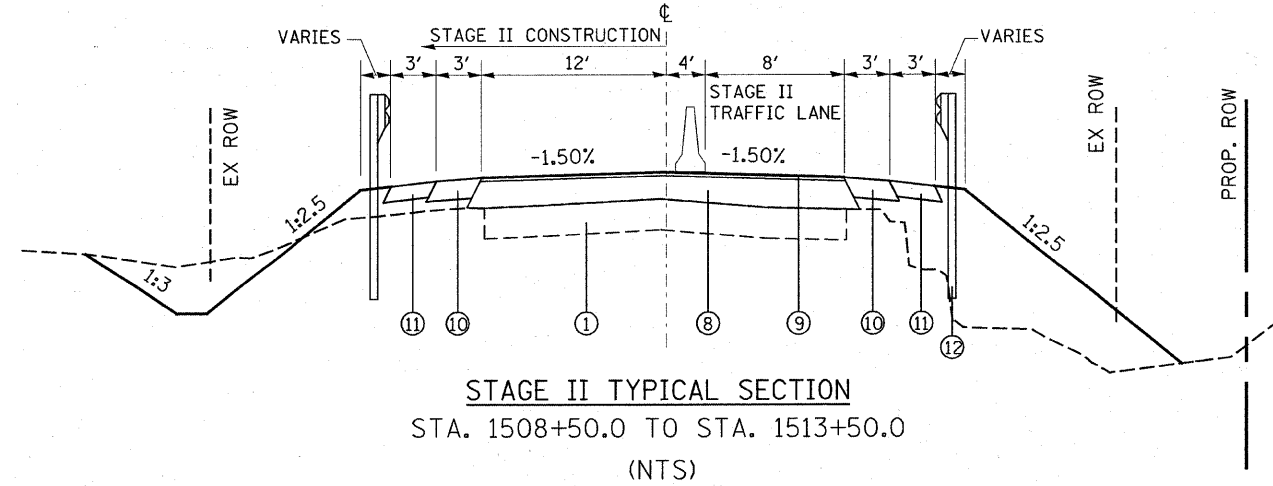

REVISIONS	
NAME	DATE

ILLINOIS DEPARTMENT OF TRANSPORTATION
SUGGESTED STAGE II CONSTRUCTION
 FAS ROUTE 1832
 SECTION 5BR-2
 WASHINGTON COUNTY
 SCALE: VERT. _____
 DATE _____ HORIZ. _____
 DRAWN BY _____
 CHECKED BY _____

SN 095-0078

PLOT DATE = 12/7/2007
 FILE NAME = c:\projects\1832\1832\plan\stage2\1832.dgn
 PLOT SCALE = 20.00000 / IN.
 USER NAME = gelich