

EXIST. CURVE EX1-4
 PI STA. = 242+74.25
 $\Delta = 19^\circ 28' 08''$ (RT)
 $D = 2^\circ 00' 00''$
 $R = 2,864.79'$
 $T = 491.46'$
 $L = 973.45'$
 $E = 41.85'$
 $e =$
 T.R. =
 S.E. RUN =
 P.C. STA. = 237+82.79
 P.T. STA. = 247+56.24

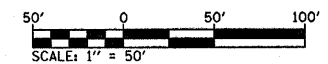
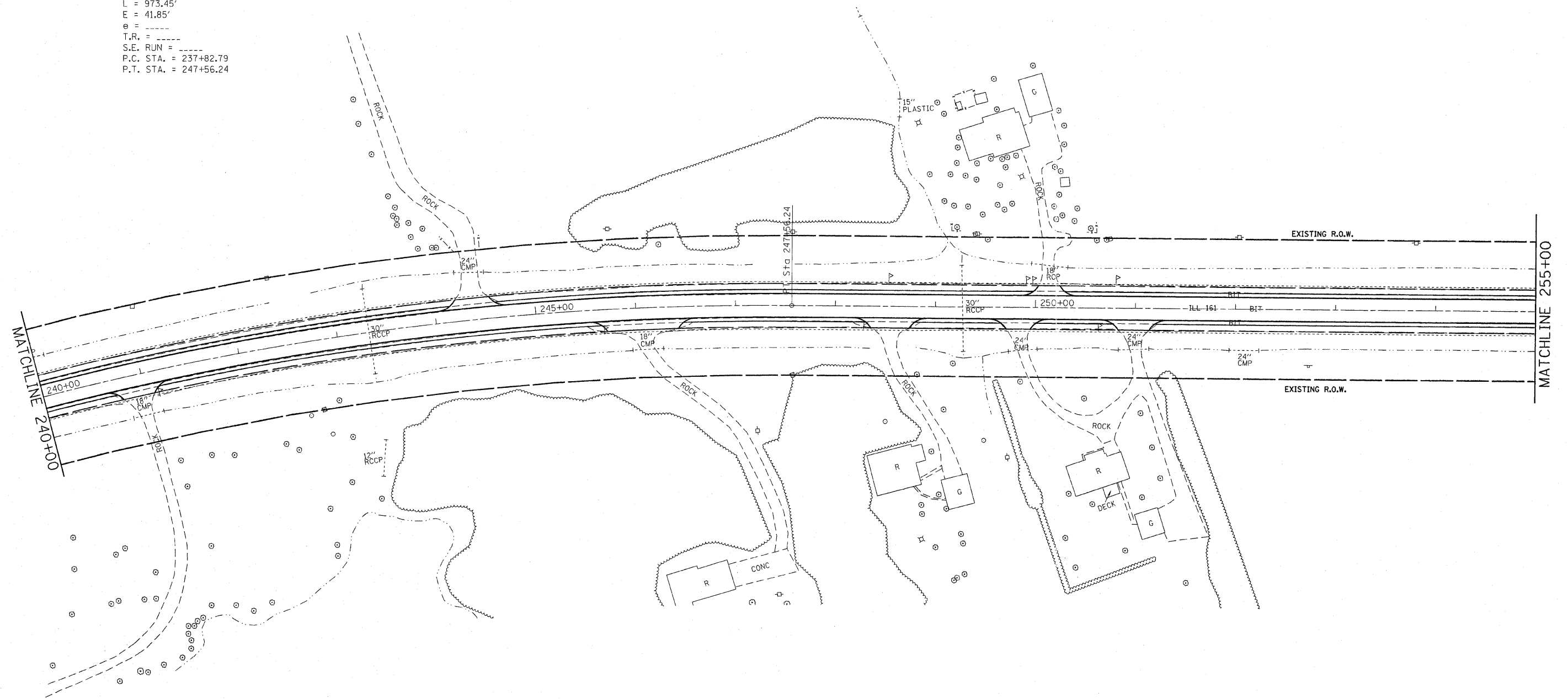

FILE NAME = #FILE#	USER NAME = #USER#	DESIGNED - ---	REVISED - ---
		DRAWN - ---	REVISED - ---
	PLOT SCALE = #SCALE#	CHECKED - ---	REVISED - ---
	PLOT DATE = #DATE#	DATE - ---	REVISED - ---

STATE OF ILLINOIS
DEPARTMENT OF TRANSPORTATION

PLAN VIEW

SCALE: ----- SHEET NO. 5 OF 21 SHEETS STA. 240±00 TO STA. 255±00

F.A.P. RTE.	SECTION	COUNTY	TOTAL SHEETS	SHEET NO.
805	(101,102,61-1-1)RS	MARION	81	14
FED. ROAD DIST. NO. - [ILLINOIS] FED. AID PROJECT				CONTRACT NO. 76833