

STATE OF ILLINOIS  
DEPARTMENT OF TRANSPORTATION

ROUTE NO.	SECTION	COUNTY	SHEETS	SHEET	SHEET NO.
FA 776	#	SALINE	14	7	3 SHEETS
FED. ROAD DIST. NO. 7	ILLINOIS	FED. AID PROJECT			

Contract Number: 78035  
\* (1051-1, 121-1, 1241-1)

**GENERAL NOTES**

The contractor is advised that the existing PPC Deck Beams are in a deteriorated condition with reduced load carrying capacity. It is the contractor's responsibility to account for the condition of the beams when developing construction procedures.

If the contractor's procedure for existing beam removal or placement of new beams involves placement of cranes or other heavy equipment on the bridge, a detailed procedure shall be submitted to the Engineer for approval. The procedure shall include calculations, prepared and sealed by an Illinois Licensed Structural Engineer, verifying that the equipment and procedure used will not overstress the new or existing beams. To distribute load to multiple beams and protect the existing surface, in all cases a double layer mat of heavy timbers shall be used at all times under crane tracks or wheels and any outriggers in the down position. If necessary, shims shall be used under the crane mat to ensure uniform contact with the underlying beams. If heavy equipment will be placed on new PPC deck beams, the following shall be done prior to placement of the timber mats: placement and tightening of transverse tie assemblies, grouting and curing the dowel rods 24 hours minimum and grouting and curing the shear keys.

The top surface of the beams shall be finished according to the IDOT Manual for Fabrication of Precast Prestressed Concrete Products.

Plan dimensions and details relative to existing plans are subject to routine variations. The Contractor shall field verify existing dimensions and details affecting new construction and make necessary approved adjustments prior to construction or ordering of materials. Such variations shall not be cause for additional compensation for a change in scope of the work, however, the Contractor will be paid for the quantity actually furnished based upon the unit price bid for the work.

Temporary concrete barrier shall only be anchored into the overlay and not into the PPC Deck Beams.

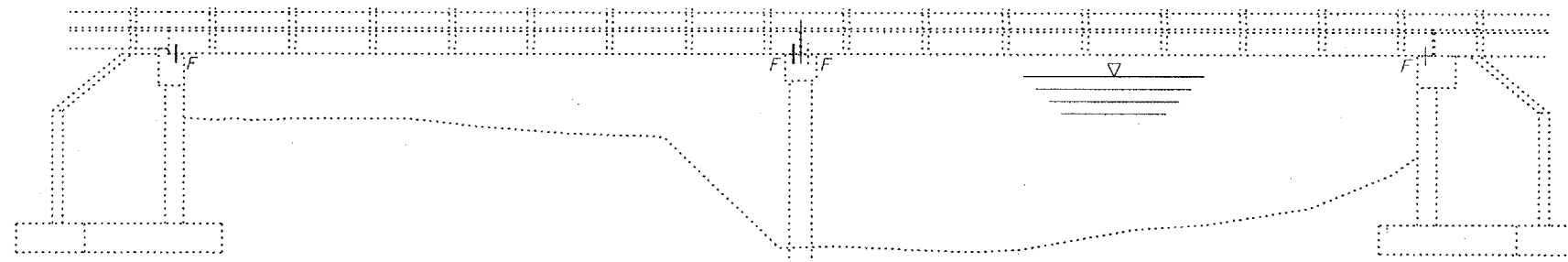

**ELEVATION**

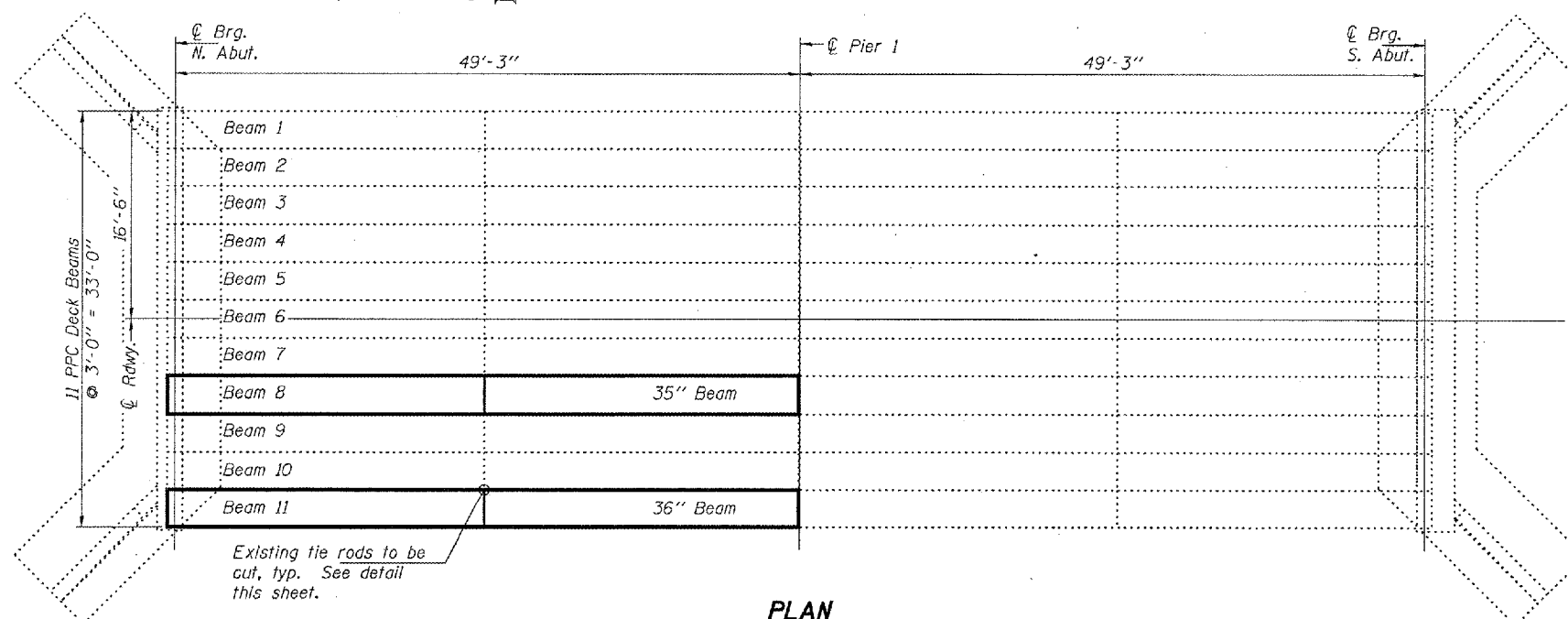

**PLAN**

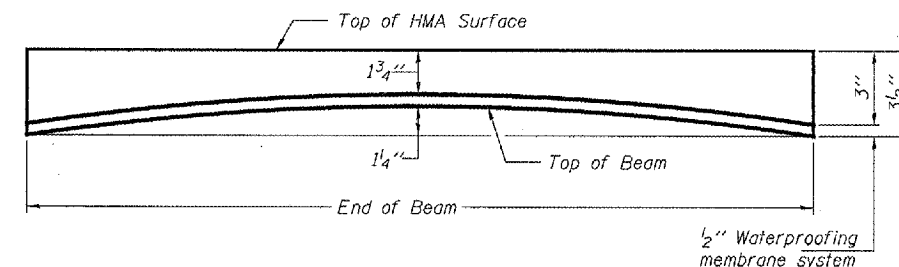

**ANTICIPATED INITIAL CAMBER DIAGRAM**

**DESIGN STRESSES**

**PRECAST PRESTRESSED UNITS**

$f'_c = 5,000$  psi

$f'_{ci} = 4,000$  psi

$f'_s = 270,000$  psi ( $\frac{1}{2}$ "  $\phi$  low lax strands)

$f'_{si} = 201,960$  psi ( $\frac{1}{2}$ "  $\phi$  low lax strands)

DESIGNED	<i>[Signature]</i>
CHECKED	<i>[Signature]</i>
DRAWN	baliva
CHECKED	AJB UHU

EXAMINED	<i>[Signature]</i>	JANUARY 3, 2008
PASSED	<i>[Signature]</i>	

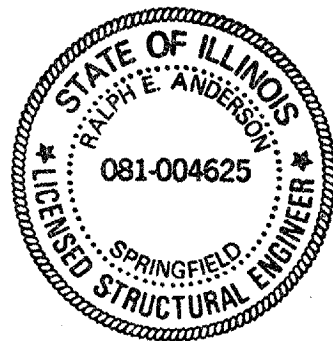

Expires: November 30, 2008

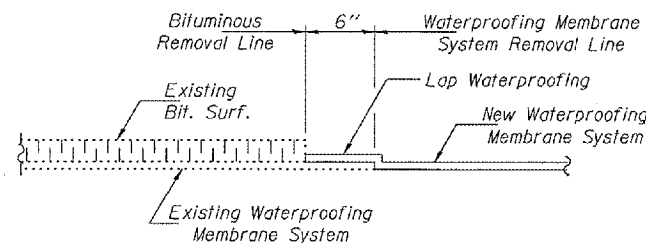

**WATERPROOFING TREATMENT**

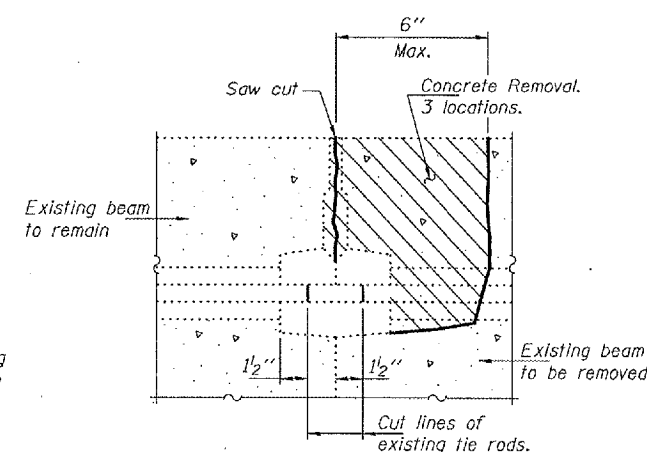

**BEAM REMOVAL DETAIL AT TRANSVERSE TIES**

**TOTAL BILL OF MATERIAL**

ITEM	UNIT	QUANTITY
Removal of Existing PPC Deck Beams	Sq. Ft.	299
Precast Prestressed Concrete Deck Beams (21" Depth)	Sq. Ft.	295
HMA Surface Removal	Sq. Yd.	9.1
HMA Surface Course Mix "C" N90	Tons	5.7
PC Mortar Fairing Course	Foot	150
Asbestos Bearing Pad Removal	Each	4
Waterproofing Membrane System	Sq. Yd.	42.3
Remove and Re-Erect Existing Bridge Rail	Foot	50

**PLAN AND ELEVATION  
FA 776 OVER RECTOR CREEK  
SALINE COUNTY  
SN 083-0031**