

SMITH ENGINEERING CONSULTANTS, INC.
 CIVIL/STRUCTURAL ENGINEERS AND SURVEYORS
 4500 PROMENADE PARKWAY, SUITE 201
 McHENRY, ILLINOIS 60050
 TEL: 815-383-1776 FAX: 815-383-1781
 www.smithengineering.com E-MAIL: sec@smithengineering.com
 McHENRY HUNTLEY YORKVILLE
 ILLINOIS PROFESSIONAL DESIGN FIRM # 184-000108

INDEX OF SHEETS

- 1 COVER SHEET
- 2 INDEX OF SHEETS, LIST OF STATE STANDARDS, & GENERAL NOTES
- 3 SUMMARY OF QUANTITIES
- 4 TYPICAL SECTIONS
- 5 ALIGNMENT, TIES, AND BENCHMARKS
- 6-17 ROADWAY PLAN AND PROFILE
- 18-19 MAINTENANCE OF TRAFFIC PLANS AND DETAILS
- 20-22 EROSION CONTROL PLAN
- 23-28 PAVEMENT MARKING, SIGNING, AND LANDSCAPING PLAN
- 29-32 TRAFFIC SIGNAL PLANS AND DETAILS
- 33 STANDARD CONSTRUCTION DETAILS
- 34-36 PEDESTRIAN STRUCTURE PLANS
- 37 DISTRICT ONE TYPICAL PAVEMENT MARKINGS
- 38-42 CROSS SECTIONS

SCALES
 PLAN: 1" = 20'
 PROFILE HORIZ.: 1" = 20'
 PROFILE VERT.: 1" = 5'
 CROSS SECTIONS HORIZ.: 1" = 10'
 CROSS SECTIONS VERT.: 1" = 5'

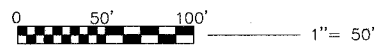
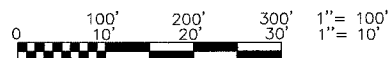

FULL SIZE PLANS HAVE BEEN PREPARED USING STANDARD ENGINEERING SCALES, REDUCED SIZED PLANS WILL NOT CONFORM TO STANDARD SCALES, IN MAKING MEASUREMENTS ON REDUCED PLANS, THE ABOVE SCALES MAY BE USED.

PROJECT LOCATED IN
 VILLAGE OF MUNDELEIN,
 LAKE COUNTY, IL

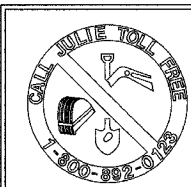

CALL JULIE 1-800-892-0123

WITH THE FOLLOWING:
 COUNTY LAKE
 CITY-TOWNSHIP VILLAGE OF MUNDELEIN
 SEC. & 1/4 SEC. NO.# 14, 15, 43 & 7
 48 hours before you dig
 (Excluding Sat., Sun. & Holidays)

CONTRACT NO. 83890

STATE OF ILLINOIS
 DEPARTMENT OF TRANSPORTATION
 DIVISION OF HIGHWAYS

PLANS FOR PROPOSED
 FEDERAL AID HIGHWAY

CMAQ/SEAVEY BIKE PATH
 RESURFACING AND BIKE PATH CONSTRUCTION
 LIMITS: WASHINGTON BOULEVARD TO THOMAS BOULEVARD
 SECTION NO. 04-00075-00-BT
 PROJECT NO. CMM-8003 (390)
 LAKE COUNTY
 C-91-154-04

F.A.U. RTE.	SECTION	COUNTY	TOTAL SHEETS	SHEET NO.
	04-00075-00-BT	LAKE	42	1
PROJECT NO. M-8003 (390)				
FED. ROAD DIST. NO. 1 ILLINOIS HIGHWAY PROJECT 1				
Contract No: 83890				

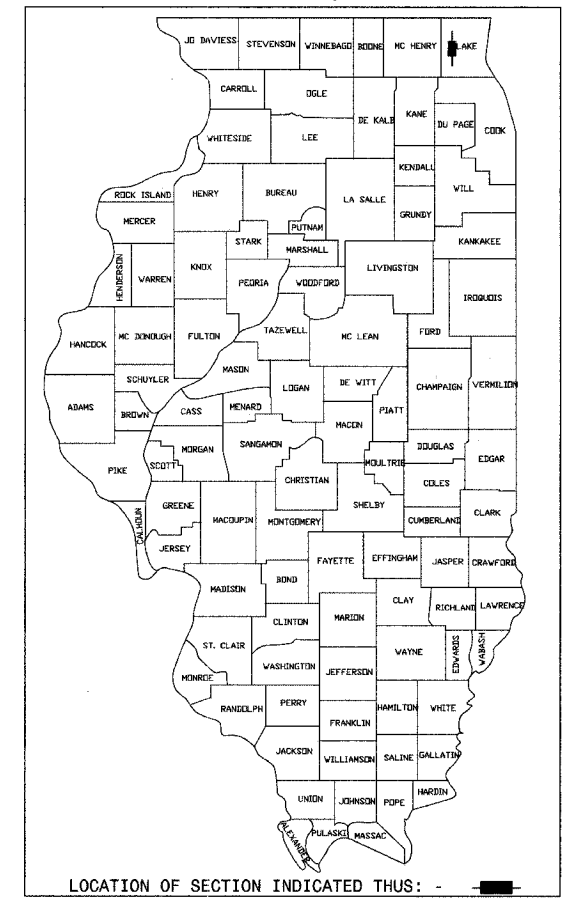

VILLAGE OF MUNDELEIN

APPROVED 11/23 2006
Wal. Cum...
 VILLAGE ENGINEER

PASSED February 22, 2007
CH...
 DISTRICT 1 ENGINEER OF LOCAL ROADS AND STREETS

RELEASING FOR BID BASED ON LIMITED REVIEW February 22, 2007
Diane O. Keefe...
 DEPUTY DIRECTOR OF HIGHWAYS, REGION 1 ENGINEER

PRINTED BY AUTHORITY OF THE
 STATE OF ILLINOIS

PROFESSIONAL ENGINEER'S SIGN & SEAL

Jeff L. Pisha
 JEFF L. PISHA P.E.
 11/30/06
 DATE: 11/30/09
 LICENSE EXPIRES:

STRUCTURAL ENGINEER'S SIGN & SEAL

Robert G. Davies
 ROBERT G DAVIES, S.E., P.E.
 11/30/06
 DATE: 11/30/08
 LICENSE EXPIRES:

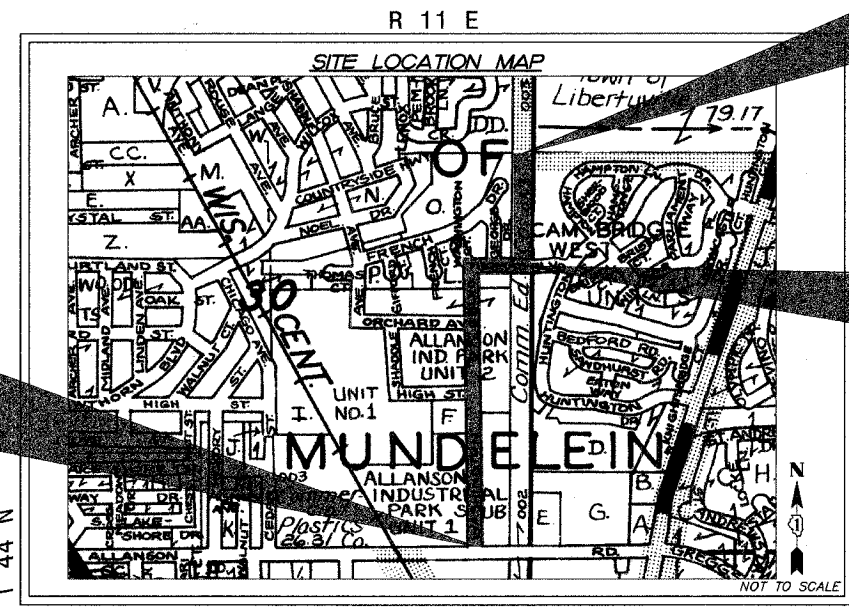

GROSS LENGTH OF PROJECT = 4,936 FEET (0.94 MILES)
 NET LENGTH OF PROJECT = 4,936 FEET (0.94 MILES)

SPEED LIMIT
 WASHINGTON BOULEVARD: 30 MPH
 THOMAS BOULEVARD: 25 MPH

DESIGN SPEED
 WASHINGTON BOULEVARD: 35 MPH
 THOMAS BOULEVARD: 30 MPH

TRAFFIC DATA
 WASHINGTON BOULEVARD: 7,420 (2004)
 THOMAS BOULEVARD: 2,030 (2004)

FEDERAL AID DESIGN ENGINEER: KEVIN STALLWORTH(847) 705-4169