

F.A.P. R.T.E.	SECTION	COUNTY	TOTAL SHEETS	SHEET NO.
336	04-00075-00-BT	LAKE	42	18
STA.	10+00	TO STA.	22+50	
FED. ROAD DIST. NO. 1		ILLINOIS		HIGHWAY PROJECT
CONTRACT NO. 83890				

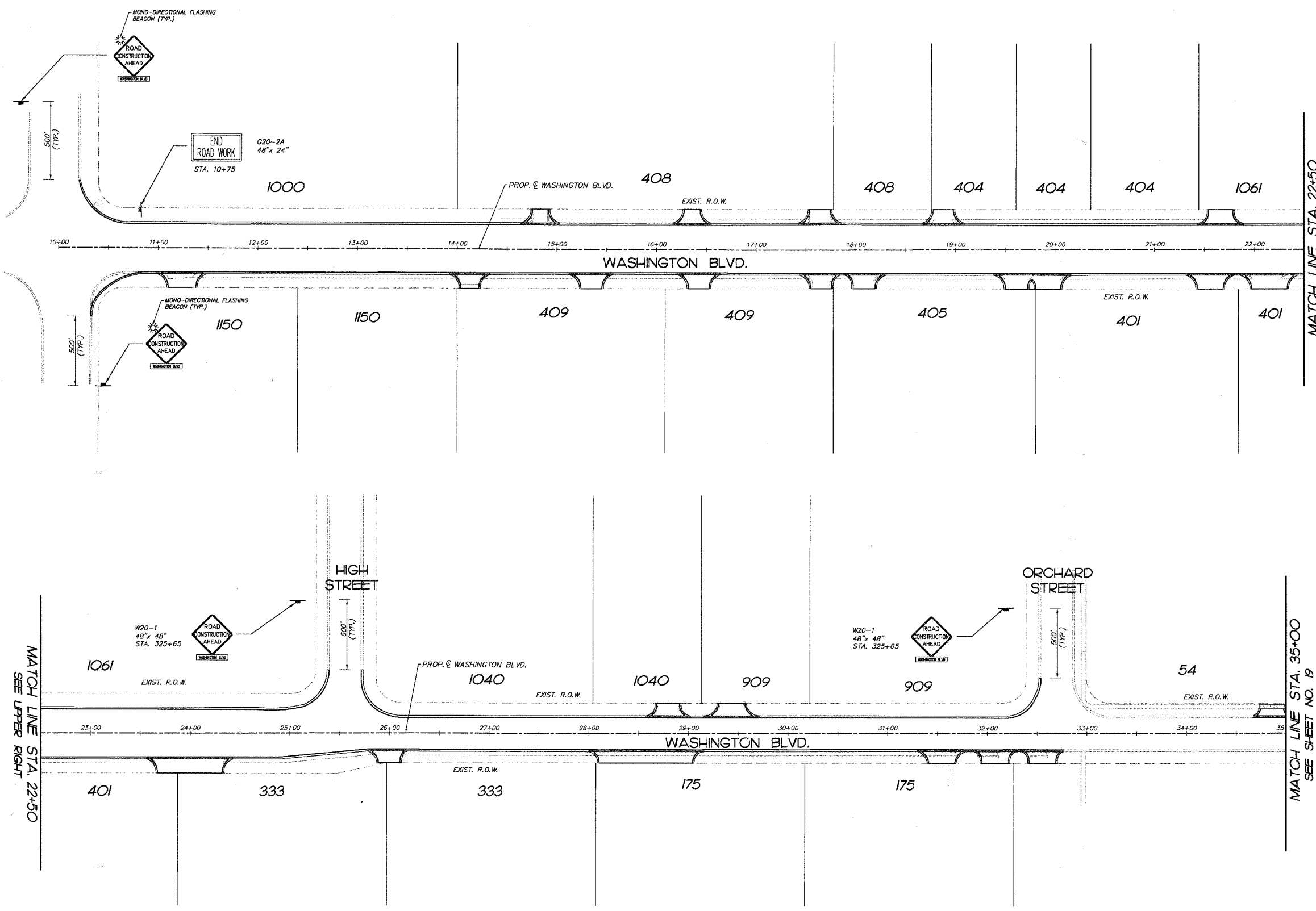

- SUGGESTED MAINTENANCE OF TRAFFIC GENERAL NOTES:**
1. TRAFFIC SHALL BE MAINTAINED PER STANDARD 701301-02.
 2. THE CONTRACTOR SHALL PROVIDE ACCESS TO ADJACENT PROPERTY AT ALL TIMES DURING THE CONSTRUCTION OF THIS PROJECT.
 3. ALL TEMPORARY CONSTRUCTION SIGNS SHALL HAVE FLOURESCENT ORANGE BACKGROUND.
 4. TEMPORARY SIGNING, AS SHOWN, SHALL CONFORM TO ALL APPLICABLE STANDARDS INCLUDED ON THE SPECIAL PROVISIONS AND CONTRACT PLANS OR AS DIRECTED BY THE ENGINEER. ALL COSTS ASSOCIATED WITH TRAFFIC CONTROL SHALL BE INCLUDED IN THE ITEM "TRAFFIC CONTROL AND PROTECTION, 701501" and "TRAFFIC CONTROL AND PROTECTION, 701502".
 5. THE SIZES OF ALL SIGNS NOT SPECIFIED IN THESE PLANS SHALL BE AS REQUIRED BY THE STATE OF ILLINOIS MANUAL ON UNIFORM TRAFFIC CONTROL DEVICES.
 6. THE CONTRACTOR SHALL PROVIDE THE ENGINEER WITH THE NAMES AND PHONE NUMBERS OF HIS REPRESENTATIVES ON THE CONSTRUCTION SITE (INCLUDING A 24-HOUR EMERGENCY NUMBER) AND HIS REPRESENTATIVES SHALL BE RESPONSIBLE FOR THE SIGNING PRIOR TO THE START OF WORK.
 7. THE CONTRACTOR SHALL BE RESPONSIBLE FOR THE FIELD LOCATION OF ALL CONSTRUCTION SIGNING. THE CONTRACTOR MAY REQUEST THE ENGINEER TO FIELD VERIFY THE POSITIONS OF ANY SIGN.
 8. THE CONTRACTOR SHALL BE RESPONSIBLE FOR ENSURING THAT ALL BARRICADES, SIGNS, LIGHTS, AND OTHER DEVICES INSTALLED ARE IN PLACE AND OPERATING 24-HOURS EACH DAY, INCLUDING SUNDAYS AND HOLIDAYS.
 9. ALL TYPE III BARRICADES SHALL HAVE TWO AMBER TYPE A-LOW INTENSITY FLASHING LIGHTS SPACED NEAR THE CENTERLINE SUPPORTS.
 10. THE CONTRACTOR SHALL BE RESPONSIBLE FOR MAINTAINING THE VISIBILITY OF ALL CONSTRUCTION SIGNS, INCLUDING BRUSHING BACK VEGETATION, IF DEEMED NECESSARY BY THE ENGINEER.
 11. EXISTING TRAFFIC CONTROL DEVICES WITHIN THE LIMITS OF CONSTRUCTION ARE TO BE PROTECTED FROM DAMAGE BY THE CONTRACTOR. ANY DAMAGED TRAFFIC CONTROL DEVICES CAUSED BY HIS/HER WORK SHALL BE REPLACED BY THE CONTRACTOR AT NO ADDITIONAL COST TO THE CONTRACT.
 12. REQUIRED TRAFFIC CONTROL DEVICES SHALL BE IN PLACE PRIOR TO THE START OF CONSTRUCTION.
 13. TYPE II BARRICADES WITH STEADY BURN MONODIRECTIONAL LAMPS SHALL BE PLACED ALONG ALL CURB AND CUTTER THAT IS BEING REMOVED AND REPLACED.
 14. A CRANE MAY NOT BE PERMITTED WITHIN THE COMED EASEMENT FOR THE INSTALLATION OF PEDESTRIAN BRIDGE DUE TO OVERHEAD HIGH TENSION WIRES. ALTERNATIVE MEANS OF INSTALLATION OF THE PEDESTRIAN BRIDGE MAY NEED TO BE CONSIDERED.
 15. THE CONTRACTOR MUST COORDINATE WITH COMED PRIOR TO START OF CONSTRUCTION.
 16. THE PEDESTRIAN BRIDGE SHALL BE DELIVERED TO THE INSTALLATION LOCATION UTILIZING THE PREPARED OFF-STREET BIKE PATH EASEMENT PRIOR TO CONSTRUCTION OF THE BIKE PATH.

REVISIONS	
NO.	DATE
7.	
6.	
5.	
4.	
3.	
2.	
1.	BDH 12-28-07

SMITH ENGINEERING CONSULTANTS, INC.
 CIVIL/STRUCTURAL ENGINEERS AND SURVEYORS
 4500 PRIME PARKWAY, SUITE 201
 MARIETTA, ILLINOIS 60090
 TEL: 815-385-1778 FAX: 815-385-1781
 www.smithengineering.com E-MAIL: sec@smithengineering.com
 • MARIETTA • BUNTLEY • YORKVILLE
 ILLINOIS PROFESSIONAL DESIGN FIRM # 184-000108

ILLINOIS DEPARTMENT OF TRANSPORTATION
 VILLAGE OF MUNDELEIN
 CMAQ/SEAVEY BIKE PATH
 SUGGESTED MAINTENANCE OF TRAFFIC PLAN
 STA. 10+00 TO STA. 35+00
 SCALE: 1" = 50'
 DATE 11-15-06
 DRAWN BY BDH
 CHECKED BY GFR

PLOT FILE: STANDARD
 VIEW: 18
 COMP: FILE: 050406-627.dwg