

F.A.P. RTE.	SECTION	COUNTY	TOTAL SHEETS	SHEET NO.
336	04-00075-00-BT	LAKE	42	26
STA.	TO STA.			
FED. ROAD DIST. NO. 1	ILLINOIS HIGHWAY PROJECT			
CONTRACT NO. 83890				

GEORGE DRIVE

SEE LOWER LEFT
MATCH LINE STA. 101+00

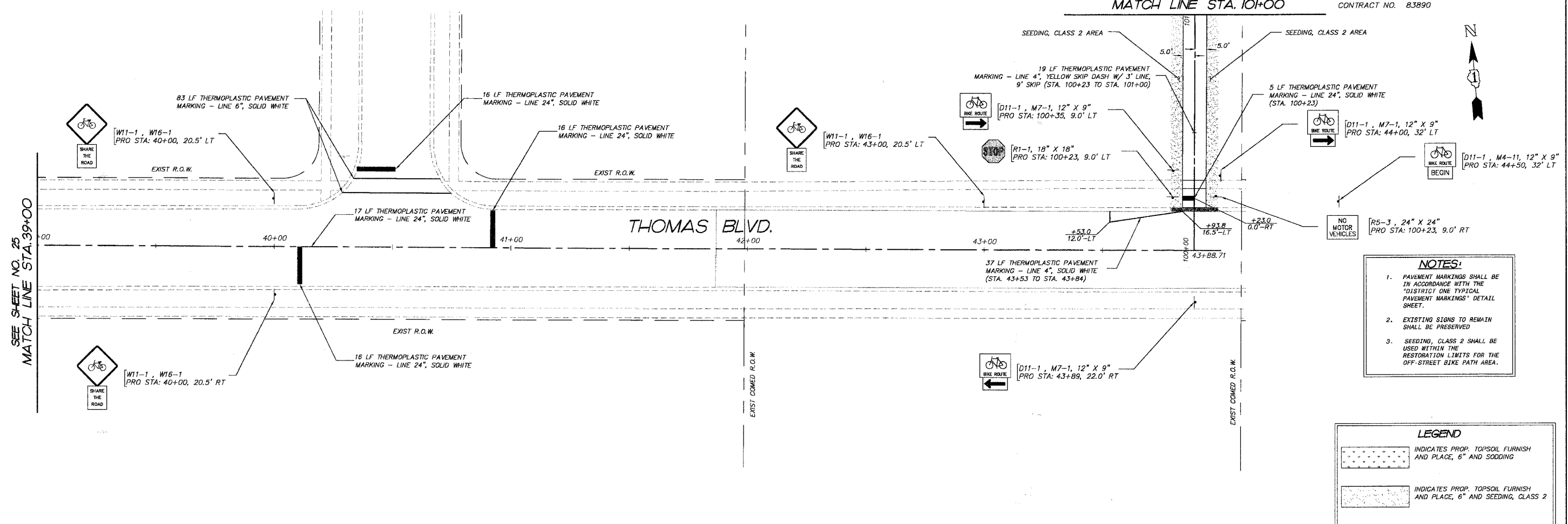

- NOTES:**
- PAVEMENT MARKINGS SHALL BE IN ACCORDANCE WITH THE "DISTRICT ONE TYPICAL PAVEMENT MARKINGS" DETAIL SHEET.
 - EXISTING SIGNS TO REMAIN SHALL BE PRESERVED.
 - SEEDING, CLASS 2 SHALL BE USED WITHIN THE RESTORATION LIMITS FOR THE OFF-STREET BIKE PATH AREA.

LEGEND

	INDICATES PROP. TOPSOIL FURNISH AND PLACE, 6" AND SODDING
	INDICATES PROP. TOPSOIL FURNISH AND PLACE, 6" AND SEEDING, CLASS 2

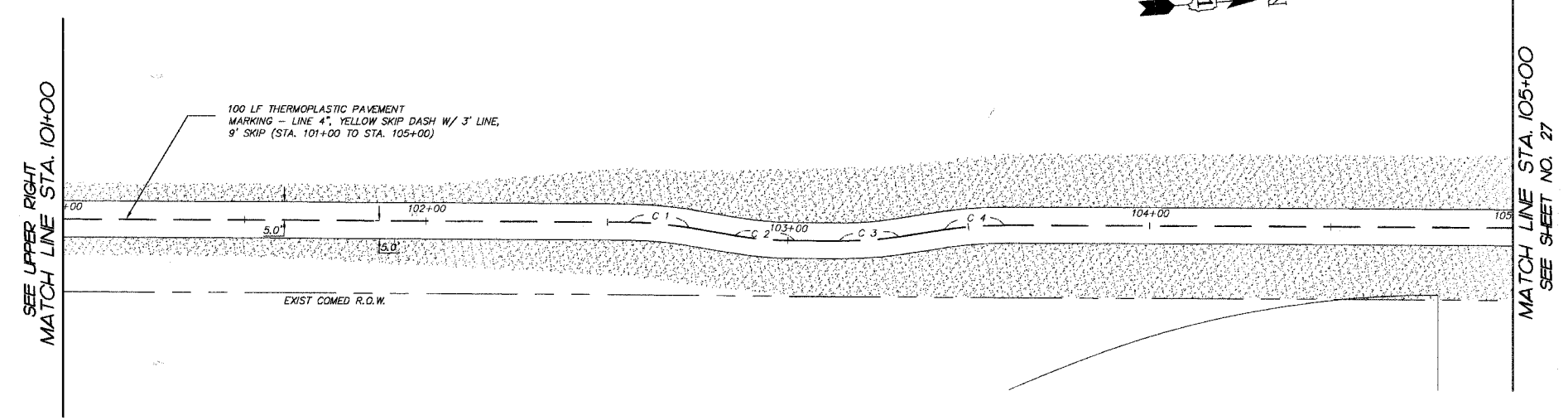

SEE UPPER RIGHT
MATCH LINE STA. 101+00

MATCH LINE STA. 105+00
SEE SHEET NO. 27

REVISIONS

NO.	NAME	DATE
7.		
6.		
5.		
4.		
3.		
2.		
1.	BDH	12-28-07

SMITH ENGINEERING CONSULTANTS, INC.
 CIVIL/STRUCTURAL ENGINEERS AND SURVEYORS
 4000 PRIME PARKWAY, SUITE 200
 METZENRY, ILLINOIS 60050
 PH: 615-385-1776 FAX: 615-385-1781
 www.smithengineering.com E-MAIL: sec@smithengineering.com
 HUNTERVILLE HUNTERVILLE YORKVILLE
 ILLINOIS PROFESSIONAL DESIGN FIRM # 184-000108

ILLINOIS DEPARTMENT OF TRANSPORTATION
 VILLAGE OF MUNDELEIN
 CMAQ/SEAVEY BIKE PATH
 SIGNING, STRIPING, AND
 RESTORATION PLAN
 STA. 39+00 TO STA. 43+88.71 &
 STA. 100+00 TO STA. 105+00
 SCALE: 1" = 20'
 DATE 11-15-06
 DRAWN BY CFR
 CHECKED BY GFR

PLOT FILE: STANDARD
 C:\PLOT FILES\050460-605.DWG