

**BENCHMARK:**

SET CHISELED SQUARE ON THE EAST HEADWALL OF THE CULVERT UNDER SHADDE AVENUE AND THE SEAVEY DRAINAGE DITCH. ELEVATION = 717.06 (NGVD29)

F.A.P. RTE.	SECTION	COUNTY	TOTAL SHEETS	SHEET NO.
336	04-00075-00-BT	LAKE	42	34
STA.		TO STA.		
FED. ROAD DIST. NO. 1		ILLINOIS HIGHWAY PROJECT		
CONTRACT NO. 83890				

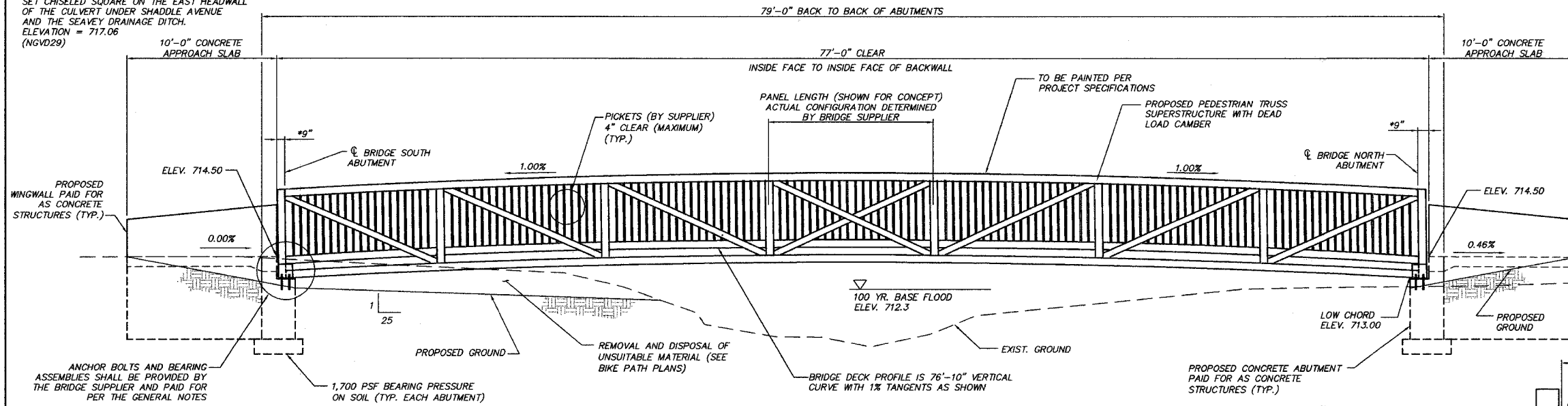

**ELEVATION**

\* BRIDGE SUPPLIER TO VERIFY DIMENSION(S)

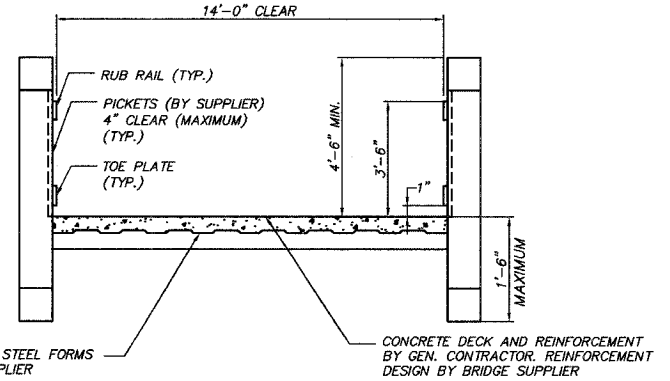
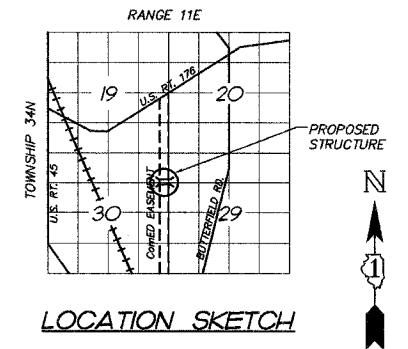

**BRIDGE CROSS SECTION**  
(NOT TO SCALE)

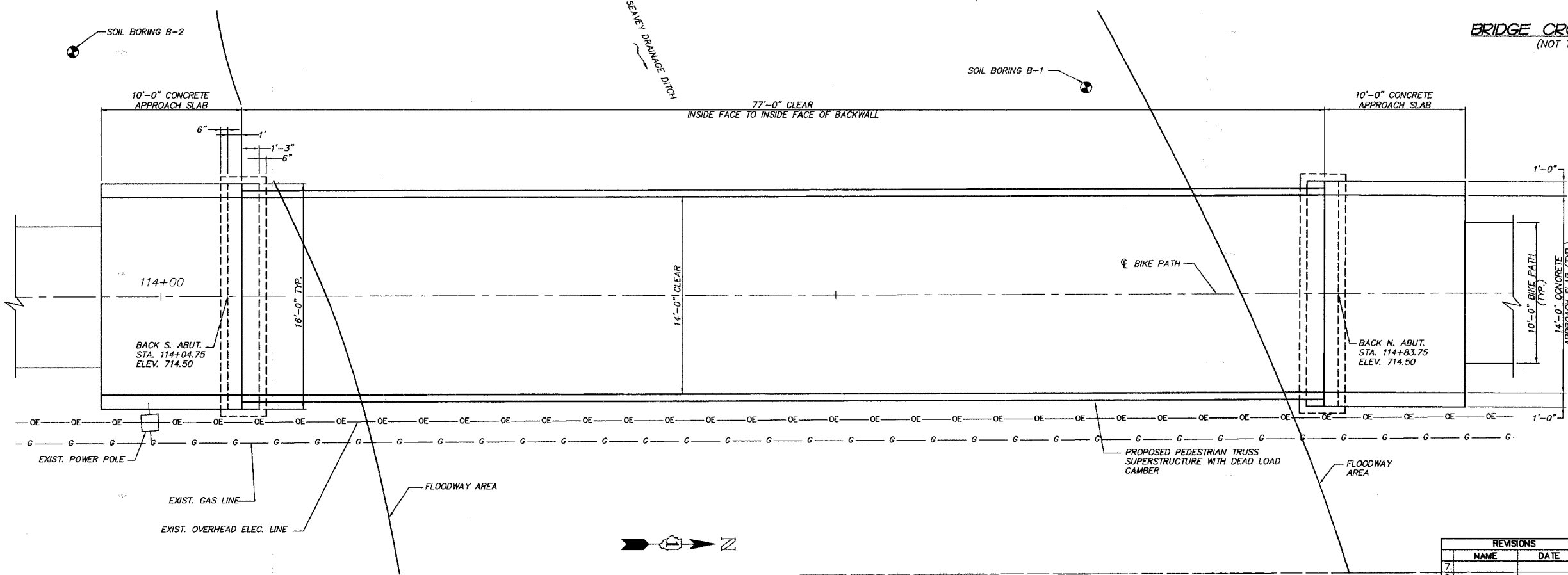

**PLAN**

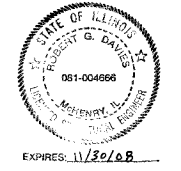

I CERTIFY THAT TO THE BEST OF KNOWLEDGE, INFORMATION AND BELIEF, THIS BRIDGE SUBSTRUCTURE DESIGN IS STRUCTURALLY ADEQUATE FOR THE DESIGN LOADING SHOWN ON THE PLANS. THE DESIGN IS AN ECONOMICAL ONE FOR THE STYLE OF STRUCTURE AND COMPLIES WITH REQUIREMENTS OF THE CURRENT AASHTO STANDARD SPECIFICATION FOR HIGHWAY BRIDGES.

*Matthew S. Davis*  
STRUCTURAL ENGINEER

**SMITH ENGINEERING CONSULTANTS, INC.**  
CIVIL/STRUCTURAL ENGINEERS AND SURVEYORS  
4650 PRIME PARKWAY, SUITE 201  
MORNING HAVEN, ILLINOIS 60050  
PH: 815-395-1774 FAX: 815-395-1781  
www.smithengineering.com E-MAIL: soc@smithengineering.com  
#MORNING HAVEN #MUNDELEIN #YORKVILLE  
ILLINOIS PROFESSIONAL DESIGN FIRM # 104-000108

ILLINOIS DEPARTMENT OF TRANSPORTATION

VILLAGE OF MUNDELEIN  
CMAQ/SEAVEY BIKE PATH  
PEDESTRIAN BRIDGE  
PLAN AND ELEVATION

SCALE: "NTS" DRAWN BY CFR  
DATE 11-15-06 CHECKED BY RGD

REVISIONS	
NO.	DATE
7.	
6.	
5.	
4.	
3.	
2.	
1.	

PLANT FILE STANDARD  
CONTR. FILE: 080460-632.dwg