

F.A.U. RTE.	SECTION	COUNTY	TOTAL SHEETS	SHEET NO.
363	06-00339-00-TL	KANE	33	15
STA.		TO STA.		
FED. ROAD DIST. NO. 7		ILLINOIS FED. AID PROJECT		

TRAFFIC SIGNAL LEGEND

	EXISTING	PROPOSED		EXISTING	PROPOSED
CONTROLLER			EMERGENCY VEHICLE SYSTEM DETECTOR		
SERVICE INSTALLATION			CONFIRMATION BEACON		
SIGNAL HEAD			SIGNAL HEAD PROGRAMMED		
SIGNAL HEAD WITH BACKPLATE			CONDUIT SPLICE		
SIGNAL HEAD, PEDESTRIAN			WOOD POLE		
SIGNAL POST			RACEWAY FOR MAGNETIC DETECTOR, TYPE I OR TYPE II		
MAST ARM ASSEMBLY AND POLE, STEEL			VEHICLE DETECTOR, NON COMPENSATED MAGNETIC TYPE		
MAST ARM ASSEMBLY AND POLE, ALUMINUM			RAILROAD CONTROLLER		
COMBINATION MAST ARM ASSEMBLY AND POLE, STEEL			ILLUMINATED SIGN, FIBER OPTIC "NO LEFT TURN"		
COMMON TRENCH			ILLUMINATED SIGN, FIBER OPTIC "NO RIGHT TURN"		
UNIT DUCT			TELEPHONE CONNECTION		
HANDHOLE			UNINTERRUPTIBLE POWER SUPPLY		
HEAVY-DUTY HANDHOLE			VIDEO DETECTION CAMERA		
DOUBLE HANDHOLE			PTZ CAMERA		
G.S. CONDUIT IN TRENCH OR PUSHED			EXISTING EQUIPMENT TO BE RELOCATED		
PEDESTRIAN PUSH-BUTTON DETECTOR					
DETECTOR LOOP					
CAST IRON JUNCTION BOX					

KANE COUNTY SHERIFF'S OFFICE

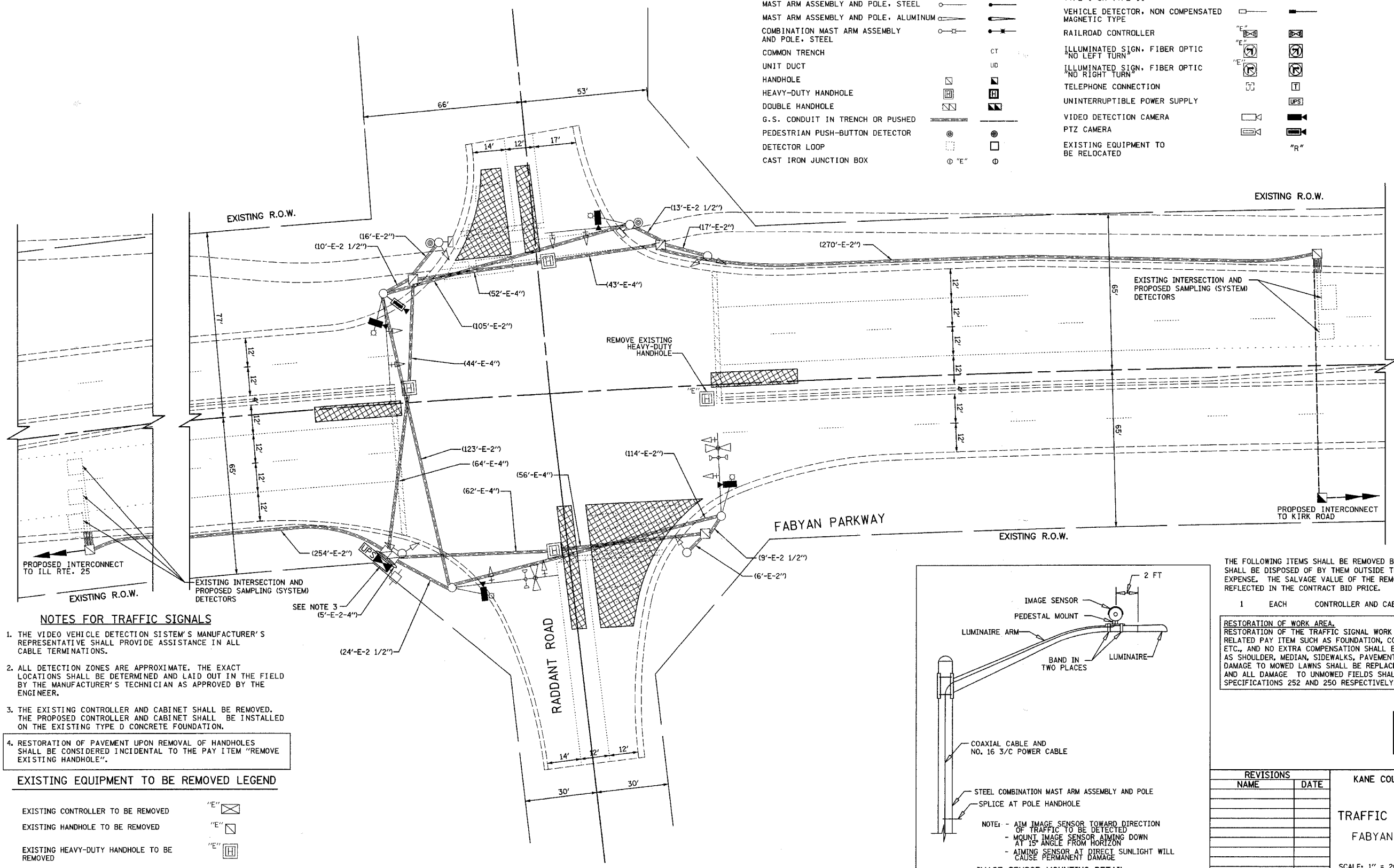

- NOTES FOR TRAFFIC SIGNALS**
1. THE VIDEO VEHICLE DETECTION SYSTEM'S MANUFACTURER'S REPRESENTATIVE SHALL PROVIDE ASSISTANCE IN ALL CABLE TERMINATIONS.
 2. ALL DETECTION ZONES ARE APPROXIMATE. THE EXACT LOCATIONS SHALL BE DETERMINED AND LAID OUT IN THE FIELD BY THE MANUFACTURER'S TECHNICIAN AS APPROVED BY THE ENGINEER.
 3. THE EXISTING CONTROLLER AND CABINET SHALL BE REMOVED. THE PROPOSED CONTROLLER AND CABINET SHALL BE INSTALLED ON THE EXISTING TYPE D CONCRETE FOUNDATION.
 4. RESTORATION OF PAVEMENT UPON REMOVAL OF HANDHOLES SHALL BE CONSIDERED INCIDENTAL TO THE PAY ITEM "REMOVE EXISTING HANDHOLE".

EXISTING EQUIPMENT TO BE REMOVED LEGEND

EXISTING CONTROLLER TO BE REMOVED	
EXISTING HANDHOLE TO BE REMOVED	
EXISTING HEAVY-DUTY HANDHOLE TO BE REMOVED	

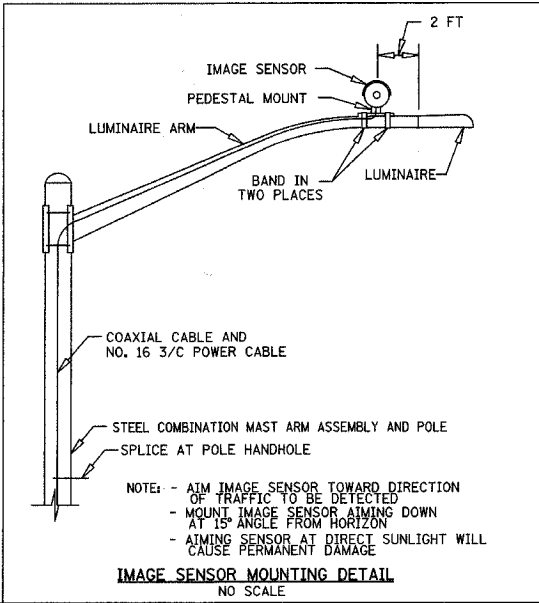

THE FOLLOWING ITEMS SHALL BE REMOVED BY THE CONTRACTOR AND SHALL BE DISPOSED OF BY THEM OUTSIDE THE RIGHT-OF-WAY AT THEIR EXPENSE. THE SALVAGE VALUE OF THE REMOVED EQUIPMENT SHALL BE REFLECTED IN THE CONTRACT BID PRICE.

- 1 EACH CONTROLLER AND CABINET, COMPLETE

RESTORATION OF WORK AREA.
 RESTORATION OF THE TRAFFIC SIGNAL WORK AREA SHALL BE INCIDENTAL TO THE RELATED PAY ITEM SUCH AS FOUNDATION, CONDUIT, HANDHOLE, TRENCH AND BACKFILL, ETC., AND NO EXTRA COMPENSATION SHALL BE ALLOWED. ALL ROADWAY SURFACES SUCH AS SHOULDER, MEDIAN, SIDEWALKS, PAVEMENT, ETC. SHALL BE REPLACED IN KIND. ALL DAMAGE TO MOWED LAWNS SHALL BE REPLACED WITH AN APPROVED SALT TOLERANT SOD, AND ALL DAMAGE TO UNMOWED FIELDS SHALL BE SEEDED IN ACCORDANCE WITH STANDARD SPECIFICATIONS 252 AND 250 RESPECTIVELY.

NOTE:
 THE TRAFFIC SIGNAL CONTROLLER EQUIPMENT FOR THIS PROJECT SHALL BE "EAGLE" TO MATCH THE EXISTING ADJACENT SYSTEM.

REVISIONS		NAME	DATE
NO.	DESCRIPTION		

KANE COUNTY DIVISION OF TRANSPORTATION

TRAFFIC SIGNAL MODIFICATION PLAN

FABYAN PARKWAY & RADDANT ROAD

SCALE: 1" = 20'

DATE: 12/14/2007

DRAWN BY: CEC
 DESIGNED BY: BRD/JSH
 CHECKED BY: JJE